

# EAO – Your Expert Partner for Human Machine Interfaces

## 704.062.518 - Illuminated pushbutton round - Actuator

### 704.062.518 - Illuminated pushbutton round - Actuator



*Attention: The preview is based on a sample product. This can differ from your current configuration.*

#### Attribute

Design	flush
Front dimension	Ø 35 mm
Front form	square
IP front protection	IP65
Mounting cut-out	Ø 30.5 mm
Front bezel colour	Nature
Front bezel material	Aluminium
Front bezel surface	anodised
Housing colour	Grey
Housing material	Plastic
Illumination colour	Green
Illuminative colour	Green
Lens colour	Green
Lens illumination	illuminative
Lens material	Plastic
Lens optics	transparent
Lens shape	flush
Switching action	Maintained
Terminal	Screw terminal
Weight	0.067 kg

#### Schaltelement

max. number of switching elements	3
-----------------------------------	---

#### Function

Illuminated pushbutton

# EAO – Your Expert Partner for Human Machine Interfaces

704.062.518 - Illuminated pushbutton round - Actuator

## Dimensions

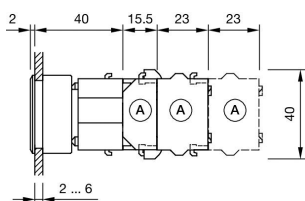

## Mounting cut-outs

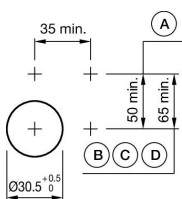

## Wiring diagrams

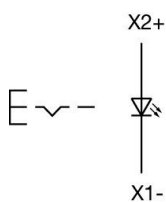

## Additional information

Max. 3 switching elements can be clipped on  
The lamp block will be delivered with screw terminal  
The colour of anodised aluminium parts can vary due to technical production reasons  
Max. 3 switching elements can be clipped on  
The lamp block will be delivered with screw terminal  
The colour of anodised aluminium parts can vary due to technical production reasons