

SERIES 5000 - ROUND PUSHBUTTON SWITCHES

FOR AT LEAST 200 000 MECHANICAL SWITCHING CYCLES





PRODUCT FEATURES

- ◆ Attractive, round pushbutton switch
- ◆ Efficient contact system at least 200 000 mechanical switching cycles
- ◆ Variants with sealing cap for IP 54 dust and water protection
- ◆ Appliance cut-out with diameter 16 mm, alternatively with fixing pin

ON REQUEST

- ◆ Other colors
- ◆ Actuator printing
- ◆ Snap-on for greater wall thickness
- ◆ Cable assembly

Mechanical life endurance	20E4
Proof tracking	250 PTI
Protection type	IP 40 IP 54 (in variants with sealing cap)
Ambient temperature	terminal side -20 °C ... +85 °C actuating side -20 °C ... +55 °C
Flammability	UL 94 V-2
Glow wire test temperature	850 °C
Material	actuator PA glass fiber-reinforced housing PA glass fiber-reinforced terminals silver plated
Plug force of the terminals	≤ 64 N
Approval marks	 /  / 
Suitable for appliances of protection class II	



ROCKER SWITCHES

PUSHBUTTON SWITCHES

TOGGLE SWITCHES

SLIDE SWITCHES

ROTARY SWITCHES

FOOT SWITCHES

FACT AND KEY SWITCHES













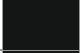



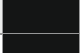

SNAP-ACTION SWITCHES

MICRO-SIGNAL SWITCHES

SENSORS

SERIES 5000 - ROUND PUSHBUTTON SWITCHES

FOR AT LEAST 200 000 MECHANICAL SWITCHING CYCLES

 single-pole	Actuator color / printing	Housing color	4 (2) A 250 V AC 5E4	4 A 125 V AC 1/10 HP	2 A 250 V AC 1/10 HP	Terminal type	Terminal description	Contact distance in mm	Contact material	Pretravel max. in mm	Total travel / stroke in mm	Miscellaneous	Stock version
Normally open contact (SPNO)													
5000.0101			●	●	●		2.8	≈ 3	Ag	2.0 ± 0.4	4.0		●
5000.0103			●	●	●		2.8	≈ 3	Ag	2.0 ± 0.4	4.0		●
5000.0104			●	●	●		2.8	≈ 3	Ag	2.0 ± 0.4	4.0		●
5000.0211			●	●	●		2.8	≈ 3	Ag	2.0 ± 0.4	4.0	fixing pin	●
5000.0212			●	●	●		2.8	≈ 3	Ag	2.0 ± 0.4	4.0	fixing pin	
5000.0501			●	●	●		2.8	≈ 3	Ag	2.0 ± 0.4	4.0	fixing pin with IP 54 sealing cap	



Basic type 5000

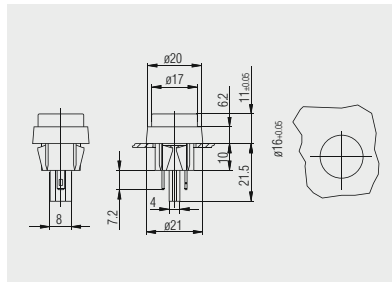

Quick-connect terminal 2.8 x 0.8

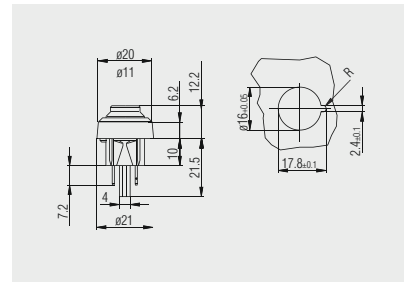

Quick-connect terminal 2.8 x 0.8 (with fixing pin and IP 54 sealing cap) 5000.0501

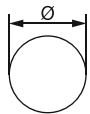

X = wall thickness

X	Ø
1.4 ... 1-7	16.0 +0.05

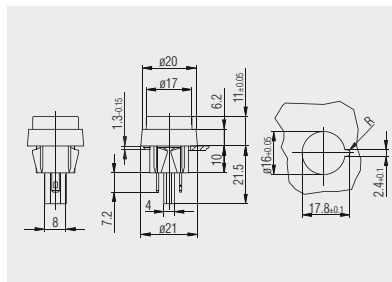

Quick-connect terminal 2.8 x 0.8 (with fixing pin) 5000.0211 and 5000.0212