



# Fused and Switched IEC Inlet Prewired 1.0mm

Order code: **23-3209**



## Specification

### Material:

1. Housing: PC, UL 94V-0
2. Terminal: Copper alloy, tin plated

### Characteristics:

1. Rating: 10A 250V
2. Insulation resistance: 100M $\Omega$  min. at 500V DC
3. Electric strength: AC 2000V for one minute
4. Fuse:  $\varnothing 5 \times 20$ mm

### Equivalent Circuit:

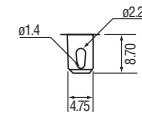
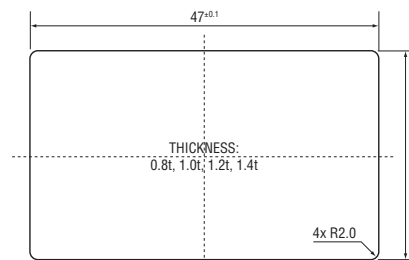
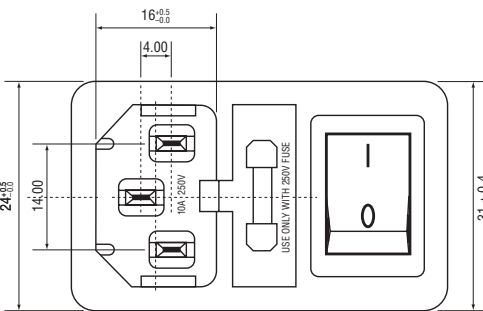
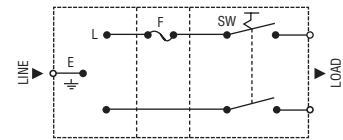

NOTE 1: XX = Panel thickness in 1/10mm, i.e. 0.8, 1.0, 1.2, 1.4

PANEL CUT-OUT

