



Figure similar

COUPLING RELAY IM INDUSTRY-STANDARD
ENCLOSURE 2 CHANGEOVER CONTACTS WIDE
VOLTAGE RANGE 24 V TO 240 V AC/DC SCREW
TERMINALS

General technical data:		
Type of voltage		AC/DC
Supply voltage frequency		
• 1 for auxiliary and control current circuit		
— Rated value	Hz	50
• 2 for auxiliary and control current circuit Rated value	Hz	60
Control supply voltage 1		
• with AC		
— at 50 Hz Initial rated value	V	24
— at 50 Hz Final rated value	V	240
— at 60 Hz Initial rated value	V	24
— at 60 Hz Final rated value	V	240
• for DC		
— Initial rated value	V	24
— Final rated value	V	240
Switching behavior		monostable
Product component Plug-in socket		No
Equipment marking acc. to DIN EN 61346-2		K
Equipment marking acc. to DIN 40719 extended according to IEC 204-2 acc. to IEC 750		K
Mechanical data:		
Type of electrical connection		screw-type terminals
Type of electrical connection Plug-in socket		No
Design of the relay operating mechanism		poled

Design of the switching function positively driven		No
Width	mm	22.5
Height	mm	92
Depth	mm	91



Auxiliary circuit:

Number of NC contacts for auxiliary contacts		0
Number of NO contacts for auxiliary contacts		0
Number of CO contacts for auxiliary contacts		2
Ampacity of the output relay		
• at DC-13		
— at 24 V	A	1
— at 125 V	A	0.2
— at 250 V	A	0.1
• at AC-15 at 250 V at 50/60 Hz	A	3

Ambient conditions:

Protection class IP		IP20
Ambient temperature during operation minimum	°C	-25
Ambient temperature during operation maximum	°C	60

Certificates/ approvals:

General Product Approval	other
 CCC	other Environmental Confirmations Declaration of Conformity
	
 UL	

Further information

Information- and Downloadcenter (Catalogs, Brochures,...)

<http://www.siemens.com/industrial-controls/catalogs>

Industry Mall (Online ordering system)

<http://www.siemens.com/industrymall>

Cax online generator

<http://support.automation.siemens.com/WW/CAXorder/default.aspx?lang=en&mlfb=3RS18001BW00>

Service&Support (Manuals, Certificates, Characteristics, FAQs,...)

<http://support.automation.siemens.com/WW/view/en/3RS18001BW00/all>

Image database (product images, 2D dimension drawings, 3D models, device circuit diagrams, EPLAN macros, ...)

<http://www.automation.siemens.com/bilddb/index.aspx?attID9=3RS18001BW00&lang=en>

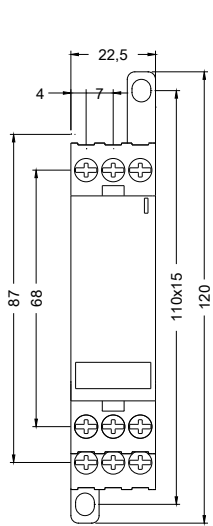

last modified:

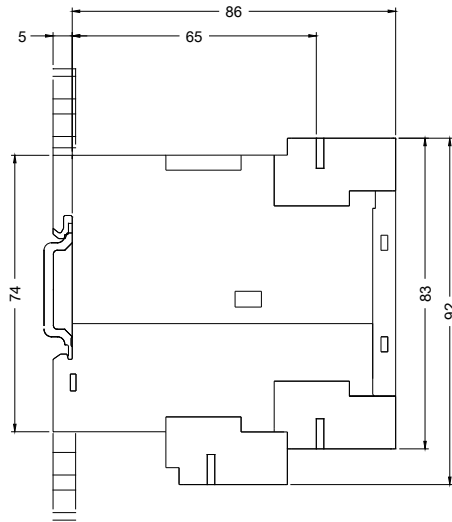

09.03.2015