

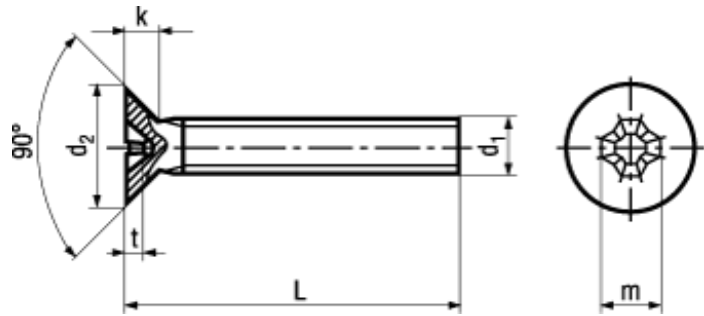

Standard withdrawn



**BN 388**

**Phillips flat countersunk head machine screws**

form H

Steel 4.8

zinc plated blue

- ~UNI 7688
- ~ČSN 021152





All lengths fully threaded  
Countersink must be designed according to the corresponding standard!

Article#	d <sub>1</sub>	d <sub>2</sub> max.	k max.		m~	t min.	t max.	L
3056380	M2	3,8	1,2	1	2,35	0,95	1,25	3
1156314								4
1156322								5
1156330								6
1156349								8
1156357								10
1156365								12
1135759								16
1135767								20
3056381	M2,5	4,7	1,5	1	2,7	1,25	1,55	3
2096722								4
1156373								5
1156381								6
1156403								8
1156411								10
1156438								12
1135775								16
1135783								20
3056382								25
3056383	M3	5,6	1,65	1	2,9	1,5	1,8	3
1375547								4
1156446								5
1156454								6
1156462								8
1156470								10
1156489								12



Article#	d <sub>1</sub>	d <sub>2</sub> max.	k max.		m~	t min.	t max.	L
1156497	M3	5,6	1,65	1	2,9	1,5	1,8	(14)
1156500								16
1156519								(18)
1156527								20
1156535								(22)
1156543								25
1156551								30
1135791								35
1135805								40
1471309								45
1471317								50
3056385	(M3,5)	6,5	1,93	2	3,9	1,4	1,9	5
1156578								6
1156586								8
1156594								10
1156608								12
1156616								(14)
1156624								16
1156640								20
1156667								25
1156675								30
3056388	M4	7,5	2,2	2	4,4	1,9	2,4	5
1156683								6
1156691								8
1156705								10
1156713								12
1156721								(14)
1156748								16
1156756								(18)
1156764								20
1156772								(22)
1156780								25
1156799								30
1156802								35
1156810								40
1471325								45
1471333								50
1471341								60
1471368								70
1471376								80
2096730	M5	9,2	2,5	2	4,6	2,1	2,6	6

Article#	d <sub>1</sub>	d <sub>2</sub> max.	k max.		m~	t min.	t max.	L
1156829	M5	9,2	2,5	2	4,6	2,1	2,6	8
1156837								10
1156845								12
1156853								(14)
1156861								16
1156888								(18)
1156896								20
1156918								(22)
1156926								25
1156934								30
1156942								35
1156950								40
1156969								45
1156977								50
1471384								60
1471392								70
1471406								80
3056389	M6	11	3	3	6,6	2,8	3,3	8
1156985								10
1156993								12
1157000								(14)
1157019								16
1157027								(18)
1157035								20
1157043								(22)
1157051								25
1157078								30
1157086								35
1157094								40
1157108								45
1157116								50
1135813								60
1471414								70
1471422								80
3056391	M8	14,5	4	4	8,7	3,9	4,4	12
1122657								16
1122673								20
1123025								25
1123033								30
1123491								35
1123890								40

Article#	d <sub>1</sub>	d <sub>2</sub> max.	k max.		m~	t min.	t max.	L
1124773	M8	14,5	4	4	8,7	3,9	4,4	45
1471430								50
1471449								60
1471457								70
1471465								80