

- 1
- 2
- 3
- 4
- 5
- 6
- 7
- 8
- 9
- 10
- 11
- 12
- 13
- 14
- 15
- 16
- 17
- 18

MATERIAL

Black-oxide steel, hardened steel insert.

LEVER ARM

AISI 303 stainless steel, sandblasted matte finish.

HANDLE

I.222 (see page 550) in phenolic based (PF) Duroplast, black colour, glossy finish.

STANDARD EXECUTIONS

GN 316-V: insert with square hole.

FEATURES AND APPLICATIONS

GN 316 ratchet spanners are used for assembly and repair work. They can also be used for fixed applications on machines and equipment. The positioning of the reversing lever sets ratchet spanners action: clockwise, anticlockwise or fixed action. By turning the arm in the opposite direction the insert turns freely allowing a comfortable clamping action. The inserts can be interchanged easily and supplied individually.

SPECIAL EXECUTIONS ON REQUEST

- GN 316-SK: insert with hexagonal hole.
- GN 316-K: insert with keyway.
- GN 316-M: insert with threaded hole.
- Arms in different lengths.

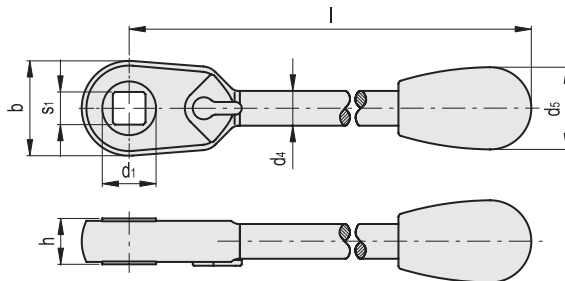
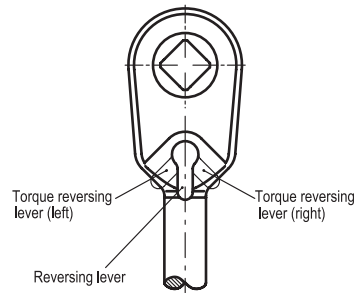
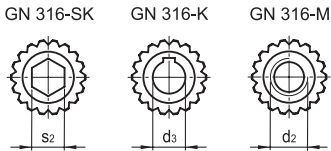

Clamping levers

350

Code	Description	d1	s1	l	h	d4	d5	b	C [Nm]	⚖️
GN.14851	GN 316-12-V8	12	8	118	11	9	20	22	40	290
GN.14853	GN 316-17-V10	17	10	156	14	11	25	30	100	400
GN.14855	GN 316-22-V12	22	12	187	17	14	33	39.5	130	520
GN.14857	GN 316-22-V14	22	14	187	17	14	33	39.5	130	515
GN.14859	GN 316-26-V17	26	17	219	22	17	33	46	180	605