

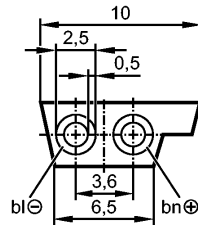

Flat cable 100 meter TPE red

Bus system AS-Interface



Product characteristics

AS-i flat cable

for use in insulation displacement connector technology for FC lower parts and compact modules

Reverse polarity protection due to special shape

Form supplied: coiled

Electrical data

Electrical design

AS-i

Environment

Ambient temperature [°C]

-40...105

Ambient temperature (moving) [°C]

-30...105

Protection

IP 67

Mechanical data

Weight [kg]

6.563

Electrical connection

Connection

/ 100 m; 2 x 1.5 mm<sup>2</sup>

Material

TPE

Sheath colour

red

Remarks

Remarks

100 m Form supplied: coiled

Pack quantity [piece]

1