

**Notes:**

**1. Material**

- 1.1 Insulator: Thermoplastic (UL 94V-0)
- 1.2 Contact: Copper alloy

**2. Specification**

- 2.1 Current rating: 1.5 Amp
- 2.2 Insulation resistance: 1000MΩ min.
- 2.3 Dielectric withstanding: 600VAC.
- 2.4 Contact resistance: 20mΩ max.
- 2.5 Operating temperature: -20°C to +80°C

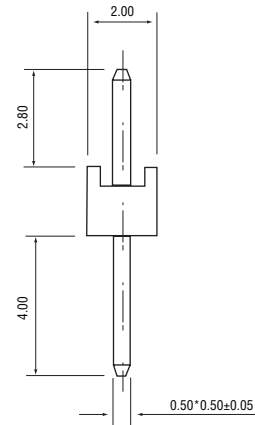
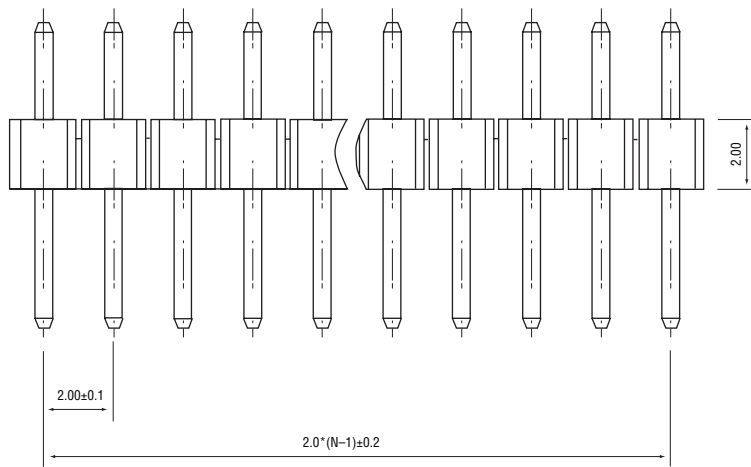
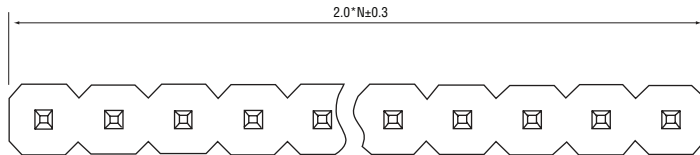

N: Number of contacts

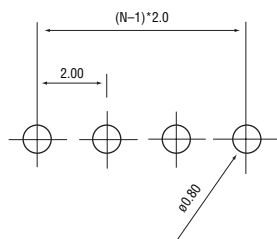

Recommend PCB layout (Tolerance  $\pm 0.05$ )