

BUILT-IN FUSE BASE WITH SIGNAL DETECTOR FOR CYLINDRICAL FUSES SIZE 8.5X31.5MM 20A, 3-POLE



Figure similar

Model

product brand name	SENTRON
--------------------	---------

General technical data

Number of poles	3
-----------------	---

Mechanical Design

Height	mm	81
Width	mm	54
Depth	mm	64

Certificates

Equipment marking		
<ul style="list-style-type: none"> • acc. to DIN EN 61346-2 • acc. to DIN EN 81346-2 		F F

General Product Approval



Further information

- Information- and Downloadcenter (Catalogs, Brochures,...)
<http://www.siemens.com/lowvoltage/catalogs>
- Industry Mall (Online ordering system)
<https://eb.automation.siemens.com/mall/en/WW/Catalog/Product/3NW7334>
- Service&Support (Manuals, Certificates, Characteristics, FAQs,...)
<http://support.automation.siemens.com/WW/view/en/3NW7334/all>

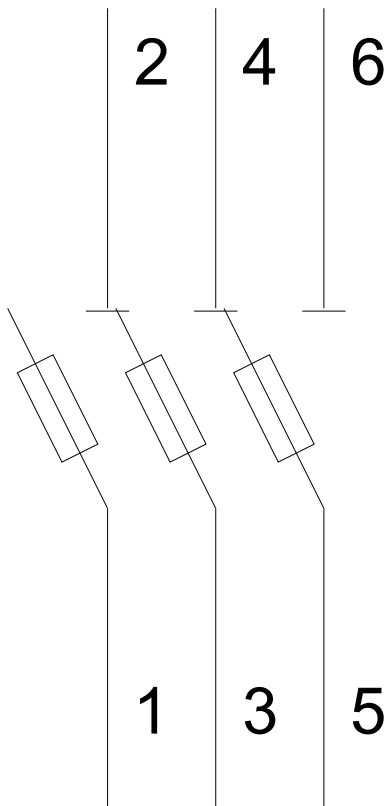
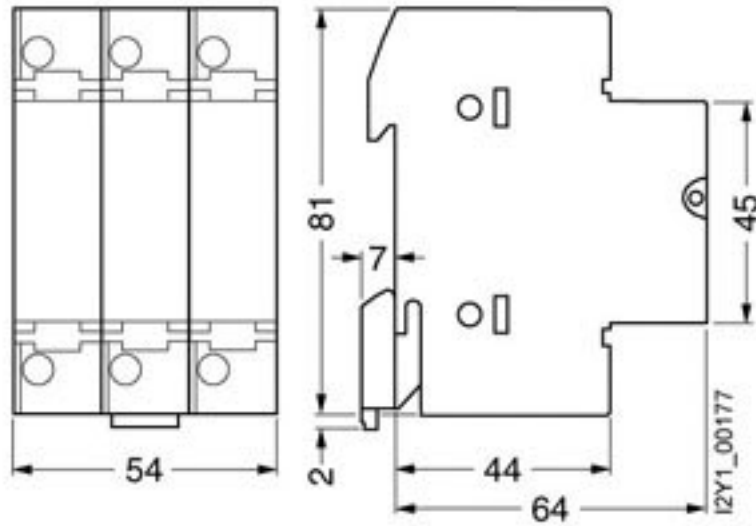

last modified:

11.03.2015