

6025DG

TO-220, TO-220-single gauge (0.020")



Copper space saving staggered fin heat sink

This non-electronic component is functionally unaffected by the normal soldering or reflow processes used for semiconductor circuits. The heat resistance time or heat resistance temperature is not applicable for the component.

Height: 31.75
Mount Orientation: Vertical
Finish: Tin Plated
RoHS: compliant

Thermal Resistance: 17.90

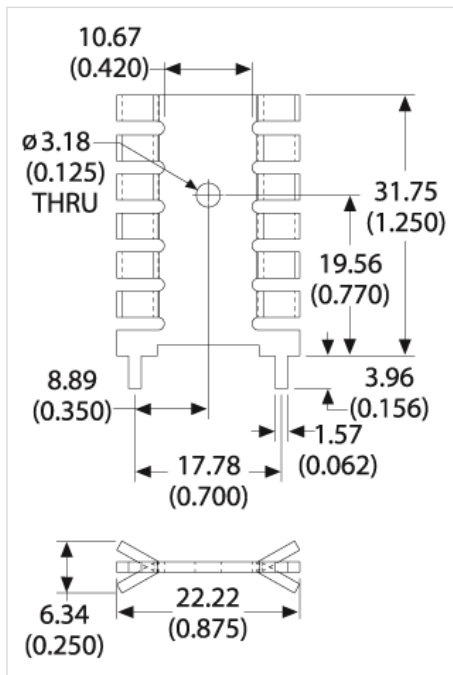

X Dim: 8.89 (0.350) | Y Dim: 0.64 (0.025) | Z Dim: 2.54 (0.100)

