

Apparatus Castors with Back Hole, Rubber Bandage TPE, Light Design

Swivel Castors

Material: Fork: steel plate, zinc-plated.
Tread: thermoplastic rubber, grey.
Wheel body: plastic, screwed.
Wheel mounting: ball bearing.
Swivel bearing: double ball wreath.

For indoor use. Low-noise operation with low rolling and swivelling resistance. Non-marking. The tread is slightly oily and can cause contact discolouration on sensitive surfaces.

Temperature range: -20°C to +60°C.

Ordering Details: e.g.: Product No. 777 130 50,
Swivel castor, TPE light, D 50 mm

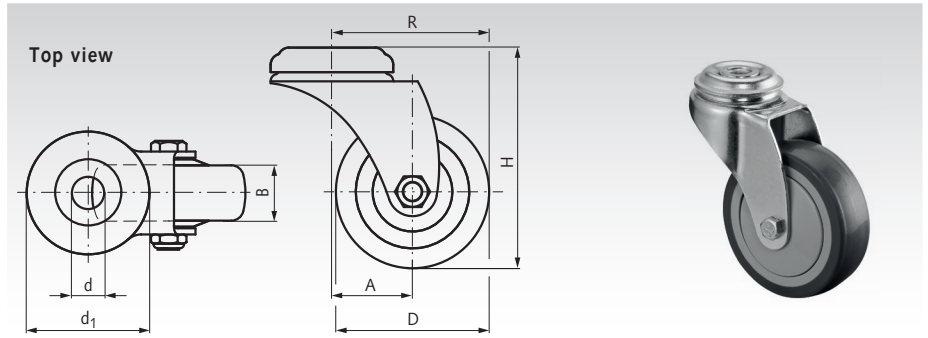

Product No.	D mm	B mm	H mm	A mm	R mm	d mm	d ₁ mm	Load capacity kg	Weight kg
777 130 50	50	20	73	26	51	10,2	38,1	50	0,14
777 130 75	75	25	103	38	75,5	10,2	43,2	60	0,26

Swivel Castors with Brake

Material: Fork: steel plate, zinc-plated.
Tread: thermoplastic rubber, grey.
Wheel body: plastic, screwed.
Wheel mounting: ball bearing.
Swivel bearing: double ball wreath.

For indoor use. Low-noise operation with low rolling and swivelling resistance. Non-marking. The tread is slightly oily and can cause contact discolouration on sensitive surfaces.

Temperature range: -20°C to +60°C.

Ordering Details: e.g.: Product No. 777 140 50,
Swivel castor with brake, TPE light, D 50 mm

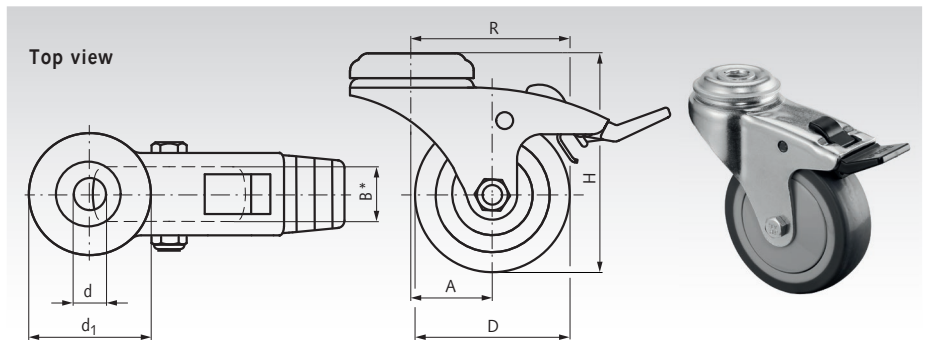

Product No.	D mm	B mm	H mm	A mm	R mm	d mm	d ₁ mm	Load capacity kg	Weight kg
777 140 50	50	20	73	26	51	10,2	38,1	50	0,26
777 140 75	75	25	103	38	75,5	10,2	43,2	60	0,30

* Width of wheel.