

DO NOT SCALE DRAWING

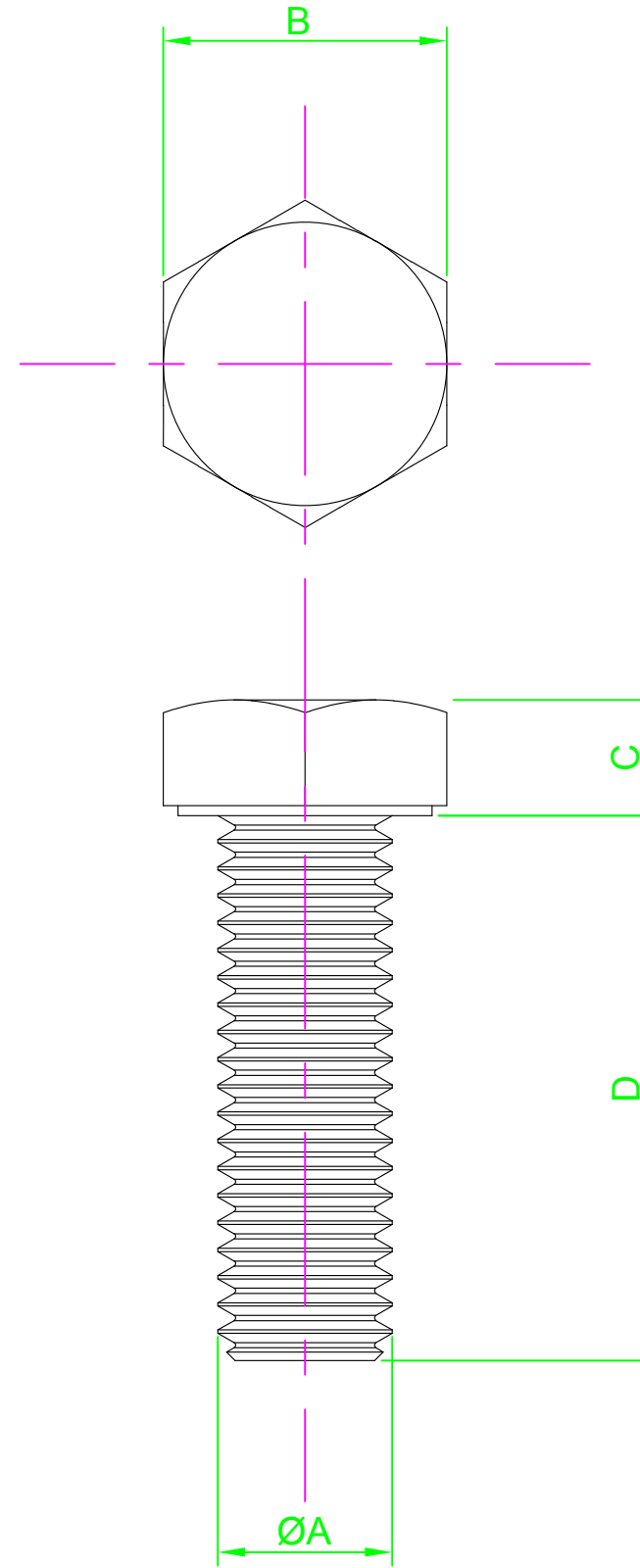
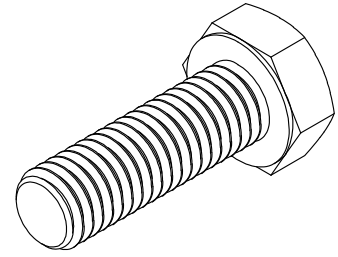

REVISION

A INITIAL DRAWING 26.01.16 DW

Part Number	ØA	B Nom	C Nom	D Length
M4 8 HHA2SC S100	M4-0.7	7.0	2.8	8.0
M4 10 HHA2SC S100				10.0
M4 12 HHA2SC S100				12.0
M4 16 HHA2SC S100				16.0
M4 20 HHA2SC S100				20.0
M4 25 HHA2SC S100				25.0
M5 8 HHA2SC S100	M5-0.8	8.0	3.5	8.0
M5 10 HHA2SC S100				10.0
M5 12 HHA2SC S100				12.0
M5 20 HHA2SC S100				20.0
M5 25 HHA2SC S100				25.0
M5 30 HHA2SC S100				30.0
M5 50 HHA2SC S100				50.0
M6 10 HHA2SC S100	M6-1.0	10.0	4.0	10.0
M6 12 HHA2SC S100				12.0
M6 16 HHA2SC S100				16.0
M6 20 HHA2SC S100				20.0
M6 25 HHA2SC S100				25.0
M6 30 HHA2SC S100				30.0
M6 40 HHA2SC S100				40.0
M6 50 HHA2SC S100				50.0

NOTES:



UNLESS OTHERWISE SPECIFIED:
DIMENSIONS ARE IN MM (MILLIMETERS).
SURFACE FINISH:
TOLERANCES: DIN 933

MATERIAL:
Stainless Steel A2

TITLE:
Hex Head Set Screw DIN 933

	NAME	DATE
DRAWN	Darryl Wilson	26.01.16
CHK'D		
APPVD		

HEAT TREATMENT:
N/A

DESIGN RIGHT. TR FASTENINGS LTD, 2003
UNDER NO CIRCUMSTANCES MUST THIS
DRAWING BE COPIED OR DISCLOSED
WITHOUT FIRST OBTAINING WRITTEN
AUTHORITY.

CUSTOMER PART NUMBER:
N/A

FINISH:
Self Finish

DRAWING NUMBER:
TR32HHA2SCS100

A4

