

No.	Changes and/or Note No.	Date	Sign	No.	Changes and/or Note No.	Date	Sign

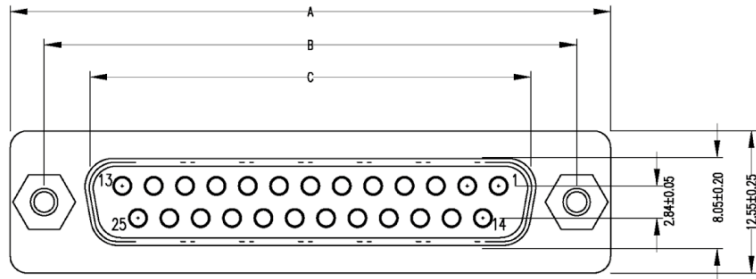

Hexscrew & Nut

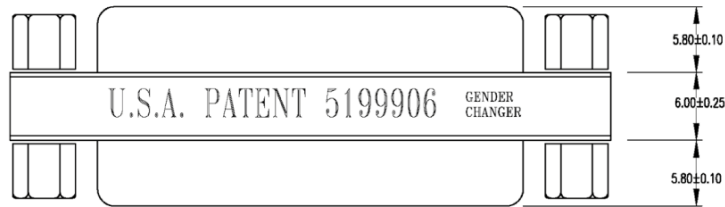
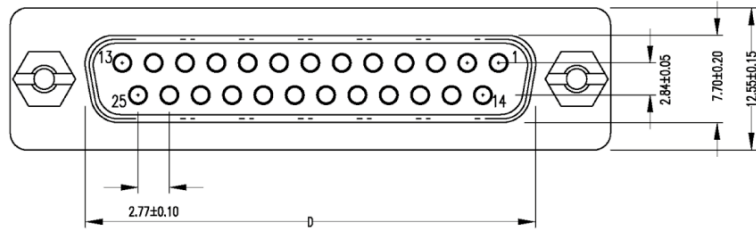
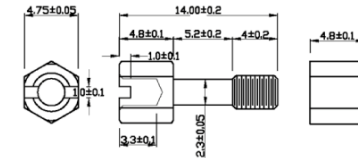

GENDER CHANGER

PIN OUT: R1 = L1

Label: yellow color with black character

One side: U.S.A. PATENT 5199906

The other side: R.O.C. PATENT 64341

SPECIFICATION

INSULATOR: PBT Glass fibre reinforced UL 94 V0

CONTACT: Brass

CONTACT PLATING: Gold plated over nickel

SHELL: Tin plated shell

CURRENT RATING: 3 AMP

DIELECTRIC STRENGTH: 1000V AC for one minute

INSULATOR RESISTANCE: 1000MΩ min at 500V DC

TEMPERATURE: -55°C — +105°C

Part no.	Type/Item	A± 0.15	B± 0.10	C± 0.15	D± 0.10
2401-0100-21	9F/F	30.8	25.0	16.35	16.35
2401-0100-22	15F/F	39.2	33.3	24.7	24.7
2401-0100-23	25F/F	53.05	47.04	38.4	38.4
2401-0100-24	37F/F	69.4	63.5	54.8	54.8

DATE	2012-08-16	DRAWN	MRR	SCALE	MATERIAL TYPE
		APPROVED			REPLACES
GENDER CHANGER - STANDARD Female to Female DMGC-xxxx-FF					
					DRAWING No.