

# SIMONWORK BT0 1200

**5** Años Garantía  
Years Guarantee  
Jahre Garantie  
Ans Garantie  
Anos de Garantía  
**SIMONRACK**

**842 x 1210 x 760 mm**  
**33.1" x 47.6" x 29.9"**



\*MEDIDAS EN USO USED MEASUREMENTS  
MASSNAHMEN IM EINSATZ MESURES EN EMPLOI MEDIDAS EN USO:  
842 x 1210 x 610 mm (33.1" x 47.6" x 24")



ESTANTERIAS SIMON S.L. B.60.566.463  
PG. ALFAMEN C/ POLIGONO C. Nº3  
ALFAMEN (ZARAGOZA)



**Simon  
Rack**  
SINCE 1964 - MANUFACTURER



[www.simonrack.com](http://www.simonrack.com)



INSTRUCCIONES  
INSTRUCTIONS  
ANLEITUNG  
INSTRUCTIONS

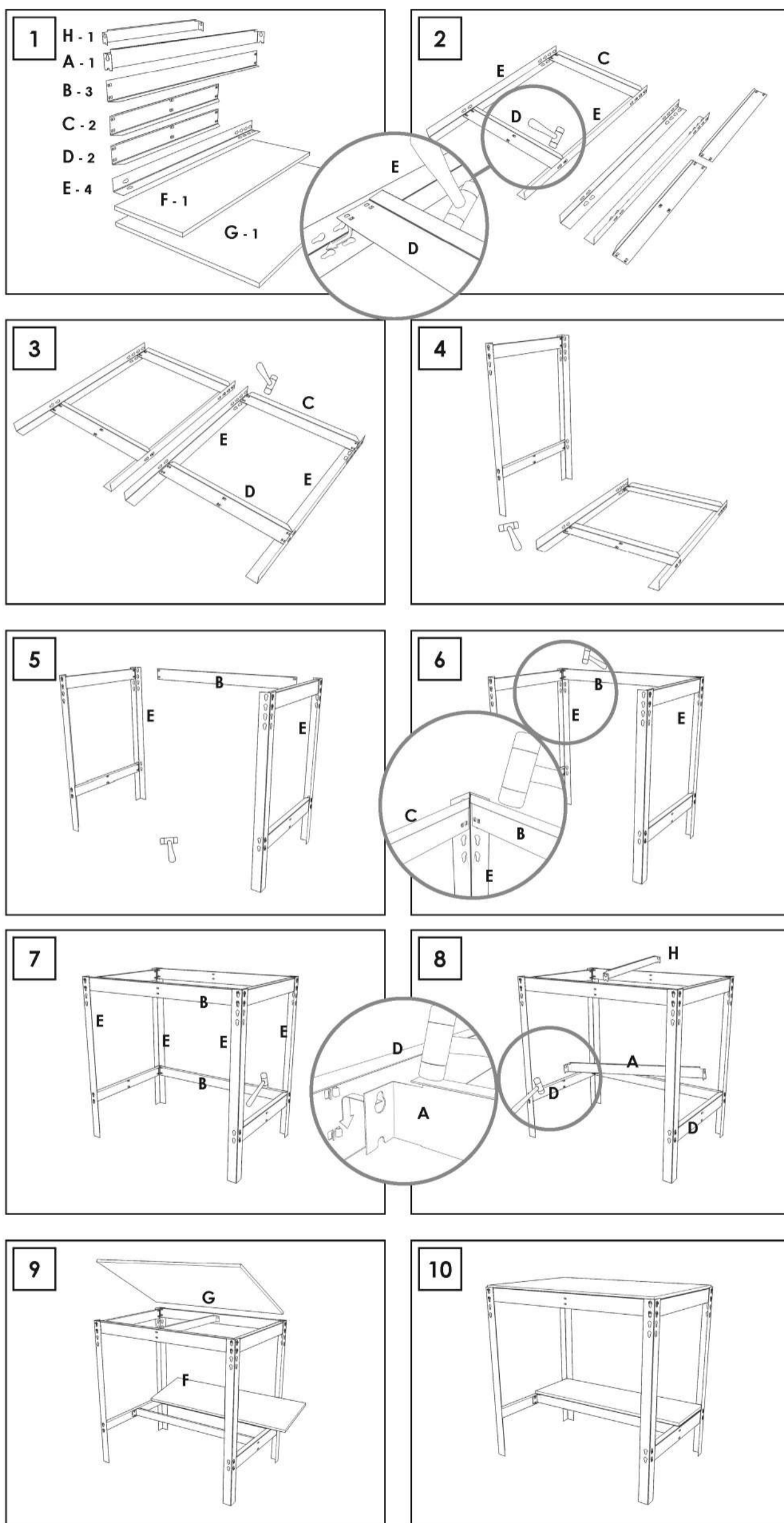

www.simonrack.com • www.simonrack.com • www.simonrack.com • www.simonrack.com • www.simonrack.com • www.simonrack.com • www.simonrack.com • www.simonrack.com • www.simonrack.com • www.simonrack.com

**SIMONCLASSIC**

**SIMONCLICK**

**SIMONTALLER**

**SIMONAUTO**

**SIMONWORK**

**SIMONLOCKER**

**SIMONOFFICE**

**SIMONHOME**

**SIMONGARDEN**

**SIMONTITÁN** | **SIMONINOX**

**SIMONINDUSTRIAL**

**SIMONPALET** | **SIMONLEVER**

ALTILLOS Y PASILLOS ELEVADOS  
PLATFORMS AND MEZZANINES  
LAGERBÜHNEN • PLATES-FORMES ET MEZZANINES

