

AC-Electronic Current Transducer STWA1AH

with analog output

STWA1AH
Electronic current transformer
AC 0...15 A - DC 0...20 mA

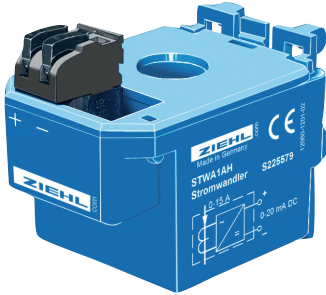

The STWA1AH is a measuring transducer for AC currents 0...15 A. Multiple loops of the conductor through the transformer reduces the measuring range correspondingly (for instance to 0...5 A with three loops).

For the monitoring of currents of any level, the STWA1AH is simply looped into the secondary circuit of a large transformer with secondary 5 A (cable three times through the STWA1AH). Consequently, the output is proportional to the primary current of the transformer, e.g. 0...100 A for a transformer with 100/5 A.

The analog output is isolated. The load should be 50...300 Ω .

Application: The STWA1AH makes it possible to monitor the value of an AC current. The output signal can be evaluated or displayed with components with analog inputs, e.g. ZIEHL TR210, STW1000/V2 or MINIPAN®.

- current-proportional analog output DC 0...20 mA = AC 0...15 A (isolated)
- electrical connection via screwless pluggable terminals
- no supply voltage required
- DIN-rail-mount or with screws
- plug-in current transformer (\varnothing 11 mm)
- max. overload 100 A continuously, 300 A / 10 s
- plug-in current transformer, easy assembly

Order-number **S225579**

Monitoring range
Analog output
Adjustment time
Error (from 10% / I_{nom})

AC 0 - 15 A
DC 0 - 20 mA
< 0,5 s.
<3% from FS (at 100 Ω), <5% 50...200 Ω
<7% ..300 Ω

Error with other load
Temperature coefficient
Ripple at 50 Hz

+5%/100 Ω , max. 500 Ω
< 0,06%/K
<2,5 % at 300 Ω , <4,5 % at 100 Ω , <7,5 % at 50 Ω

Nominal frequency
Operating range
Error

50 Hz
30...400 Hz
 $\leq 0,2\%/Hz$

Overload cap. continuous / 10s

100 A / 300 A

Rated ambient temperature range

0...55°C

Housing
Dimensions (h x w x d)
Diameter for conductor
Weight

Design H
42 x 36 x 56 mm
11 mm
app. 90 g

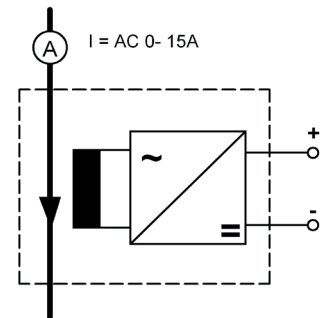

Dimension illustrations

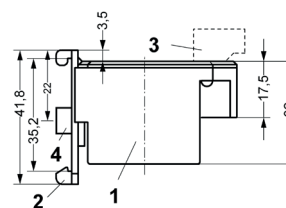
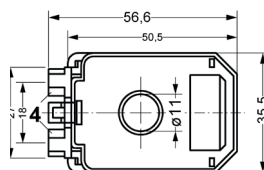

- 1 Housing
- 2 Clip for DIN-rail (removeable)
- 3 Terminal (pluggable)
- 4 Wall-mounting (M4)