

SYSTEM COMPONENT REFL BOLT

Accessories

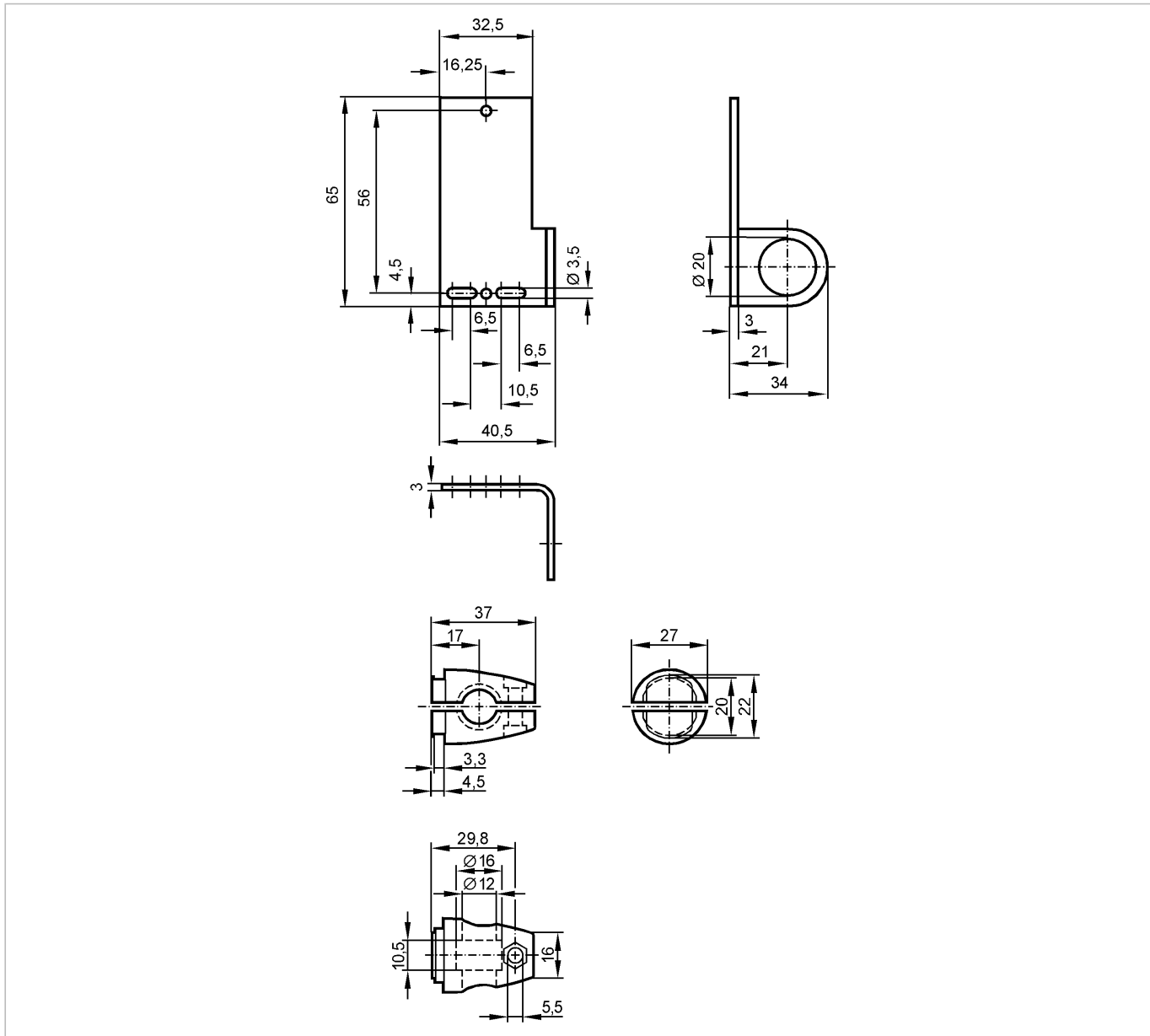

Product characteristics

Mounting set

Clamp mounting

Mechanical data

Design

for reflector; 66 x 31 mm / 57.6 x 32.5 mm

Housing materials

fixture: stainless steel 316Ti / 1.4571; clamp: diecast zinc

Type of mounting

Free-standing M10

Weight

[kg]

0.22

Accessories

Accessories (included)

Head cap screw; M10 x 55

Remarks

Pack quantity

[piece]

1