



Model Number

NBB2-F1-US

Features

- 2 mm flush
- 2-wire AC/DC

Connection

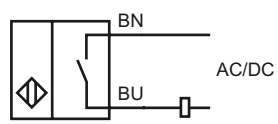

Dimensions

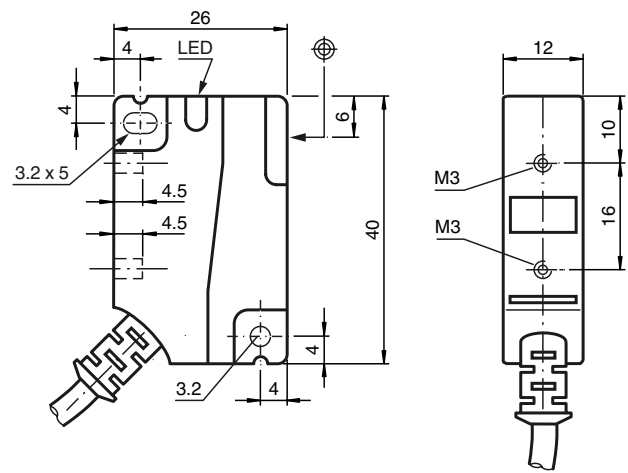

Technical Data

General specifications		
Switching element function		AC/DC NO
Rated operating distance	s_n	2 mm
Installation		flush
Output polarity		AC/DC
Assured operating distance	s_a	0 ... 1.62 mm
Reduction factor r_{AI}		0.3
Reduction factor r_{CU}		0.2
Reduction factor r_{304}		0.7
Nominal ratings		
Operating voltage	U_B	20 ... 253 V AC/DC
Switching frequency	f	0 ... 25 Hz
Hysteresis	H	typ. 5%
Reverse polarity protected		reverse polarity protected
Short-circuit protection		pulsing
Voltage drop	U_d	≤ 7 V
Momentary current (20 ms, 0.1 Hz)		0 ... 2100 mA
Operating current	I_L	4 ... 250 mA AC 4 ... 100 mA DC
Off-state current	I_r	≤ 1.7 mA
No-load supply current	I_0	≤ 4 mA
Operating voltage display		LED, green
Indication of the switching state		LED, yellow
Ambient conditions		
Ambient temperature		-25 ... 70 °C (-13 ... 158 °F)
Mechanical specifications		
Connection type		cable PVC, 2 m
Core cross-section		0.5 mm ²
Housing material		PA
Sensing face		PA
Protection degree		IP67
Tightening torque, fastening screws		Threading M3 max: 1.1 Nm
Compliance with standards and directives		
Standard conformity		
Standards		EN 60947-5-2:2007 IEC 60947-5-2:2007
Approvals and certificates		
UL approval		cULus Listed, General Purpose
CSA approval		cCSAus Listed, General Purpose
CCC approval		Certified by China Compulsory Certification (CCC)

Release date: 2012-06-04 10:28 Date of issue: 2012-06-04 188298_eng.xml