

WIRE CONNECTOR 2 CABLES 4 PCS. ACCESSORY FOR: 3VA6
150/250



| Model | |
|-----------------------|-----------------------------|
| Product brand name | SENTRON |
| Product designation | accessories |
| Design of the product | circular conductor terminal |

| Connections according IEC | |
|--------------------------------------------------------------------------------------------------|---------------------|
| Connectable conductor cross-section | |
| <ul style="list-style-type: none"> • for copper cable / finely stranded / minimum | 25 mm ² |
| <ul style="list-style-type: none"> • for copper cable / finely stranded / maximum | 150 mm ² |
| <ul style="list-style-type: none"> • for copper cable / stranded / minimum | 25 mm ² |
| <ul style="list-style-type: none"> • for copper cable / stranded / maximum | 150 mm ² |
| <ul style="list-style-type: none"> • for aluminum cable / stranded / minimum | 25 mm ² |
| <ul style="list-style-type: none"> • for aluminum cable / stranded / maximum | 150 mm ² |
| Wire stripping length | 25 / 50 mm |
| Tightening torque / when using copper cables | |
| <ul style="list-style-type: none"> • stranded | 31 |
| <ul style="list-style-type: none"> • finely stranded | 31 |

| Connections according UL | |
|--------------------------|--------------|
| Wire stripping length | 1.0 / 2.0 in |

| | |
|------------------------------------------------------------------------------------------------------------------------------------------------------------------------------------------------------------------------------------------------------------------------------------------------------------------------------------------------------------------|----------------------------------------------------------------------------|
| Connectable conductor cross-section | |
| <ul style="list-style-type: none"> • for copper cable / stranded / minimum • for copper cable / stranded / maximum • for copper cable / finely stranded / minimum • for copper cable / finely stranded / maximum • for aluminum cable / stranded / minimum • for aluminum cable / stranded / maximum | <p>4 AWG 300 kcmil 4 AWG 300 kcmil 4 AWG 300 kcmil</p> |
| Tightening torque / when using copper cables | |
| <ul style="list-style-type: none"> • stranded • finely stranded | <p>275 lb-in 275 lb-in</p> |

Certificates

| General Product Approval | EMC | Declaration of Conformity | other |
|--------------------------|-----|---------------------------|-------|
|--------------------------|-----|---------------------------|-------|



[Miscellaneous](#)

Further information

Information- and Downloadcenter (Catalogs, Brochures,...)

<http://www.siemens.com/lowvoltage/catalogs>

Industry Mall (Online ordering system)

<https://mall.industry.siemens.com/mall/en/en/Catalog/product?mlfb=3VA9244-0JJ22>

Service&Support (Manuals, Certificates, Characteristics, FAQs,...)

<https://support.industry.siemens.com/cs/ww/en/ps/3VA9244-0JJ22>

Image database (product images, 2D dimension drawings, 3D models, device circuit diagrams, ...)

http://www.automation.siemens.com/bilddb/cax_en.aspx?mlfb=3VA9244-0JJ22

CAX-Online-Generator

<http://www.siemens.com/cax>

Tender specifications

<http://www.siemens.com/specifications>

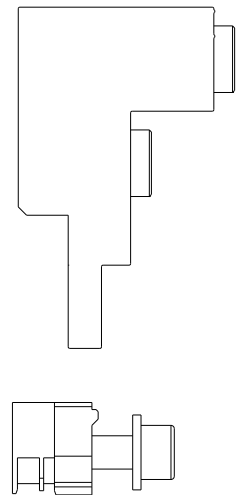
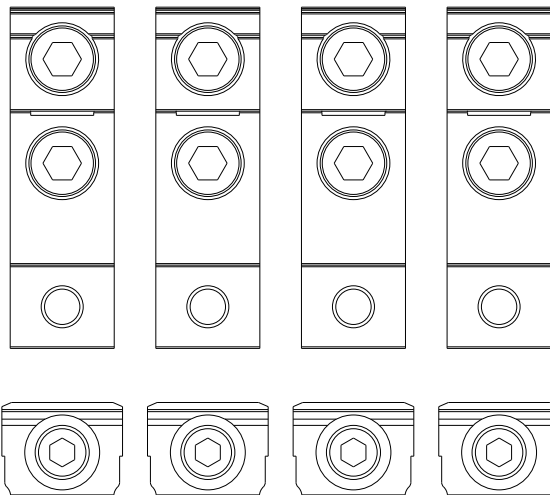
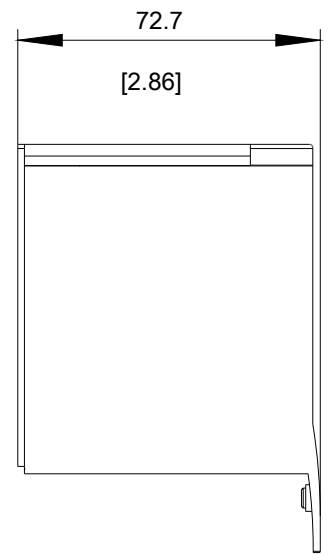
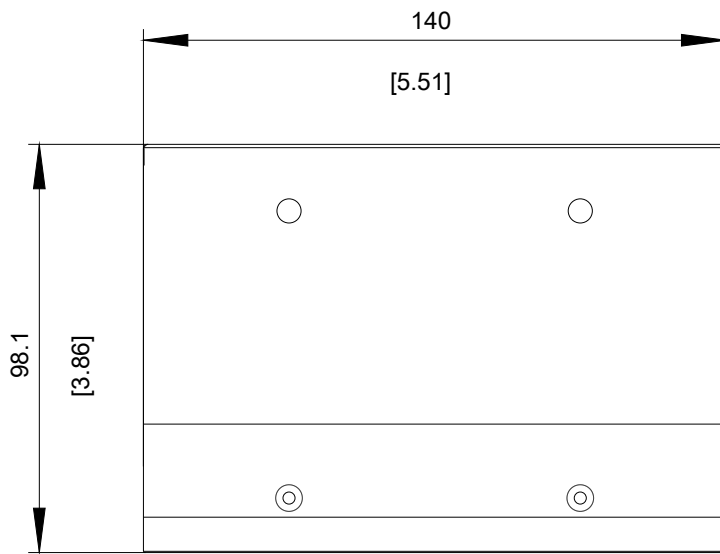

last modified:

08/28/2017