

Order code	Manufacturer code	Description
75-0211	100-SP1-T100B1M1QE	MINIATURE TOGGLE SWTH SPDT (RC)

	Page 1 of 6
The enclosed information is believed to be correct, Information may change 'without notice' due to product improvement. Users should ensure that the product is suitable for their use. E. & O. E.	Revision A 04/07/2003

OUTLINE OF CHANGES ON THE DOCUMENT				
Version	Description	Page of modification	Issue by	Issue date
A	First released	-	Cheng	1999.01.01
B	Adding detailed product data	1 - 4	Amy	2002.01.01
B-1	Adding switch function, packing and soldering information	1 - 3	Amy	2004.04.01
C	RoHS compliant item	2 - 3	Amy	2005.07.01

| SPECIFICATION FOR TOGGLE SWITCH |

ATTENTION	
<p><i>Customer shall acknowledge the datasheet by returning "this cover page with authorized signature" before placing order. Lack of acknowledgement or additional response constitutes acceptance of the herein contents.</i></p> <p>下單前請將此份"規格書封面簽回",未簽回則視為承認本規格書內容.</p>	
Approved By	Entered Date

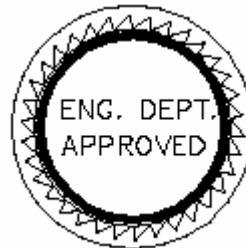

CUSTOMER: Rapid

PART NO.: 75-0211

TAIWAY P/N.: 100-SP1-T100B1M1QE



DATE OF ISSUE: 2006 Sep. 5

ISSUE BY: Amy Yen

APPROVED BY: Andy Weng

Product Data Sheet						Page:	1	/	3	
SWITCH TYPE:		Series 100 Miniature Toggle Switch								
POLES/THROWS:		SPDT, DPDT, 3PDT, 4PDT								
SWITCH FUNCTIONS:		MODEL		SPDT	DPDT	3PDT	4PDT			
		ON-NONE-ON	SP1	DP1	*	*	*	*		
			3P1	4P1						
		ON-NONE-(ON)	SP2	DP2	*	*	*	*		
			3P2	4P2						
		ON-OFF-ON	SP3	DP3	*	*	*	*		
			3P3	4P3						
		(ON)-OFF-ON	SP4	DP4	*	*	*	*		
			3P4	4P4						
		ON-OFF-(ON)	SP5	DP5	*	*	*	*		
			3P5	4P5						
		ON-ON-ON	DP6	4P6		*			*	
(ON)-ON-(ON)	DP7	4P7		*			*			
ON-ON-(ON)	DP8	4P8		*			*			
OFF-ON-(ON)	DP9	4P9		*			*			
ELECTRICAL CHARACTERISTICS	CONTACT RATING:	MAX. 5Amps @ 125VAC or 28VDC 2Amps @ 250VAC								
	ELECTRICAL LIFE:	50,000 make-and-break cycles at full load								
	CONTACT RESISTANCE:	10m-ohms max. initial @ 2-4VDC, 100mA for both silver and gold plated contacts								
	INSULATION RESISTANCE:	Apply 500VDC for 1min?5sec. After which measurement to be made b/w terminals shall result 1000M-ohms min.								
	DIELECTRICAL STRENGTH:	1,500V (50Hz-60Hz) RMS @ sea level shall result no damage to parts arcing or flashover								
	OPERATING TEMPERATURE:	-30Celsius degree to 85Celsius degree								
RELAIBILITY PERFORMANCE	SOLDERING ABILITY:	Per MIL-STD-202F method 208D,max soldering temperature @ 260Celsius degree, flux 5-10sec, duration of solder immersion 5+/-1sec. shall result no anti-soldering and the coverage of dipping into solder must be more than 90%								
	SOLDERING HEAT RESISTANCE:	Max soldering temperature @ 260Celsius degree, immersion time 5+/-1sec, frequency of soldering process @ 2 times max.								
	COLD TEST:	Stored at temperature -30(+/-3)Celsius degree for 48 hours, shall result no changes to switch's electrical performance								
	HOT TEST:	Stored at temperature 85(+/-3)Celsius degree for 48 hours, shall result no changes to switch's electrical performance								
	HUMIDITY TEST:	Stored at temperature 85(+/-3)Celsius degree with relative humidity 90%~95% for 48 hours, shall result no changes to switch's electrical performance								

		Product Data Sheet	Page: 2 / 3
RELAIBILITY PERFORMANCE	SALT SPRAY RESISTANCE:	Stored at temperature @ 35(+/-3)Celsius degree, and salt solution concentration of 5% with full air temperature @ 47(+/-3) Celsius degree and air pressure 1.0kg for 48 hours. The switch shall result no corrosion as well as no apparent changes to its functional performance. Per ASTM-B117 & JIS-Z371 STD.	
	MATERIAL CHARACTERISTICS	CASE:	Diallyl phthalate (DAP)(UL 94V-0)
TOGGLE HANDLE:		Brass, chrome plated Zinc alloy, nickel plated (locking lever types only)	
BUSHING:		Brass, nickel plated	
HOUSING:		Stainless steel	
SWITCH SUPPORT:		Brass, tin plated	
MOVABLE CONTACT:		Copper alloy, silver plated	
TERMINAL CONTACT:		Copper alloy, silver plated	
ALL TERMINALS:		Copper alloy, silver plated	
TERMINAL SEAL:		Epoxy sealed (std. type)	
HARDWARE:		Nut(brass), locking ring lock washer(stainless steel)	
ACCESSARY:		Cap - polyvinyl choride Locking lever cap - AL with anti-oxidation finish Rubber boot - silicone rubber, bronze or brass plated depending on toggle types	
SOLDERING & CLEANING RECOMMENDATION	HAND SOLDERING:	Max. temperature @ 350Celsius degree (662F)with continuous soldering time @ 3sec. max. Recommend soldering irons of 25-40 watts max. and solder of 0.030~0.040 dia.	
	WAVE (DIP) SOLDERING:	No-clean flux wave soldering is recommended so the switch does not require washing after soldering process. Noted, not to have flux migrate inside the switch through the top of the housing or actuator to prevent contamination. Max temperature @ 260Celsius degree (500F) for 10sec.	
	CLEANING PROCESS:	Noted, the switch is "not totally sealed" so it is important not to immerse/spray or clean unsealed areas of the switch during flux removal. To clean after soldering, keep the switch in an up-right position and tape-sealed the non-washable area such as cover and actuator to prevent the cleaning solution from entering into the body of the switch. Improper cleaning could cause switch deficiencies such as intermittence or open contact failures	

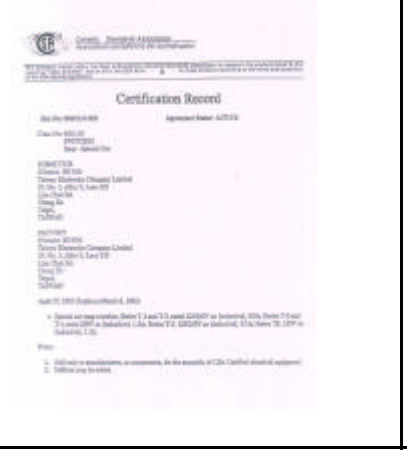
Product Data Sheet		Page:	3 / 3
PACKAGE	INTERNAL PACKAGING:	Depending on the switch types, certain quantity of switches are seal-packed in PE bag.	
	EXTERNAL PACKAGING:	The bags are packed in carton box [approx. dimension (L)19.5cm x (W)13.4cm (H)4.5cm] with label attached outside that identifies product part no./customer part no., quantity per box, order no./PI no., and date of quality inspection carried out.	
	RoHS/Pb-free IDENTIFICATIONS:	A label marking "RoHS compliant" and "Pb-free" will be attached to the carton box.	
PRODUCT HANDLING & STORING	<p>The switch is suitable for power rated applications, rating recommendation is per aforementioned above (Contact rating section)</p> <p>Problem relates to terminal oxidization can be prevented by storing product in an environment that is dry and cool with the relative humidity less than 90%. Noted, prior to mounting products onto circuit board as well as for unused units, it is recommended to keep them in the bag and with the bag sealed.</p>		
AGENCY APPROVALS			
			
	File No.: E133772		File No.: 090672-0-000

REV. 圖號	DESCRIPTION 說明	ENG. 繪圖人	APPROVE 審核
------------	-------------------	-------------	---------------

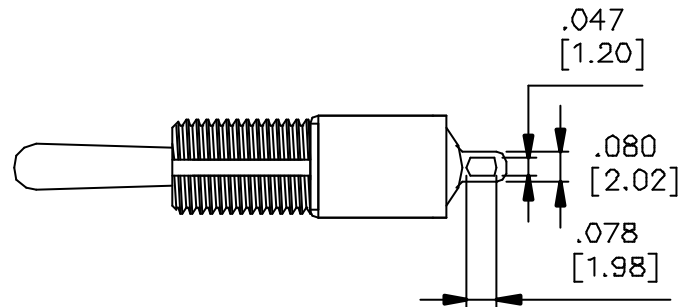
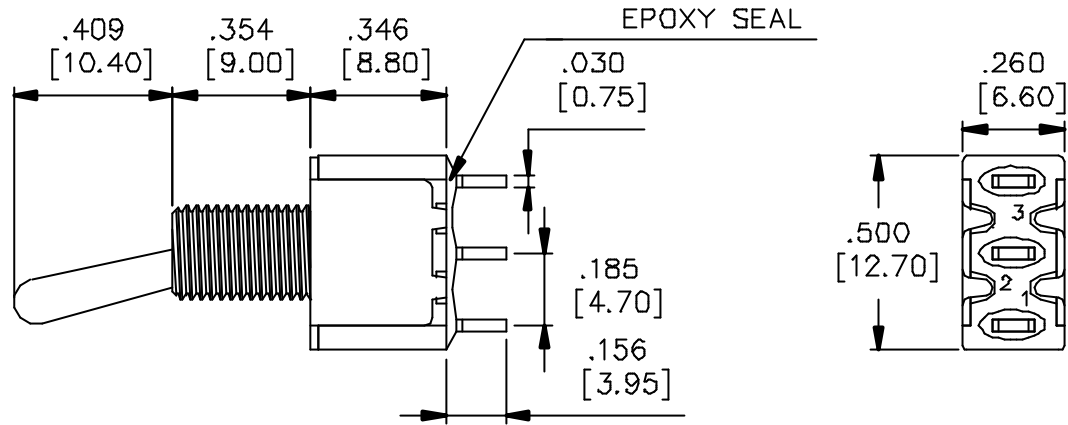
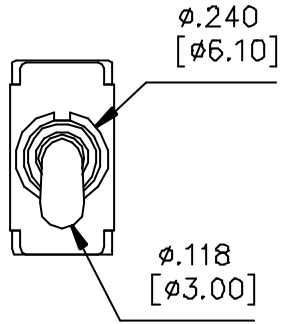

MODEL NO.	SWITCH POSITION		
SP-1	DN	NONE	DN
SP-2	DN	NONE	DN
SP-3	DN	OFF	DN
SP-4	DN	OFF	DN
SP-5	DN	OFF	DN
Term. Comm.	2-3	OPEN	2-1

SPECIFICATIONS:

- MOVABLE CONTACT: Copper alloy, silver plated
- TERMINALS: Copper alloy, silver plated
- RATING: 5Amps with resistive load @ 125VAC or 28VDC
2Amps with resistive load @ 250VAC
- CONTACT RESISTANCE: 10m-ohms max. initial
- INSULATION RESISTANCE: 1,000M-ohms min.
- DIELECTRIC STRENGTH: 1,500V RMS @ sea level
- ELECTRICAL LIFE: 50,000 make and break cycles at full load
- OPERATING TEMPERATURE: -30°C to 85°C

ITEM NO.	100-SP-1-T100B1M1QE
料號	1MS1T1B1M1QE

THESE DRAWINGS AND SPECIFICATIONS ARE THE PROPERTY OF TAIWAY ELECTRONICS LTD. AND SHALL NOT BE REPRODUCED COPIED OR USED IN ANY MANNER WITHOUT THE PRIOR WRITTEN CONSENT OF TAIWAY ELECTRONICS LTD.

UNLESS OTHERWISE SPECIFIED DIMENSIONS ARE IN MILLIMETERS ANGULAR TOLERANCE: ±1.0°	
DIMENSIONS	TOLERANCE
0.00 TO 30.00mm	±0.20mm
30.01 TO 80.00mm	±0.25mm
80.01 TO 150.00mm	±0.30mm
150.01 ↑	±0.40mm

MATERIAL

泰瑋電子有限公司
TAIWAY ELECTRONICS COMPONENTS CO.,LTD.

USED 用號	100	APPD. 審核	Andy 2002/12/16
FINISH 處理		CHKD. 檢查	Andy 2002/12/16
SCALE 比例	2 / 1	DR. 繪圖	Andy 2002/12/16
TITLE 名稱	TOGGLE SWITCH		
DWG NO. 圖號	100-SP-1-T100B1M1QE		SIZE 圖幅
FILE NAME 檔案名稱	1MS111QE.dwg	SHEET 張	1 / 1
		REV. 版次	3