

E20970

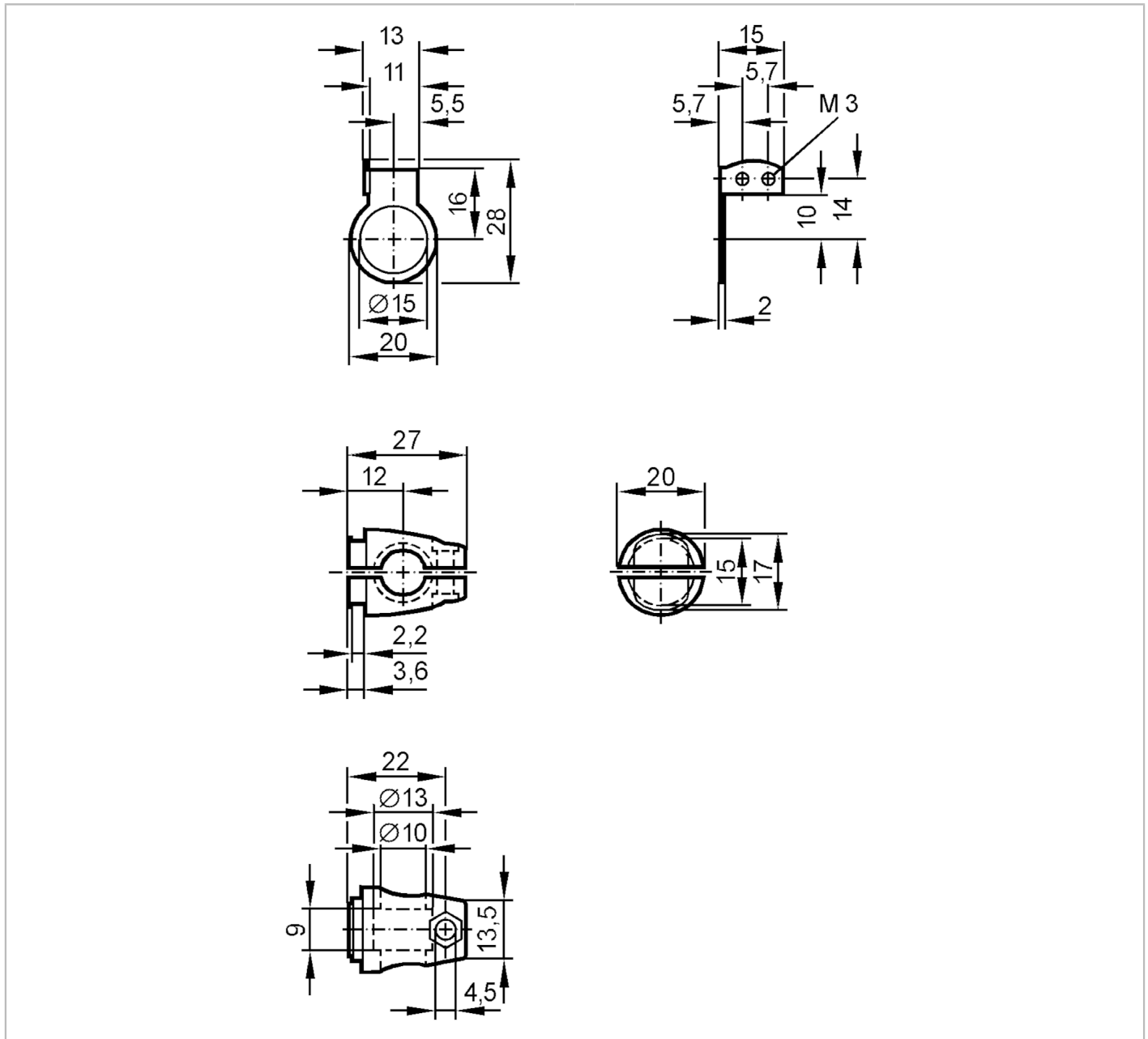

Mounting set for photoelectric sensors

SYSTEM COMPONENT OJ ROD



Application	
Design	clamp mounting, for front lens
Mechanical data	
Weight [g]	44
Type of mounting	Mounting rod; ($\varnothing 10$ mm)
Materials	fixture: stainless steel (1.4571/316Ti); Clamp: diecast zinc
Remarks	
Pack quantity	1 pcs.