

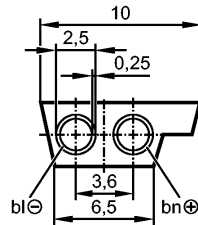

Flat cable 200 m EPDM bk 2.5 qmm

Bus system AS-Interface



Product characteristics

AS-i flat cable

for use in insulation displacement connector technology for FC lower parts and compact modules

Reverse polarity protection due to special shape

supplied on a wooden reel

Core cross-section 2.5 mm²

Electrical data

Electrical design

external 24 V power supply

Operating voltage [V]

24 V DC

Environment

Ambient temperature [°C]

-40...85

Protection

IP 67

Mechanical data

Weight [kg]

15

Electrical connection

Connection

/ 200 m; 2 x 2.5 mm²

Material

EPDM; halogen-free

Sheath colour

black

Remarks

Remarks

200 m supplied on a wooden reel

Pack quantity [piece]

1