

## Locking Assemblies COM-LLH

**Material:** Steel.

- For fixing a hub (e.g. sprocket or similar) on a shaft.
- For very high torques.
- Very good distribution of pressure.
- High resistant against bending forces.
- Self-centering.
- Self-locking.
- No axial movement during mounting.

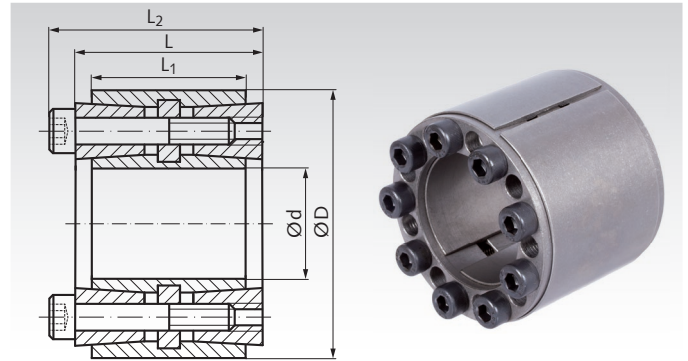

Ordering Details: e.g.: Product No. 615 580 42, Locking Assembly COM-LLH, 42 mm

Product No.	d mm	D mm	L mm	L <sub>1</sub> mm	L <sub>2</sub> mm	at T <sub>A</sub> transmittable		Surface Pressure		Screws DIN 912 12.9 Number x Size	T <sub>A</sub> Nm	Weight kg
						T Nm	F <sub>ax</sub> kN	Shaft P <sub>w</sub> N/mm <sup>2</sup>	Hub P <sub>N</sub> N/mm <sup>2</sup>			
615 580 42	42	75	64	56	72	3290	147	175	103	8 x M8	41	1,25
615 580 45	45	75	64	56	72	3500	147	157	95	8 x M8	41	1,30
615 580 48	48	80	64	56	72	3670	149	143	90	8 x M8	41	1,50
615 580 50	50	80	64	56	72	3800	161	141	91	8 x M8	41	1,40
615 580 55	55	85	64	56	72	4430	167	140	88	8 x M8	41	1,50
615 580 60	60	90	64	56	72	5590	182	130	96	10 x M8	41	1,50
615 580 65	65	95	64	56	72	6020	182	134	91	10 x M8	41	1,60
615 580 70	70	110	78	70	88	10200	290	162	100	10 x M10	83	3,0
615 580 75	75	115	78	70	88	11660	308	157	101	10 x M10	83	3,1
615 580 80	80	120	78	70	88	14000	351	166	109	12 x M10	83	3,5
615 580 85	85	125	78	70	88	16200	374	170	113	12 x M10	83	3,5
615 580 90	90	130	78	70	88	16780	380	159	107	12 x M10	83	3,8
615 580 95	95	135	78	70	88	18410	389	158	107	12 x M10	83	4,0
615 581 00	100	145	100	90	112	26600	533	158	109	12 x M12	145	6,0
615 581 10	110	155	100	90	112	29200	533	142	101	12 x M12	145	6,2
615 581 20	120	165	100	90	112	38400	641	157	114	14 x M12	145	6,8

More sizes up to d=600mm for 977,000Nm are available.

Price and delivery time on request.

T = transmittable torque at F<sub>ax</sub> = 0.  
 F<sub>ax</sub> = transmittable axial force at T = 0.  
 P<sub>w</sub> = surface pressure onto the shaft.  
 P<sub>N</sub> = surface pressure onto the hub.  
 T<sub>A</sub> = fastening torque of the screws.

*Hub Calculation and Selection Tool*

*on the Internet at [www.maedler.de](http://www.maedler.de)*

*in the section **MÄDLER®-Tools***

### Fit

Shaft h8, Hub H8.  
 Surface roughness R<sub>z</sub>  
 max. 12.5 µm.

### Mounting

Slightly oil the locking assembly before mounting, do not use molybdenum disulphide or grease. Tighten the screws evenly and crosswise in several steps.

### Demounting

Remove all tensioning screws and screw them into the (usually unused) forcing thread of the front flange, until the flange is released.