



SIGNALLING COLUMN SIREN ELEMENT
CONTINUOUS SOUND , ALTERNATING, 24V
DC,105DB, IP40

Figure similar

General technical data:

product brand name		SIRIUS
Type of voltage of the operating voltage		DC
Operating voltage	V	24
• 1 for DC Rated value		
Type of acoustic signal		Continuous tone / alternating tone
Loudness level	dB	105
Equipment marking acc. to DIN EN 61346-2		P

Mechanical data:

Outer diameter of the signal column element	mm	70
---	----	----

Ambient conditions:

Ambient temperature during operation	°C	-20 ... +50
Protection class IP		IP40
Product function adjustable acoustic signal		No
Height	mm	79
Width	mm	70

Certificates/ approvals:

General Product Approval	EMC	Declaration of Conformity	Shipping Approval
--------------------------	-----	---------------------------	-------------------



Further information

Information- and Downloadcenter (Catalogs, Brochures,...)

<http://www.siemens.com/industrial-controls/catalogs>

Industry Mall (Online ordering system)

<http://www.siemens.com/industrymall>

Cax online generator

<http://support.automation.siemens.com/WW/CAXorder/default.aspx?lang=en&mlfb=8WD44200EA>

Service&Support (Manuals, Certificates, Characteristics, FAQs,...)

<https://support.industry.siemens.com/cs/ww/en/ps/8WD44200EA>

Image database (product images, 2D dimension drawings, 3D models, device circuit diagrams, EPLAN macros, ...)

http://www.automation.siemens.com/bilddb/cax_de.aspx?mlfb=8WD44200EA&lang=en

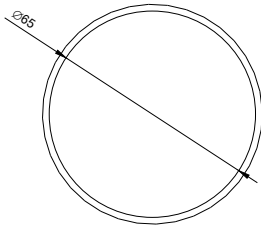
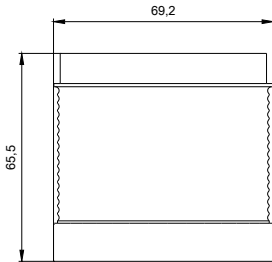

W8444: 8WD44..._ALL

last modified:

15.01.2015