

REV.	DATE	ECR NO.	DESCRIPTION
NC	08/30/04	-	INITIAL RELEASE
A	04/20/08	100006	CHANGED MCX SIDE INTO STANDARD MCX JACK.

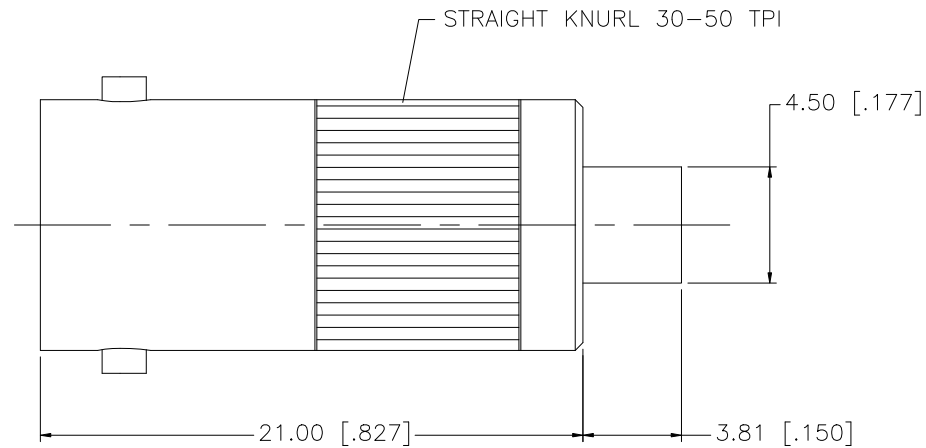

				UNLESS OTHERWISE SPECIFIED DIMENSIONS ARE IN MILLIMETERS. DIMENSIONS IN [] ARE IN INCHES AND FOR CUSTOMER REFERENCE ONLY.	APPROVALS	DATE	Amphenol Connex				
8				UNLESS OTHERWISE SPECIFIED DIMENSIONS ARE IN MILLIMETERS. DIMENSIONS IN [] ARE IN INCHES AND FOR CUSTOMER REFERENCE ONLY. UNLESS OTHERWISE SPECIFIED TOLERANCES FOR MILLIMETERS ARE: 0.5 - 8mm ± 0.20mm 8 - 30mm ± 0.40mm 30 - 120mm ± 0.50mm UNLESS OTHERWISE SPECIFIED TOLERANCES FOR INCHES ARE: .020 - .315 = ± 0.007" .315 - 1.180 = ± 0.015" 1.180 - 4.724 = ± 0.020"	DRAWN	GRS					04/20/08
7					CHECKED			PART NO. 242206			
6					ISSUED						
5					SHEET	1 OF 1		REV. A	SIZE A	SCALE NA	
4											
3	CONTACT PIN	BER. COPPER	GOLD	1	CAD FILE						
2	INSULATOR	PTFE	NATURAL	1	C:/242/242206.DWG						
1	BODY	BRASS	GOLD	1							
	DESCRIPTION	MATERIAL	FINISH	QTY	DO NOT SCALE DRAWING						