

No.M04-446E0
DC JACK FOR P.C.B.
(center pin : 0.65 φ mm)
JSAJ 1 (DC 3.15V Max)

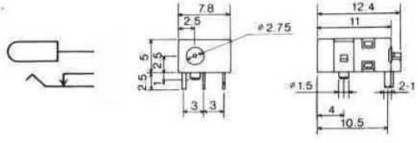

No.M04-700A0
DC JACK FOR P.C.B.
(center hole : 1.05 φ mm)
JSBJ 4 (DC 10.5V ~13.5V)

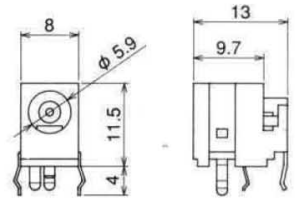
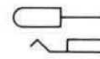

No.M04-477A0
DC JACK FOR P.C.B.
(center pin : 0.65 φ mm)
JSAJ 1 (DC 3.15V Max)

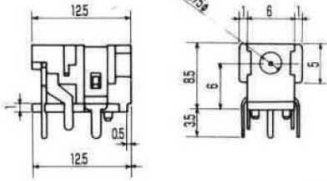
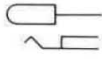

No.M04-390DJ
DC JACK FOR P.C.B.
(center hole : 1.05 φ mm)
JSBJ 4 (DC 10.5V ~13.5V)

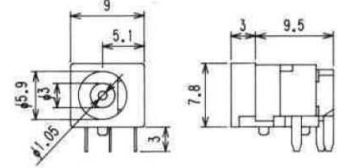
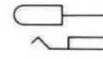

No.M04-595A0
DC JACK FOR P.C.B. (center pin : 0.65 φ mm)
JSAJ 1 (DC 3.15V Max)

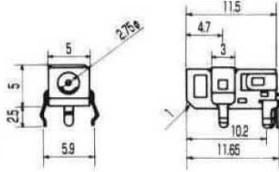
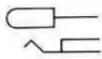

No.M05-532A0
DC JACK FOR P.C.B.
(center hole : 1.45 φ mm)
JSBJ 5 (DC 13.5V ~18V)

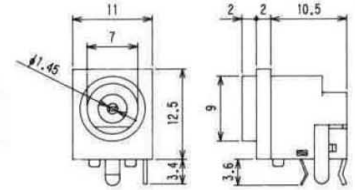

No.M04-339A0
DC JACK FOR P.C.B. (center pin : 1.65 φ mm I.D. : 4.4 φ mm)
JSAJ 2 (DC 3.15V ~6.3V)

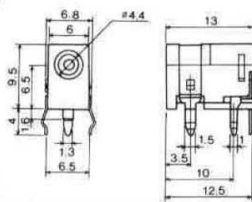
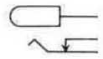

No.M04-730A0
DC JACK FOR P.C.B. (center pin : 1.65 φ mm I.D. : 4.4 φ mm)
JSAJ 2 (DC 3.15V ~6.3V)

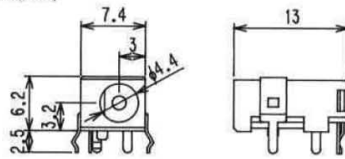

CHASSIS Mtg. DC JACK

No.MJ-10
(center pin : 2 φ mm) Net Weight: 3 gr

No.MJ-11
(center pin : 2.35 φ mm) Net Weight: 3 gr

No.MJ-12
(center pin : 1.65 φ mm I.D. : 4.4 φ mm)
JSAJ 2 (DC 3.15V ~6.3V)

No.MJ-13
(center pin : 1.65 φ mm I.D. : 5.15 φ mm)
JSAJ 3 (DC 6.3V ~10.5V)

No.MJ-19
(center hole : 1.05 φ mm)
JSBJ 4 (DC 10.5V ~13.5V)

No.MJ-20
(center hole : 1.45 φ mm)
JSBJ 5 (DC 13.5V ~18V)

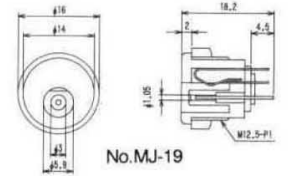
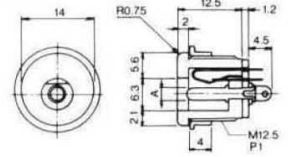

No.MJ-19

No.M04-260DJ
DC JACK FOR P.C.B. (center pin : 1.65 φ mm I.D. : 4.4 φ mm)
JSAJ 2 (DC 3.15V ~6.3V)

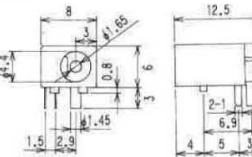
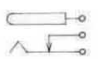

No.M04-440A0
DC JACK FOR P.C.B.
(center pin : 1.65 φ mm I.D. 5.15 φ mm)
JSAJ 3 (DC 6.3V ~10.5V)

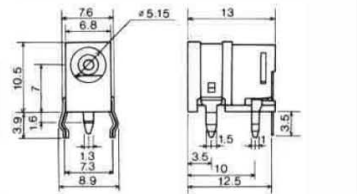

No.M04-533B0
DC JACK FOR P.C.B.
(center pin : 1.65 φ mm I.D. 5.15 φ mm)
JSAJ 3 (DC 6.3V ~10.5V)

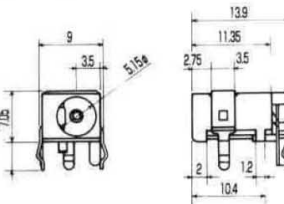
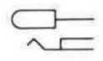

No.M04-754A0
DC JACK FOR P.C.B.
(center pin : 1.65 φ mm I.D. : 5.15 φ mm)
JSAJ 3 (DC 6.3V ~10.5V)

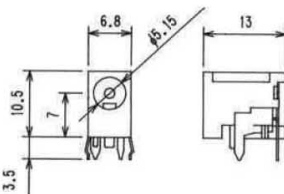

No.MJ-14
(5.5 φ × 2.1 φ mm)

No.MJ-15
(5.5 φ × 2.5 φ mm)

No.MJ-16
(center pin : 0.65 φ mm)
JSAJ 1 (DC 3.15V Max)

No.MJ-17
(center pin : 1.65 φ mm
I.D. : 4.4 φ mm)
JSAJ 2 (DC 3.15V ~6.3V)

No.MJ-18
(center hole : 1.05 φ mm
I.D. : 5.15 φ mm)
JSAJ 3 (DC 6.3V ~10.5V)

No.MJ-99
(center pin : 1.3 φ mm
I.D. : 3.4 φ mm)

No.MJ-99/3.8
(center pin : 1.3 φ mm
I.D. : 3.8 φ mm)

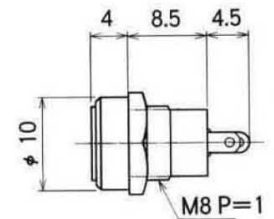

No.MJ-21AM
PANEL MOUNT DC JACK (Center Pin : 2 φ mm)

No.MJ-22AM
PANEL MOUNT DC JACK (Center Pin : 2.35 φ mm)

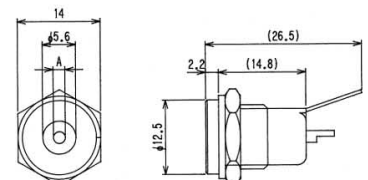

No.MJ-179

PANEL MOUNT DC JACK
(Center Pin : 2.0 mm)
Net Weight : 2 gr.

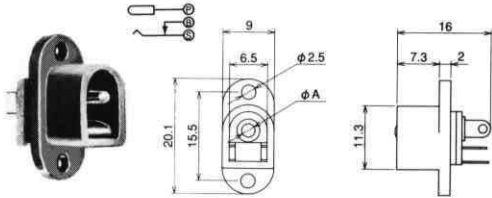
**No.MJ-180**

PANEL MOUNT DC JACK
(Center Pin : 2.35 mm)
Net Weight : 2 gr.

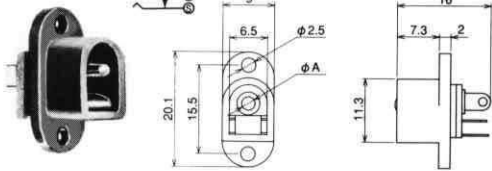
**No.MJ-21**

CHASSIS Mtg.DC JACK
(Center Pin : 2 φ mm)

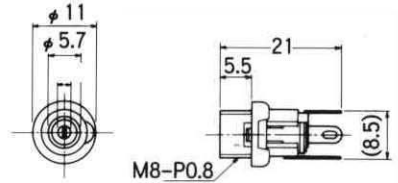
**No.MJ-22**

CHASSIS Mtg.DC JACK
(Center Pin : 2.35 φ mm)

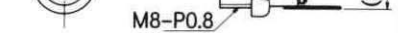
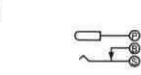
**No.MJ-179P**

DC JACK FOR P.C.
(Center Pin : 2.0 mm)
Net Weight : 1.6 gr.

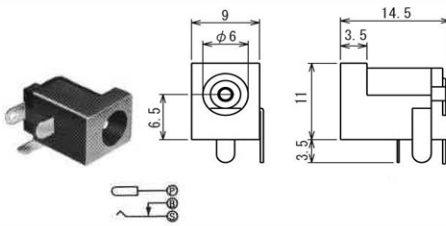
**No.MJ-180P**

DC JACK FOR P.C.
(Center Pin : 2.35 mm)

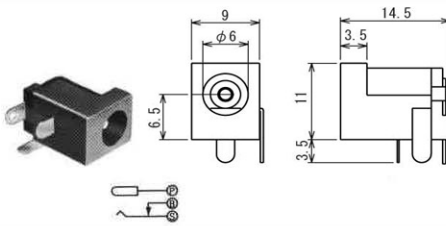
**No.MJ-181M**

(Center Pin : 2 mm)

No.MJ-182M

(Center Pin : 2.35mm)
Net Weight : 2 gr.

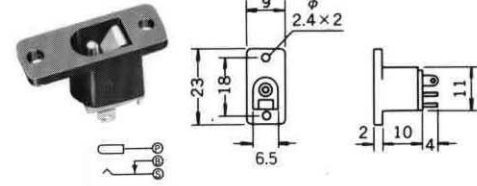
**No.MJ-065M**

DC JACK SCREW TYPE
(Center Pin : 2.95mm)

**No.MJ-196P**

DC JACK INSERT TYPE (Center Pin : 2.0 mm)
FOR P.C.
Net Weight : 1.5 gr.

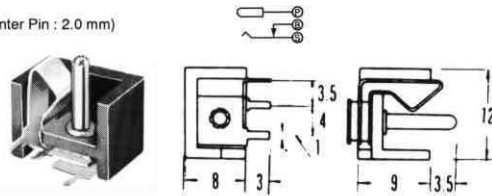
**No.MJ-197P**

DC JACK INSERT TYPE
(Center Pin : 2.35 mm)
FOR P.C.
Net Weight : 1.5 gr.

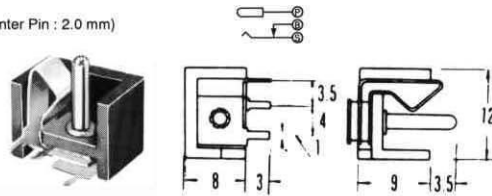
**No.MJ-181MS**

DC JACK SCREW TYPE
(Center Pin : 2mm)
Net Weight : 3 gr.

No.MJ-182MS

DC JACK SCREW TYPE
(Center Pin : 2.35mm)
Net Weight : 3 gr.

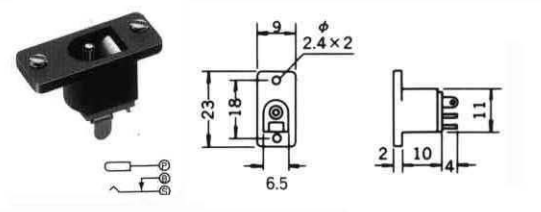
**No.MJ-196**

DC JACK INSERT TYPE
(Center Pin : 2.0 mm)
Net Weight : 2 gr.

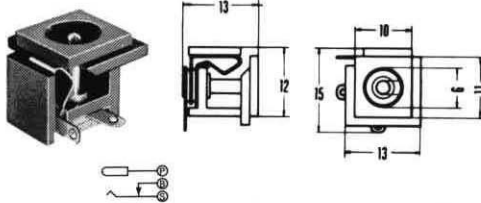
**No.MJ-197**

DC JACK INSERT TYPE
(Center Pin : 2.35 mm)
Net Weight : 2 gr.

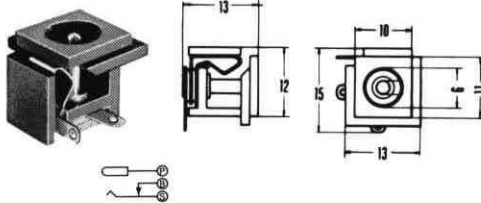
**No.MJ-181**

PANEL MOUNT DC JACK
(Center Pin : 2.0 mm)
Net Weight : 4 gr.

No.MJ-182

PANEL MOUNT DC JACK
(Center Pin : 2.35 mm)
Net Weight : 4 gr.

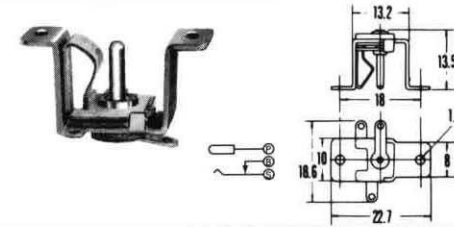
**No.MJ-196E**

DC JACK INSERT TYPE
(Center Pin : 2.0 mm)

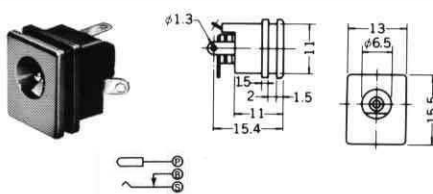
**No.MJ-197E**

DC JACK INSERT TYPE
(Center Pin : 2.35 mm)

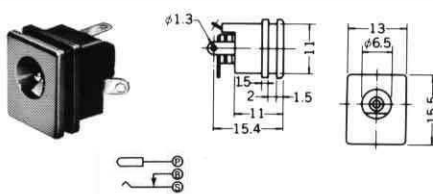
**No.MX-407BLB**

(Center Pin : 1 φ mm)
Net Weight : 1.3 gr.

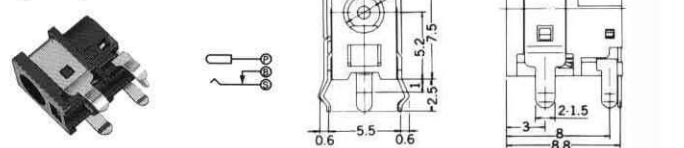
**No.MJ-179LE**

DC JACK
(Center Pin : 2.0 mm)

No.MJ-180LE

DC JACK
(Center Pin : 2.35 mm)

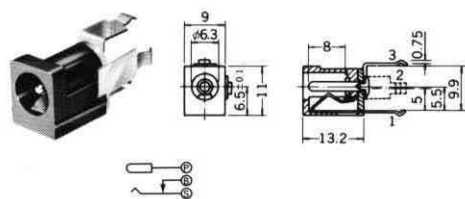
**No.MJ-184WK**

MINIATURE DC JACK
(Center Pin : 1 mm)
Net Weight : 0.5 gr.

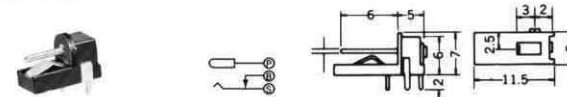
**No.MJD-P6**

(Center Pin : 2.0mm)
Net Weight : 2 gr.

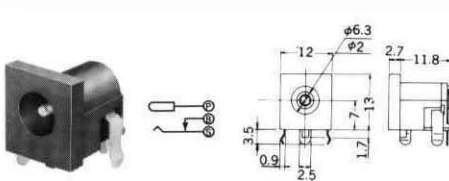
**No.MJ-83**

(Center Pin : 1.3mm)

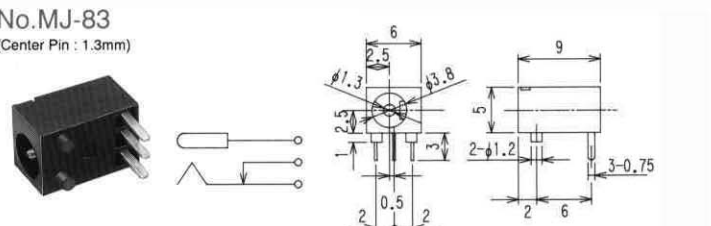
**No.MJ-25N**

Miniature DC JACK(Center Pin : 1 φ mm)

No.MJ-25N1

Miniature DC JACK(Center Pin : 1.3 φ mm)

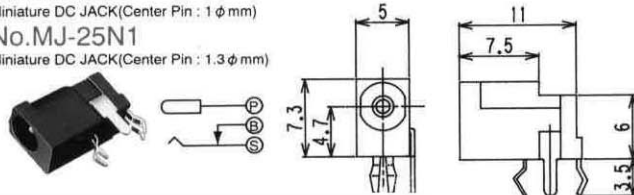
**No.MJ-82-1**

(Center Pin : 1.3mm)
Net Weight : 1.5 gr.

No.MJ-82-2

(Center Pin : 1 mm)
Net Weight : 1.5 gr.

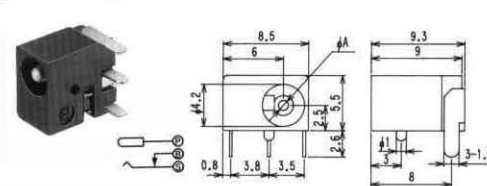
**No.MX-408BL**

(Center Pin : 2.0mm)

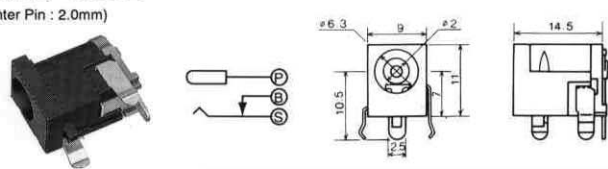
**No.MJX-1**

DC JACK 2 PIN TYPE FOR P.C.B.

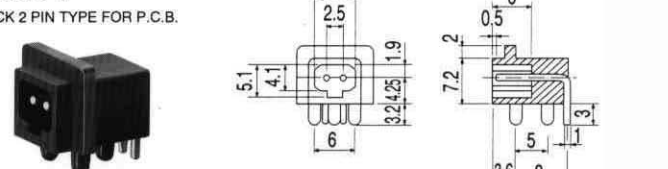

DC EXTENTION CABLE

L=1800mm



Available Product Line

| MODEL No. | JACK TYPE (mm) | RATING |
|-----------|-----------------------------------|---------------|
| MC-2376 | $\phi 5.5 \times \phi 2.1$ | 12.0V DC 0.5A |
| MC-2377 | $\phi 5.5 \times \phi 2.5$ | 12.0V DC 0.5A |
| MC-5326 | $\phi 2.35 \times \phi 0.7$ JSAJ1 | 3.15V DC 2A |
| MC-5327 | $\phi 4.0 \times \phi 1.7$ JSAJ2 | 6.3V DC 2A |
| MC-5328 | $\phi 4.75 \times \phi 1.7$ JSAJ3 | 10.5V DC 2A |

DC INLINE JACK FOR MOLDING

No.MJ-23

($5.5 \phi \times 2.1 \phi$ mm)

No.MJ-24

($5.5 \phi \times 2.5 \phi$ mm)

No.MJ-28

(center pin : 1.65ϕ mm I.D. : 4.4ϕ mm)
JSAJ 2 (DC 3.15V~6.3V)

No.MJ-29

(center pin : 1.65ϕ mm I.D. : 5.15ϕ mm)
JSAJ 3 (DC 6.3V~10.5V)

