

E21095

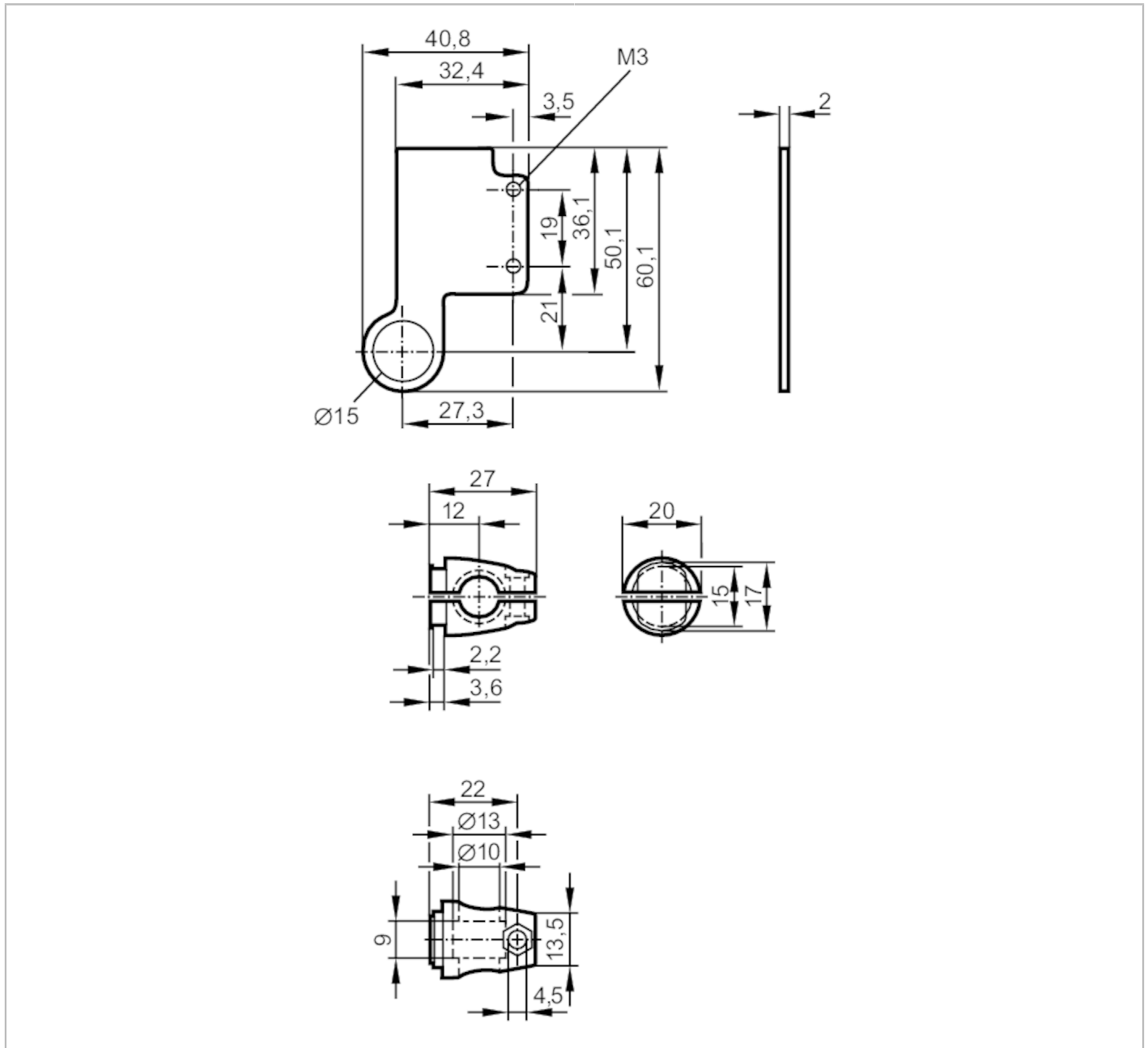

Mounting set for photoelectric sensors

SYSTEM COMPONENT OJ ROD



| Application | |
|------------------------|--|
| Design | for side lens |
| Mechanical data | |
| Weight [g] | 60.2 |
| Type of mounting | Mounting rod; (Ø 10 mm) |
| Materials | Clamp: diecast zinc; fixture: stainless steel (1.4571/316Ti) |
| Accessories | |
| Accessories (supplied) | screw: 1 x M4 x 12 nut: 1 x M4 |
| Remarks | |
| Pack quantity | 1 pcs. |