

METAL ENCLOSURE TO EN50041 W. INCREASED CORROSION PROTECTION

Product designation		Housing EKS, EN50041 for standard position switch + cover, turquoise
---------------------	--	--

**General technical data:**

<b>Product function</b>		
• positive opening		Yes
<b>Insulation voltage</b>		
• Rated value	V	400
<b>Degree of pollution</b>		class 3
<b>Shock resistance</b>		30g / 11 ms
<b>Vibration resistance</b>		0.35 mm / 5g
<b>Protection class IP</b>		IP66/IP67
<b>Equipment marking</b>		
• acc. to DIN EN 61346-2		U
• acc. to DIN EN 81346-2		U
<b>Active principle</b>		mechanical
<b>Repeat accuracy</b>	mm	0.05
Explosion protection category for dust		none
Explosion protection category for gas		none

**Enclosure:**

<b>Design of the housing</b>		block, narrow
<b>Material of the enclosure</b>		metal
<b>Coating of the enclosure</b>		cathodic immersion coating
<b>Design of the housing acc. to standard</b>		Yes

**Drive Head:**

<b>Design of the operating mechanism</b>		without
--	--	---------

**Mechanical data:**

<b>Cable entry type</b>	1x (M20 x 1.5)
-------------------------	----------------

**Communication/ Protocol:**

<b>Design of the interface</b>	without
--------------------------------	---------

**Ambient conditions:**

<b>Ambient temperature</b>		
• during operation	°C	-25 ... +85
• during storage	°C	-40 ... +90

**Installation/ mounting/ dimensions:**

<b>mounting position</b>	any
<b>Mounting type</b>	screw fixing

**Certificates/ approvals:**

General Product Approval			Declaration of Conformity	Test Certificates
				
CCC	CSA	UL	EG-Konf.	<a href="#">Special Test Certificate</a>

**other**[Confirmation](#)**Further information****Information- and Downloadcenter (Catalogs, Brochures,...)**<http://www.siemens.com/industrial-controls/catalogs>**Industry Mall (Online ordering system)**<http://www.siemens.com/industrymall>**Cax online generator**<http://support.automation.siemens.com/WW/CAXorder/default.aspx?lang=en&mfb=3SE51120AA001CA0>**Service&Support (Manuals, Certificates, Characteristics, FAQs,...)**<http://support.automation.siemens.com/WW/view/en/3SE51120AA001CA0/all>**Image database (product images, 2D dimension drawings, 3D models, device circuit diagrams, EPLAN macros, ...)**[http://www.automation.siemens.com/bilddb/cax\\_de.aspx?mfb=3SE51120AA001CA0&lang=en](http://www.automation.siemens.com/bilddb/cax_de.aspx?mfb=3SE51120AA001CA0&lang=en)

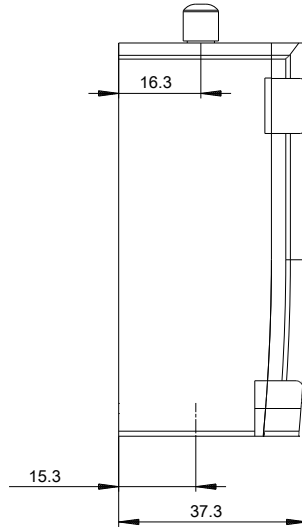
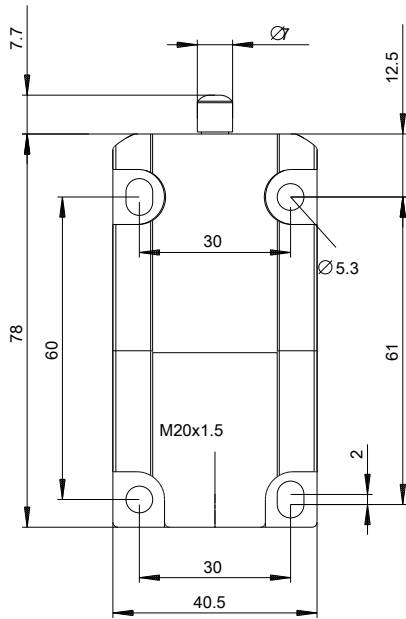

last modified:

16.03.2015