

DE-112

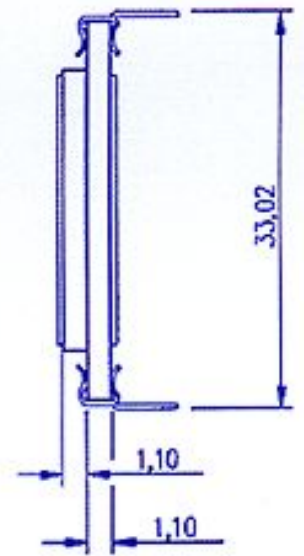
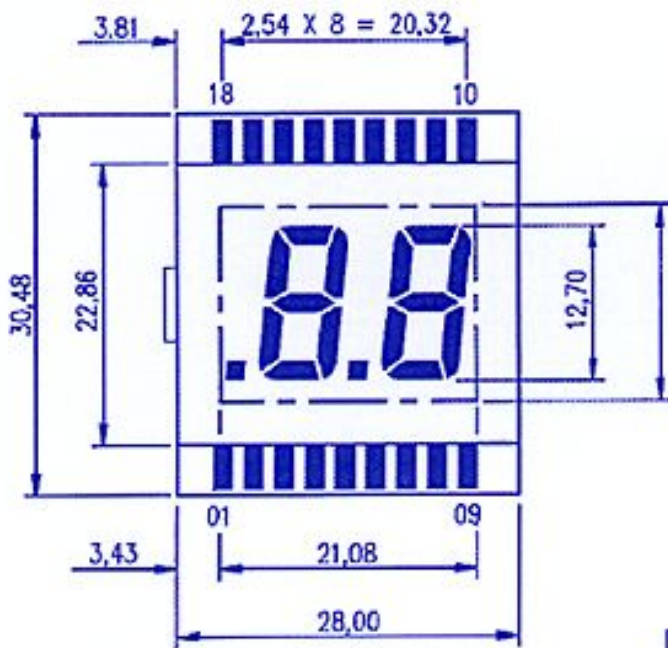

Driving-IC:
OKI MSM58292, HD61603

| SEG. | BP | DP1 | 1E | 1D | 1C | DP2 | 2E | 2D | 2C | 2B | 2A | 2F | 2G | 1B | 1A | 1F | 1G | BP |
|------|----|-----|----|----|----|-----|----|----|----|----|----|----|----|----|----|----|----|----|
| PIN# | 1 | 2 | 3 | 4 | 5 | 6 | 7 | 8 | 9 | 10 | 11 | 12 | 13 | 14 | 15 | 16 | 17 | 18 |

[LCD - Specification](#)

[back](#)

LCD - Specification

DISPLAY is specialized on LCD - Products. We manufacture:

- Standard LCD's
- Custom designed LCD's
- LC - Modules (digital, alphanumeric, graphic)
- LC - custom designed modules
- upon request TN, HTN, STN, FSTN - technologies
- Component for LCD's like backlight components (LED, EL panels), connectors, elastometers (zebra connectors) etc.

Electrical and physical properties of LCD'S

| At an ambient temperature of 25°C | Standard temperature | | | Extended temperature | | | Wide temperature | | | Unit |
|---|----------------------|------|------|----------------------|------|------|------------------|------|------|--------|
| | min. | typ. | max. | min. | typ. | max. | min. | typ. | max. | |
| Operating voltage | | 3 | | | 3 | | | 5 | | V |
| Driving frequency | 30 | 32 | 100 | 30 | 32 | 100 | 30 | 32 | 100 | Hz |
| Current consumption | | 1,0 | 2,0 | | 1,0 | 2,0 | | 1,0 | 2,0 | µA/cm² |
| DC-voltage allowance | | | 50 | | | 50 | | | 50 | mV |
| Response time (t _{on} + t _{off}) | | 440 | | | 440 | | | | 450 | ms |
| Operating temperature | -10 | | 60 | -20 | | 70 | -40 | | 90 | °C |
| Storage temperature | -20 | | 65 | -40 | | 90 | -40 | | 90 | °C |
| Lifetime | 100 000 | | | | | | | | | h |

ORDERING INFORMATION

model DE - □ □ □ - □ □ □ / □

- reflective = R
- transflective = T
- transmissive = M
- standard polarizer = S
- highstable polarizer = U

- Pinlength (mm)
- 0 = fixed pins
- 1 = for elastomer (zebra)
- 1 = standard temperature
- 2 = extended temperature
- 3 = wide temperature

Example:

DE-113-RS-10/7,5
 LCD 3½ digits
 Digit height 12.7 mm
 Reflective
 Standard polarizer
 Standard temperature
 Fixed pins
 Pinlength 7.5 mm

[back](#)