

Eco-Modul 60 Signal tower



Modular

- Ø 60 mm modular signal tower series
- Complete range of high-luminosity LED light modules with steady/flashing/strobe beacon functions, 6 different lens colours
- High-performance steady and multi-strobe beacon modules
- Alternatively operated with conventional incandescent bulb technology
- Piezo buzzer module available with steady/pulsing tone
- Pre-assembled towers or individual tower modules available for configuration
- Extensive range of mounting types
- User-friendly connection technology
- PLC-suitable
- High degree of protection IP66, UL type 4/4X/13



TECHNICAL DATA

| | |
|----------------------------|--|
| Housing | Ø 60 mm, Polycarbonate black |
| Lens | Polycarbonate, ribbed inside orange, red, clear, blue, green or yellow |
| Type of mounting | any |
| Connection technology | up to 2,5mm ² / 14 AWG |
| Leakage current | > 0,003 A (PLC-suitable) |
| Beacon type | LED steady beacon, LED flashing beacon, LED strobe beacon, HP LED steady beacon, HP LED multi strobe beacon or Steady beacon (incandescent bulb) |
| Light source | 8 LEDs, 2 high-power LEDs, incandescent bulb |
| Strobe/flash frequency | Flashing beacon 2 Hz, strobe beacon 1.4 Hz, multi strobe beacon 1-2.6 Hz |
| Tone | Steady tone or Pulsing tone |
| Volume | 90 dB |
| Tone frequency | 2.500 Hz |
| Duty cycle | 100 % |
| Service life | Light source: LED 100,000 hours, HP LED 50,000 hours |
| Number of possible modules | max. 5, with double bracket max. 10 |
| Operating temperature | -30 °C / +60 °C |
| Degree of protection | IP66 & UL Type 4/4X/13 |
| Weight (modules) | 63-83 g |



Eco-Modul 60 Pre-configured Signal towers



Order number: ECO60-Q01
Colours: red/orange/green
Function: LED steady beacon
Nominal voltage: 24 V AC/DC
Type of mounting: Tube mounting
 (100 mm tube length)



Order number: ECO60-Q02
Colours: red/green
Function: LED steady beacon
Nominal voltage: 24 V AC/DC
Type of mounting: Tube mounting
 (100 mm tube length)



Order number: ECO60-Q05
Colours: red/orange/green/blue
Function: LED steady beacon
Nominal voltage: 24 V AC/DC
Type of mounting: Tube mounting
 (100 mm tube length)



Order number: ECO60-Q31
Colours: red/orange/green
Function: LED steady beacon, buzzer
 steady or pulsing tone
Nominal voltage: 24 V AC/DC
Type of mounting: Tube mounting
 (100 mm tube length)



Order number: ECO60-Q81
Colours: red/orange/green
Function: LED steady beacon, buzzer
 steady or pulsing tone
Nominal voltage: 230 V AC
Type of mounting: Tube mounting
 (100 mm tube length)

Eco-Modul 60



Modular

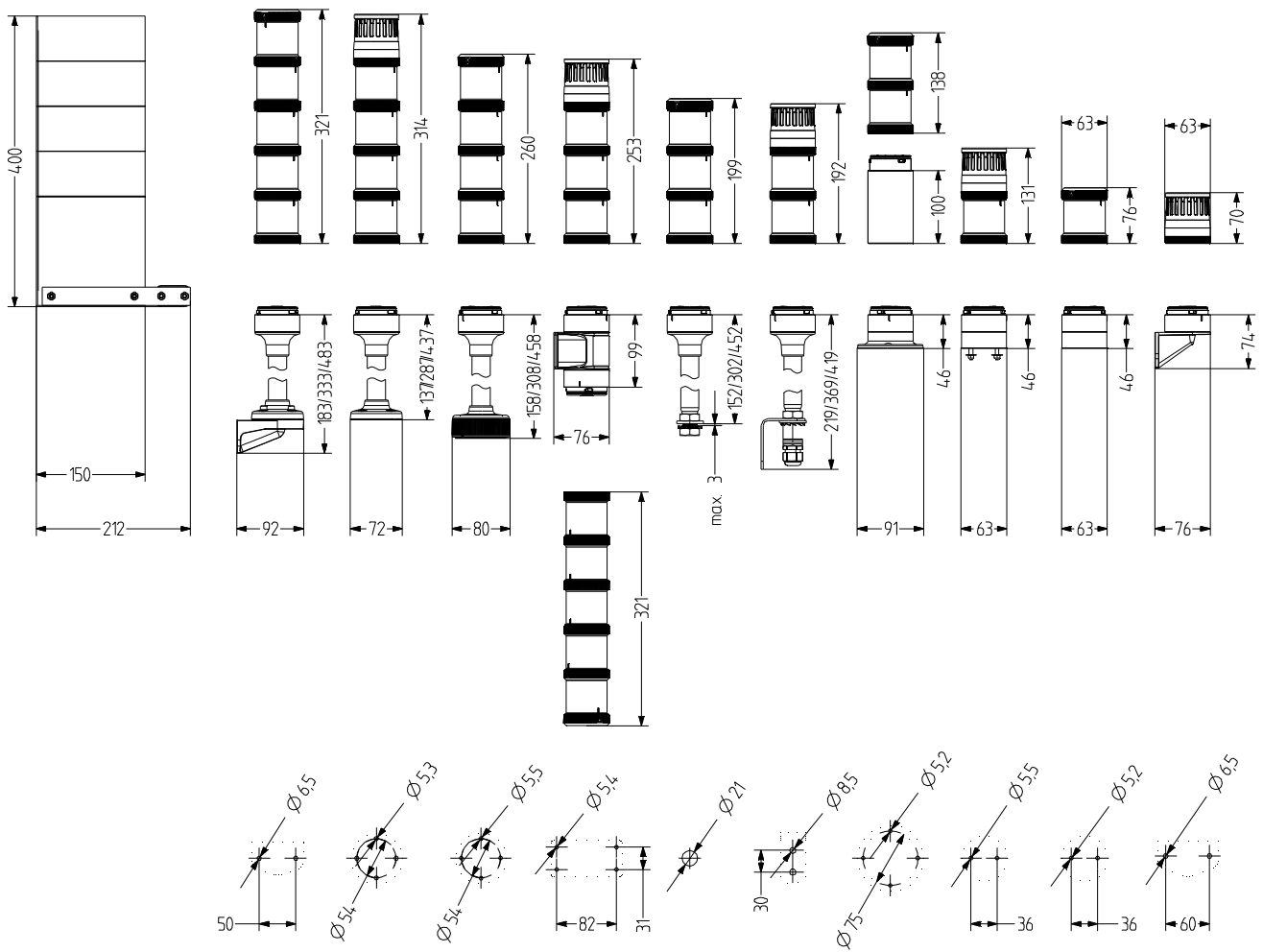

Eco-Modul 60

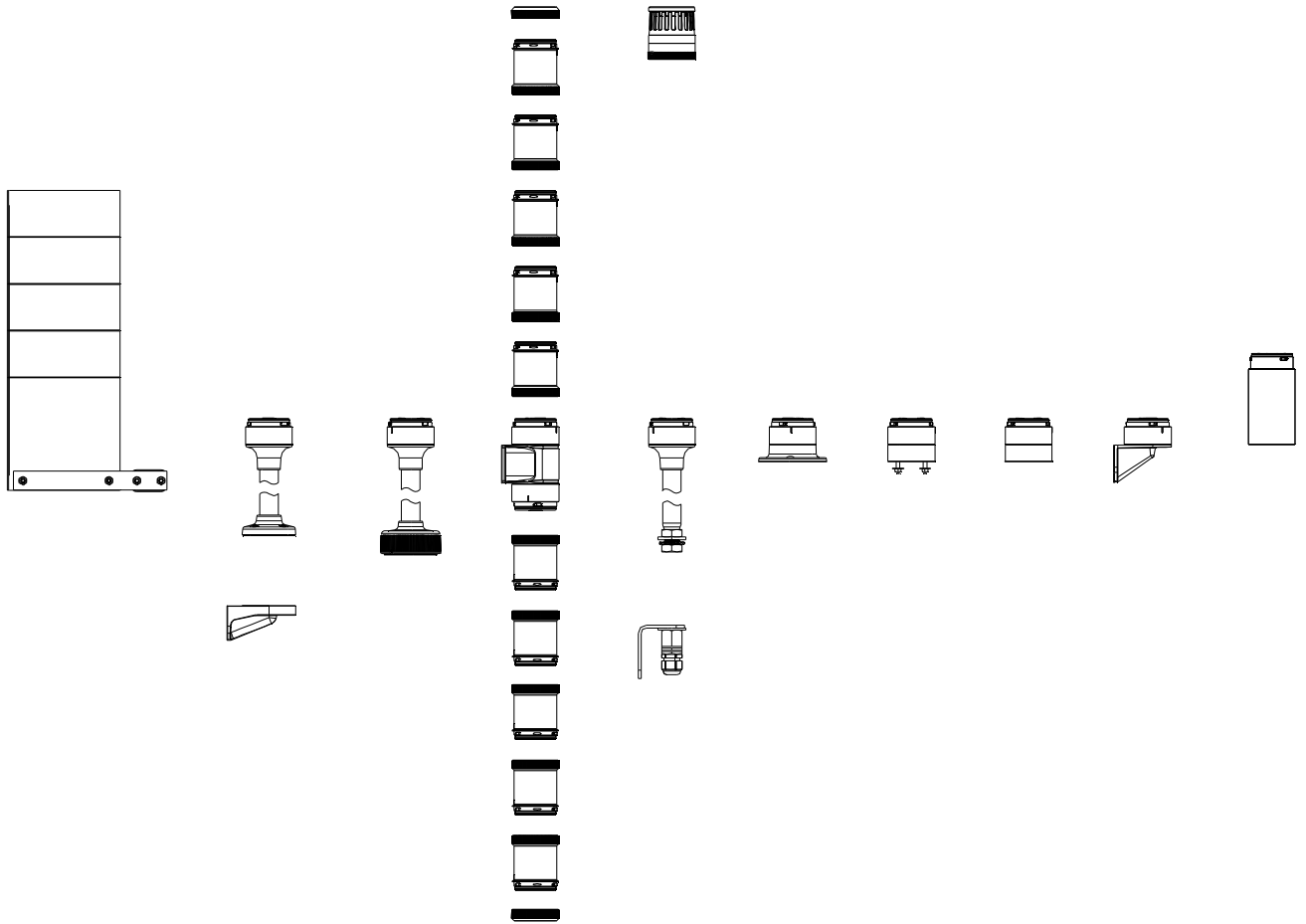

Eco-Modul 60

VISUAL MODULES

| Type | Beacon type | Lens colour | Nominal voltage | Voltage range (V) | Nominal current (A) | Order number | Item Nr. | | |
|--------------|---------------------|-------------|-------------------|-------------------|---------------------|--------------|-------------|-------------|-------------|
| YLL | Steady beacon | orange | 12-250 V AC/DC | | 4 W | 901 001 900 | 901 001 900 | | |
| | | red | 12-250 V AC/DC | | 4 W | 901 002 900 | 901 002 900 | | |
| | | clear | 12-250 V AC/DC | | 4 W | 901 004 900 | 901 004 900 | | |
| | | blue | 12-250 V AC/DC | | 4 W | 901 005 900 | 901 005 900 | | |
| | | green | 12-250 V AC/DC | | 4 W | 901 006 900 | 901 006 900 | | |
| | | yellow | 12-250 V AC/DC | | 4 W | 901 007 900 | 901 007 900 | | |
| | | YDC | LED steady beacon | orange | 24 V AC/DC | +/- 10 % | 0,022-0,033 | 901 011 405 | 901 011 405 |
| 110-120 V AC | +/- 10 % | | | | 0,029-0,090 | 901 011 310 | 901 011 310 | | |
| 230-240 V AC | +/- 10 % | | | | 0,029-0,090 | 901 011 313 | 901 011 313 | | |
| red | 24 V AC/DC | | | +/- 10 % | 0,022-0,033 | 901 012 405 | 901 012 405 | | |
| | 110-120 V AC | | | +/- 10 % | 0,029-0,090 | 901 012 310 | 901 012 310 | | |
| | 230-240 V AC | | | +/- 10 % | 0,029-0,090 | 901 012 313 | 901 012 313 | | |
| clear | 24 V AC/DC | | | +/- 10 % | 0,022-0,033 | 901 014 405 | 901 014 405 | | |
| | 110-120 V AC | | | +/- 10 % | 0,029-0,090 | 901 014 310 | 901 014 310 | | |
| | 230-240 V AC | | | +/- 10 % | 0,029-0,090 | 901 014 313 | 901 014 313 | | |
| blue | 24 V AC/DC | | | +/- 10 % | 0,022-0,033 | 901 015 405 | 901 015 405 | | |
| | 110-120 V AC | | | +/- 10 % | 0,029-0,090 | 901 015 310 | 901 015 310 | | |
| | 230-240 V AC | | | +/- 10 % | 0,029-0,090 | 901 015 313 | 901 015 313 | | |
| green | 24 V AC/DC | | | +/- 10 % | 0,022-0,033 | 901 016 405 | 901 016 405 | | |
| | 110-120 V AC | | | +/- 10 % | 0,029-0,090 | 901 016 310 | 901 016 310 | | |
| | 230-240 V AC | | | +/- 10 % | 0,029-0,090 | 901 016 313 | 901 016 313 | | |
| yellow | 24 V AC/DC | | | +/- 10 % | 0,022-0,033 | 901 017 405 | 901 017 405 | | |
| | 110-120 V AC | | | +/- 10 % | 0,029-0,090 | 901 017 310 | 901 017 310 | | |
| | 230-240 V AC | | | +/- 10 % | 0,029-0,090 | 901 017 313 | 901 017 313 | | |
| YDA | LED flashing beacon | | | orange | 24 V AC/DC | +/- 10 % | 0,028-0,036 | 901 021 405 | 901 021 405 |
| | | | | | 110-120 V AC | +/- 10 % | 0,030 | 901 021 310 | 901 021 310 |
| | | | | | 230-240 V AC | +/- 10 % | 0,030 | 901 021 313 | 901 021 313 |
| | | | | red | 24 V AC/DC | +/- 10 % | 0,028-0,036 | 901 022 405 | 901 022 405 |
| | | | | | 110-120 V AC | +/- 10 % | 0,030 | 901 022 310 | 901 022 310 |
| | | | | | 230-240 V AC | +/- 10 % | 0,030 | 901 022 313 | 901 022 313 |
| | | | | clear | 24 V AC/DC | +/- 10 % | 0,028-0,036 | 901 024 405 | 901 024 405 |
| | | | | | 110-120 V AC | +/- 10 % | 0,030 | 901 024 310 | 901 024 310 |
| | | | | | 230-240 V AC | +/- 10 % | 0,030 | 901 024 313 | 901 024 313 |
| | | blue | 24 V AC/DC | +/- 10 % | 0,028-0,036 | 901 025 405 | 901 025 405 | | |
| | | | 110-120 V AC | +/- 10 % | 0,030 | 901 025 310 | 901 025 310 | | |
| | | | 230-240 V AC | +/- 10 % | 0,030 | 901 025 313 | 901 025 313 | | |
| | | green | 24 V AC/DC | +/- 10 % | 0,028-0,036 | 901 026 405 | 901 026 405 | | |
| | | | 110-120 V AC | +/- 10 % | 0,030 | 901 026 310 | 901 026 310 | | |
| | | | 230-240 V AC | +/- 10 % | 0,030 | 901 026 313 | 901 026 313 | | |
| | | yellow | 24 V AC/DC | +/- 10 % | 0,028-0,036 | 901 027 405 | 901 027 405 | | |
| | | | 110-120 V AC | +/- 10 % | 0,030 | 901 027 310 | 901 027 310 | | |
| | | | 230-240 V AC | +/- 10 % | 0,030 | 901 027 313 | 901 027 313 | | |



Modular

Eco-Modul 60

VISUAL MODULES

| Type | Beacon type | Lens colour | Nominal voltage | Voltage range [V] | Nominal current [A] | Order number | Item Nr. | | |
|--------|-------------------------|-------------|-------------------|--------------------------|---------------------|--------------------------|-------------|-------------|-------------|
| YDF | LED strobe beacon | orange | 24 V AC/DC | +/- 10 % | 0,035-0,065 | 901 031 405 | 901 031 405 | | |
| | | | 110-120 V AC | +/- 10 % | 0,010 | 901 031 310 | 901 031 310 | | |
| | | | 230-240 V AC | +/- 10 % | 0,010 | 901 031 313 | 901 031 313 | | |
| | | red | 24 V AC/DC | +/- 10 % | 0,035-0,065 | 901 032 405 | 901 032 405 | | |
| | | | 110-120 V AC | +/- 10 % | 0,010 | 901 032 310 | 901 032 310 | | |
| | | | 230-240 V AC | +/- 10 % | 0,010 | 901 032 313 | 901 032 313 | | |
| | | clear | 24 V AC/DC | +/- 10 % | 0,035-0,065 | 901 034 405 | 901 034 405 | | |
| | | | 110-120 V AC | +/- 10 % | 0,010 | 901 034 310 | 901 034 310 | | |
| | | | 230-240 V AC | +/- 10 % | 0,010 | 901 034 313 | 901 034 313 | | |
| | | blue | 24 V AC/DC | +/- 10 % | 0,035-0,065 | 901 035 405 | 901 035 405 | | |
| | | | 110-120 V AC | +/- 10 % | 0,010 | 901 035 310 | 901 035 310 | | |
| | | | 230-240 V AC | +/- 10 % | 0,010 | 901 035 313 | 901 035 313 | | |
| | | green | 24 V AC/DC | +/- 10 % | 0,035-0,065 | 901 036 405 | 901 036 405 | | |
| | | | 110-120 V AC | +/- 10 % | 0,010 | 901 036 310 | 901 036 310 | | |
| | | | 230-240 V AC | +/- 10 % | 0,010 | 901 036 313 | 901 036 313 | | |
| | | yellow | 24 V AC/DC | +/- 10 % | 0,035-0,065 | 901 037 405 | 901 037 405 | | |
| | | | 110-120 V AC | +/- 10 % | 0,010 | 901 037 310 | 901 037 310 | | |
| | | | 230-240 V AC | +/- 10 % | 0,010 | 901 037 313 | 901 037 313 | | |
| | | YDC-HP | LED steady beacon | orange | 24 V AC/DC | 18-26 V AC 18-30 V DC | 0,130-0,150 | 901 051 405 | 901 051 405 |
| | | | | red | 24 V AC/DC | 18-26 V AC 18-30 V DC | 0,130-0,150 | 901 052 405 | 901 052 405 |
| | | | | clear | 24 V AC/DC | 18-26 V AC 18-30 V DC | 0,130-0,150 | 901 054 405 | 901 054 405 |
| | | | | blue | 24 V AC/DC | 18-26 V AC 18-30 V DC | 0,130-0,150 | 901 055 405 | 901 055 405 |
| | | | | green | 24 V AC/DC | 18-26 V AC 18-30 V DC | 0,130-0,150 | 901 056 405 | 901 056 405 |
| | | | | yellow | 24 V AC/DC | 18-26 V AC 18-30 V DC | 0,130-0,150 | 901 057 405 | 901 057 405 |
| YFF-HP | LED multi strobe beacon | | | orange | 24 V AC/DC | 18-26 V AC 18-30 V DC | 0,190-0,250 | 901 071 405 | 901 071 405 |
| | | red | 24 V AC/DC | 18-26 V AC 18-30 V DC | 0,190-0,250 | 901 072 405 | 901 072 405 | | |
| | | clear | 24 V AC/DC | 18-26 V AC 18-30 V DC | 0,190-0,250 | 901 074 405 | 901 074 405 | | |
| | | blue | 24 V AC/DC | 18-26 V AC 18-30 V DC | 0,190-0,250 | 901 075 405 | 901 075 405 | | |
| | | green | 24 V AC/DC | 18-26 V AC 18-30 V DC | 0,190-0,250 | 901 076 405 | 901 076 405 | | |
| | | yellow | 24 V AC/DC | 18-26 V AC 18-30 V DC | 0,190-0,250 | 901 077 405 | 901 077 405 | | |
| | | | | | | | | | |

Eco-Modul 60

AUDIBLE MODULES

| Type | Tone | Volume | Nominal voltage | Voltage range (V) | Nominal current (A) | Order number |
|------|--|--------|-----------------|-------------------|---------------------|--------------|
| YDE | Piezo buzzer module steady tone/pulsing tone | 90 dB | 24 V AC/DC | +/- 10 % | 0,065 | 901 500 405 |
| | | | 110-120 V AC | +/- 10 % | 0,031 | 901 500 310 |
| | | | 230-240 V AC | +/- 10 % | 0,032 | 901 500 313 |

ORDER DATA - BASE

| Type | Type of accessory | Tube length | Order number |
|------|---|-------------|--------------|
| YMW | Base for horizontal mounting M20, inside mounting holes | | 901 570 900 |
| YMS | Base for horizontal mounting with pre-mounted fixing screws | | 901 571 900 |
| YMF | Base for horizontal mounting with external mounting holes | | 901 572 900 |
| YMC | Base for horizontal mounting with external mounting holes and integrated 5-pole M12 connector | | 901 572 911 |
| YMV | Base for vertical mounting for single-sided mounting | | 901 573 900 |
| YZV | Base for vertical mounting for double-sided mounting | | 901 574 900 |
| YMR | Tube base 100 mm on aluminium tube with plastic foot | 100 mm | 901 582 900 |
| | Tube base 250 mm on aluminium tube with plastic foot | 250 mm | 901 583 900 |
| | Tube base 400 mm on aluminium tube with plastic foot | 400 mm | 901 584 900 |
| YNW | Tube base NPT 1/2" thread | | 901 570 950 |
| YSW | Tube base 100 mm on aluminium tube for horizontal mounting with banjo bolt | 100 mm | 901 592 900 |
| | Tube base 250 mm on aluminium tube for horizontal mounting with banjo bolt | 250 mm | 901 593 900 |
| | Tube base 400 mm on aluminium tube for horizontal mounting with banjo bolt | 400 mm | 901 594 900 |
| YFR | Quick mounting system 'foot adapter' 100 mm on aluminium tube with foot adapter | | 901 562 900 |
| | Quick mounting system 'foot adapter' 250 mm on aluminium tube with foot adapter | | 901 563 900 |
| | Quick mounting system 'foot adapter' 400 mm on aluminium tube with foot adapter | | 901 564 900 |



XWR



XSS



XIB



YEP

ACCESSORIES

| Type | Type of accessory | Weight | Order number |
|------|--|--------|--------------|
| XWR | Bracket for vertical mounting of TMR/UMR tube base | 95 g | 900 600 900 |
| XSS | Set Set for vertical mounting (bracket, cable gland) | 135 g | 900 700 900 |
| XIB | Identification plate | 235 g | 900 850 900 |
| WYC | Metal bracket for YMC | | 901 573 910 |
| YEP | Base extension 100 mm long, suitable for all bases | | 901 800 900 |



Modular