

# Precision IC-Socket 2,54 mm

Series

001

pitch  
2,54



mating pin size  
 ⌀ 0,40-0,56  
 □ 0,25x0,45  
 max. pincount  
**064**

Rated current	3,0 A
Rated voltage	150 VRMS / Vdc
Withstand voltage	1000 VRMS for one minute
Material contact	Copper alloy
Material clip	BeCu
Material insulator	High temp. thermoplast UL94V-0
Operating temperature	-55°C to +125°C
Max. soldering temper.	260°C for 10 seconds

All dimensions in mm.

## Variation

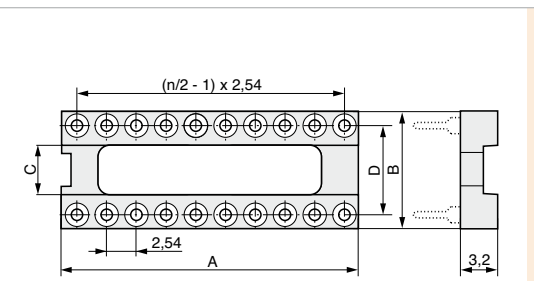

1

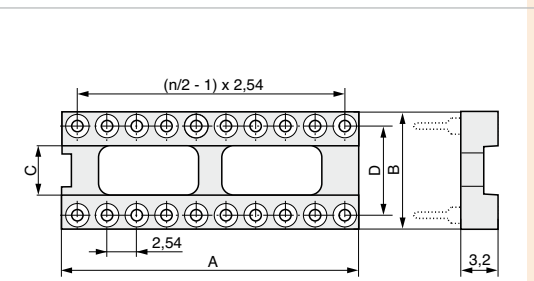

2

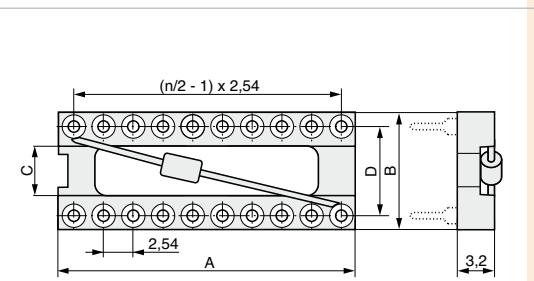

3

Capacity 100 nF

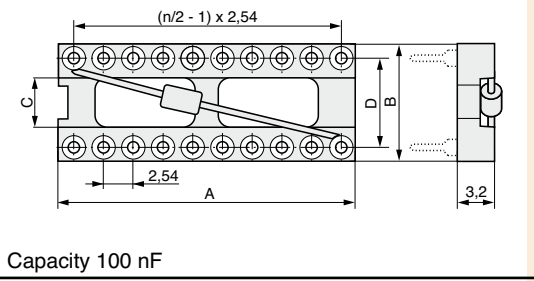

4

Capacity 100 nF

Clip style: S = 4 finger clip  
 Plating: T = Sn, F = Au, H = Au 0,75 μ  
 Packaging: T = Tube

## Contact type (for details please see page 22-23)

<b>B1</b>	
<b>B2</b>	
<b>B3</b>	
<b>F1</b>	
<b>F2</b>	
<b>F3</b>	
<b>F4</b>	
<b>F5</b>	
<b>F6</b>	
<b>F7</b>	
<b>F9</b>	
<b>G1</b>	
<b>G2</b>	
<b>G3</b>	
<b>G4</b>	
<b>G5</b>	
<b>T1</b>	
<b>T2</b>	
<b>T3</b>	

no. of contacts	row distance (code)	row distance (mm)	see figure left	see figure left	see figure left	available in variation
n	D	A	B	C		
004	3	7,62	5,00	10,10	4,40	1
006	3	7,62	7,60	10,10	4,40	1
008	3	7,62	10,10	10,10	4,40	1 3
010	2	5,08	12,60	7,60	-	1
010	3	7,62	12,60	10,10	4,40	1
012	3	7,62	15,20	10,10	4,40	1
014	3	7,62	17,70	10,10	4,40	1 3
016	3	7,62	20,30	10,10	4,40	1 3
018	3	7,62	22,80	10,10	4,40	1 2 3 4
020	3	7,62	25,30	10,10	4,40	1 2 3 4
020	4	10,16	25,40	12,60	6,50	2
022	3	7,62	27,80	10,10	4,40	1 2
022	4	10,16	27,80	12,60	6,50	2
024	3	7,62	30,40	10,10	4,40	1 2 3 4
024	4	10,16	30,40	12,60	6,50	2
024	6	15,24	30,40	17,70	10,60	1 2 3 4
028	3	7,62	35,50	10,10	4,40	2
028	4	10,16	35,50	12,60	6,50	2
028	6	15,24	35,50	17,70	10,60	1 2 3 4
032	4	10,16	40,60	12,60	6,50	2
032	6	15,24	40,60	17,70	10,60	1 2 3 4
036	6	15,24	45,70	17,70	10,60	2
040	6	15,24	50,80	17,70	10,60	1 2 3 4
048	6	15,24	60,90	17,70	10,60	1 2
050	9	22,86	63,50	25,30	17,70	2
064	9	22,86	81,20	25,30	17,70	2

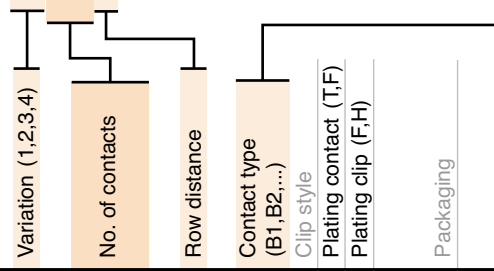

Order code:

001 - - 2222 - 2 - 22 S 22 - XT0

Mating series	033																		
see page	2-2																		



www.mpe-connector.de

MPE-Garry GmbH • Schäfflerstraße 13 • 87629 Füssen • Germany • Phone: +49 (0) 83 62 / 91 56-0 • Fax: +49 (0) 83 62 / 91 56-500 • Email: vk@mpe-connector.de • www.mpe-connector.de

Product group  
**1**

# Contact Type

Product group  
**1**

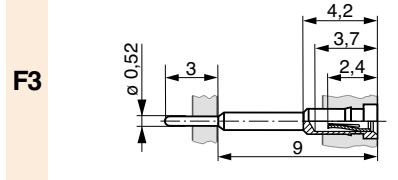
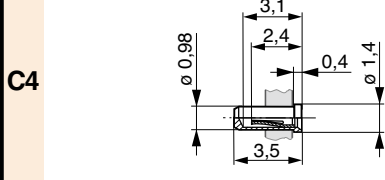
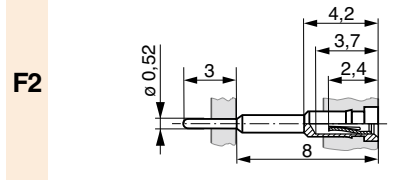
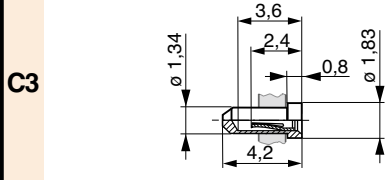
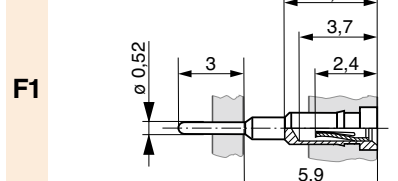
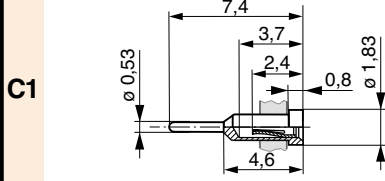
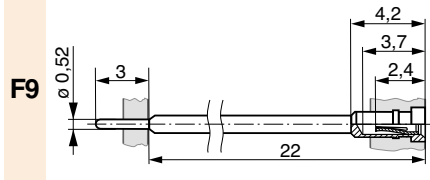
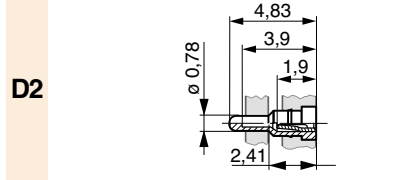
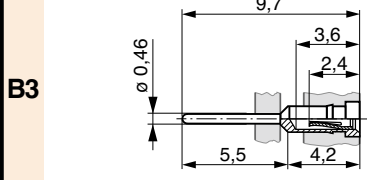
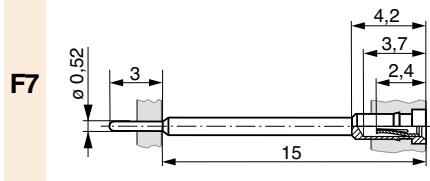
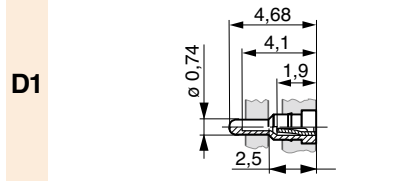
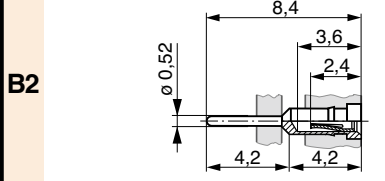
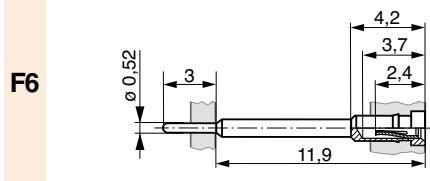
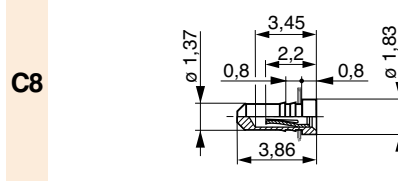
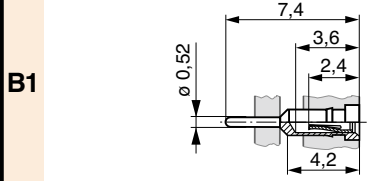
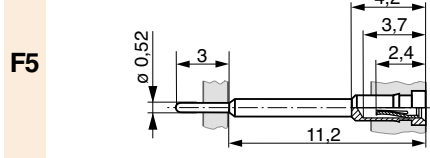
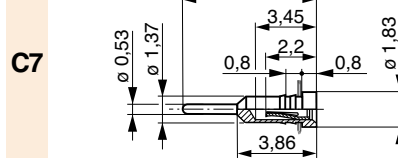
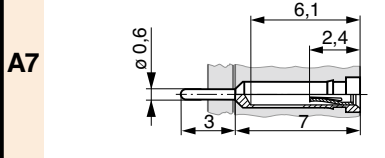
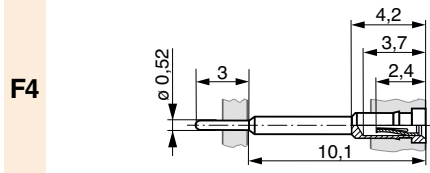
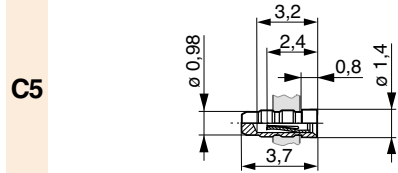
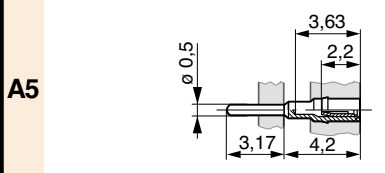

www.mpe-connector.de

MPE-Garry GmbH • Schäßlerstraße 13 • 87629 Füssen • Germany • Phone: +49 (0) 83 62 / 91 56-0 • Fax: +49 (0) 83 62 / 91 56-500 • Email: vk@mpe-connector.de • www.mpe-connector.de

Contact Type

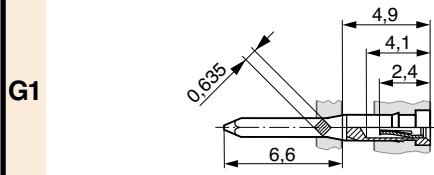

G1

K1

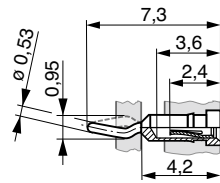

Z1

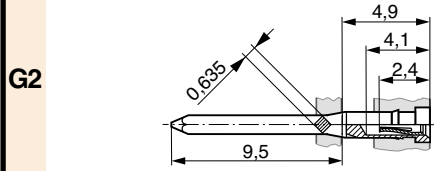
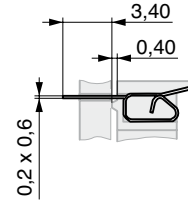

G2

K4

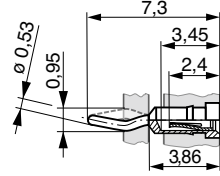

Z2

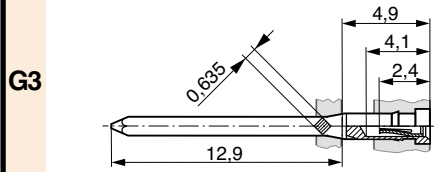
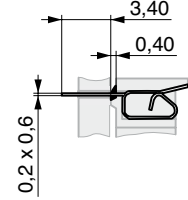

G3

K7

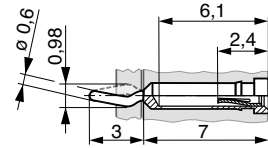

Z3

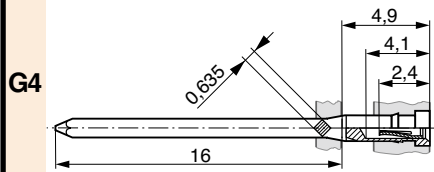
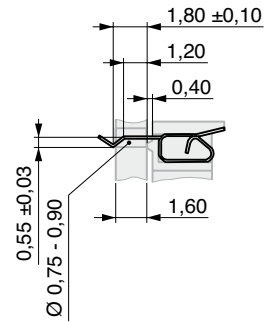

G4

T1

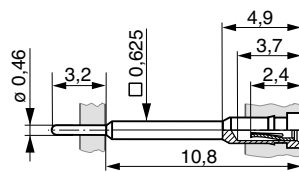

Z4

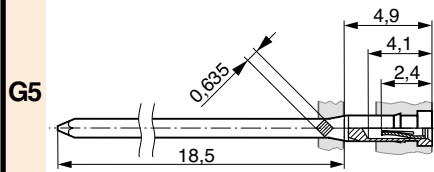
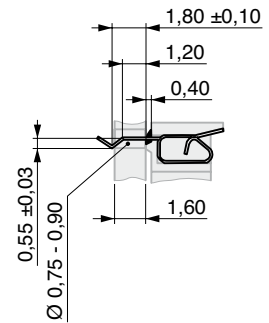

G5

T2

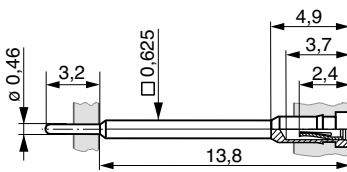

Z4

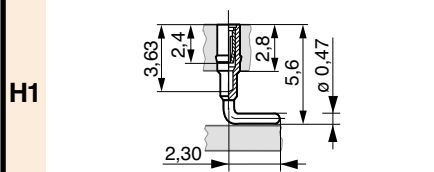

H1

T3

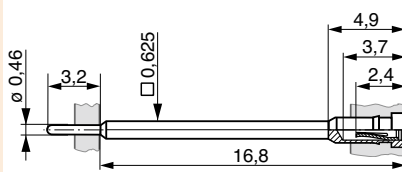

Z4

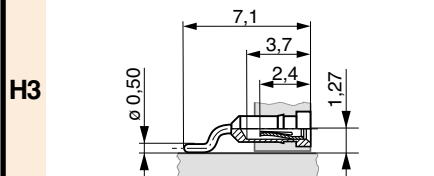

H3

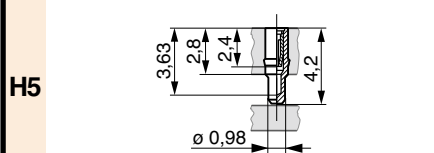

H5

Recommended hole size:

contact	hole
Ø 0,52	Ø 0,8
Ø 0,46	Ø 0,7
K1	Ø 0,8
K4	Ø 0,8