

Adapter for 6 mm to G1/2"

ZH6C004

Part Number



Technical Data

| Mechanical Data | |
|---------------------|------------------------|
| Height | 35 mm |
| Pressure Resistance | ≤ 10 bar |
| Temperature Range | -20...100 °C |
| Installation Type | Mounting |
| Material | Stainless Steel 1.4571 |
| Connection | Locking ring |
| Packaging unit | 1 Piece |
| Mounting Number | 908 |

This locking ring connector is suitable for adapting connections from 6 mm to G1/2".

Complementary Products

Seal G1/2" ZH5G002

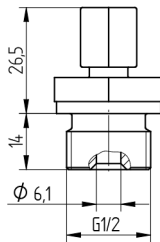

All dimensions in mm (1 mm = 0.03937 Inch)

