

| REV. | DATE | ECR NO. | DESCRIPTION |
|------|----------|---------|--|
| A | 06/16/01 | XXXXXX | MODIFY PLATING SPEC. |
| B | 01/30/04 | XXXXXX | UPDATE DRAWING FORMAT/MODIFY BODY LENGTH/COVER |
| C | 06/21/12 | 2294 | REVISE THE DESIGN |

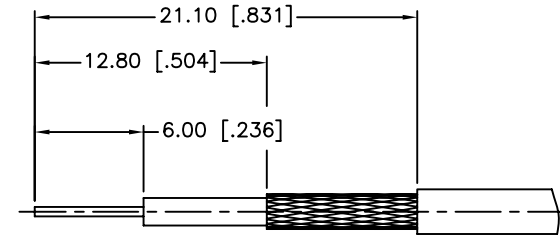

RECOMMENDED
CABLE STRIPPING DIM'S

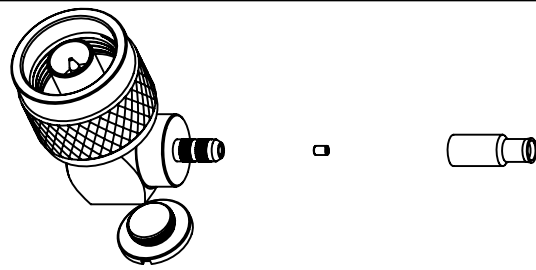
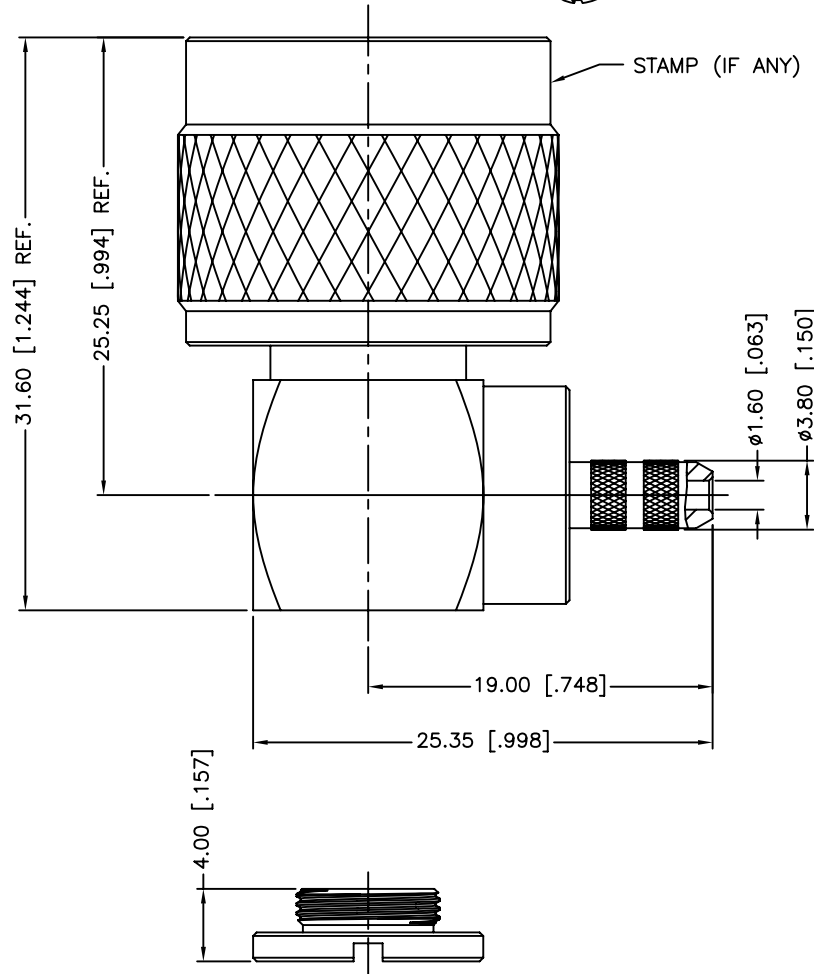

1. IMPEDANCE:50 OHM
2. FREQUENCY RANGE: DC-2.5 GHz
3. VSWR: 1.2 MAX.
3. DIELECTRIC WITHSTANDING VOLTAGE: 2500 VRMS, MIN.
4. DURABILITY: 500 CYCLES MIN.
5. TEMPERATURE RANGE: -65°C TO +165°C
6. CRIMPED FERRULE
HEX. CRIMP SIZE .178"
7. CONTACT PIN TO SOLDER

| QTY | DESCRIPTION | MATERIAL | FINISH | QTY |
|-----|------------------|-----------------|---------|-----|
| 9 | FERRULE | BRASS | NEXCOTE | 1 |
| 8 | INSULATOR | ULTEM | NATURAL | 1 |
| 7 | COVER | BRASS | NEXCOTE | 1 |
| 6 | BODY WITH BARREL | BRASS | NEXCOTE | 1 |
| 5 | CONTACT PIN | BRASS | GOLD | 1 |
| 4 | RETAINER RING | PHOSPHOR BRONZE | NATURAL | 1 |
| 3 | GASKET | SILICONE | RED | 1 |
| 2 | INSULATOR | PTFE | NATURAL | 1 |
| 1 | COUPLING NUT | BRASS | NEXCOTE | 1 |

UNLESS OTHERWISE SPECIFIED DIMENSIONS ARE IN MILLIMETERS. DIMENSIONS IN [] ARE IN INCHES AND FOR CUSTOMER REFERENCE ONLY.

UNLESS OTHERWISE SPECIFIED TOLERANCES FOR MILLIMETERS ARE:
0.5 - 8mm ± 0.20mm
8 - 30mm ± 0.40mm
30 - 120mm ± 0.50mm

UNLESS OTHERWISE SPECIFIED TOLERANCES FOR INCHES ARE:
.020 - .315 = ± 0.007"
.315 - 1.180 = ± 0.015"
1.180 - 4.724 = ± 0.020"

DO NOT SCALE DRAWING

| APPROVALS | DATE |
|-------------------------------|----------|
| DRAWN M.ZHANG | 06/21/12 |
| CHECKED | |
| ISSUED | |
| SHEET 1 OF 1 | |
| CAD FILE C:/CONNEX/172180.DWG | |

| | | | |
|--|------------|--------|----|
| Amphenol Connex | | | |
| PART DESCRIPTION N R/A CRIMP PLUG (FOR RG-316/U,174/U CABLE) | | | |
| PART NO. | | 172180 | |
| DWG. NO. | 172180.DWG | REV. | C |
| SIZE | A | SCALE | NA |