

17.007 (3000 PSI)

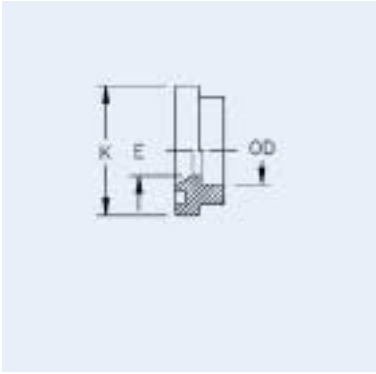

Braze Flange Code 61

SAE Flansch-Schulter zum Einlöten Code 61

Collet SAE à braser Code 61

Flangia SAE de brasare Code 61

Espesor de brida SAE para ser soldado Code 61

Part Number	Thread T	Flange	Tube O.D. mm	ND	Size	A mm	E mm	K Ø mm	Max. Oper. Press. bar
17.007-15-8		1/2"	15	12	-8		12,0	30,2	345
17.007-22-12		3/4"	22	19	-12		18,0	38,1	345
17.007-28-16		1"	28	25	-16		25,0	44,4	345
17.007-35-20		1 1/4"	35	31	-20		30,0	50,8	275
17.007-42-24		1 1/2"	42	38	-24		36,0	60,3	210
17.007-55-32		2"	55	51	-32		49,0	71,4	210
17.007-65-40		2 1/2"	65	60	-40		60,1	84,1	175
17.007-75-48		3"	75	75	-48		70,0	101,6	140

SAE Standard Pressure Series.
Max. working pressure see G74446-Size.
Material: 11SMnPb30

SAE Standard Pressure Series.
Max. working pressure see G74446-Size.
Material: 11SMnPb30

SAE Standard Pressure Series.
Max. working pressure see G74446-Size.
Material: 11SMnPb30

SAE Standard Pressure Series.
Max. working pressure see G74446-Size.
Material: 11SMnPb30

SAE Standard Pressure Series.
Max. working pressure see G74446-Size.
Material: 11SMnPb30

17.008 (6000 PSI)

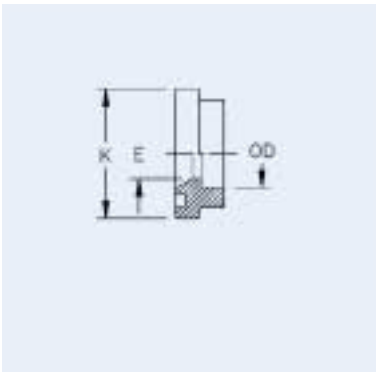

Braze Flange (Shoulder) Code 62

SAE Flansch-Schulter zum Einlöten Code 62

Collet SAE à braser Code 62

Flangia SAE de brasare Code 62

Espesor de brida SAE para ser soldado Code 62

Part Number	Thread T	Flange	Tube O.D. mm	ND	Size	A mm	E mm	K Ø mm	Max. Oper. Press. bar
17.008-16-8		1/2"	16	12	-8		12,0	31,8	415
17.008-20-12		3/4"	20	19	-12		16,0	41,3	415
17.008-25-12		3/4"	25	19	-12		18,0	41,3	415
17.008-30-16		1"	30	25	-16		23,0	47,6	415
17.008-35-20		1 1/4"	35	31	-20		27,0	54,0	415
17.008-42-24		1 1/2"	42	38	-24		32,0	63,5	415
17.008-55-32		2"	55	51	-32		45,0	79,4	415

SAE High Pressure Series.
Max 415 bar working pressure.
Material: 11SMnPb30

SAE High Pressure Series.
Max 415 bar working pressure.
Material: 11SMnPb30

SAE High Pressure Series.
Max 415 bar working pressure.
Material: 11SMnPb30

SAE High Pressure Series.
Max 415 bar working pressure.
Material: 11SMnPb30

SAE High Pressure Series.
Max 415 bar working pressure.
Material: 11SMnPb30