

## M83513 ORDERING INFORMATION PRINTED CIRCUIT BOARD TERMINATION:

M83513/XX - X XX X X

### Specification Sheet

- 10 = plug (pin), CBR type, sizes 9-37
- 11 = plug (pin), CBR type, size 51
- 12 = plug (pin), CBR type, size 100
- 13 = receptacle (socket), CBR type, sizes 9-37
- 14 = receptacle (socket), CBR type, size 51
- 15 = receptacle (socket), CBR type, size 100

### Hardware

- N = no jackpost or threaded insert
- P = jackpost
- T = threaded insert
- W = jackpost and threaded insert

### Shell Finish

- C = cadmium
- N = electroless nickel
- P = passivated stainless steel

### Lead Length (inches)

- 01 = .109 ± .015
- 02 = .140 ± .015
- 03 = .172 ± .015

### Insert Arrangement

- A = 9
- B = 15
- C = 21
- D = 25
- E = 31
- F = 37
- G = 51 (applicable for spec sheet 11, 14)
- H = 100 (applicable for spec sheet 12, 15)

INCHES (MM)

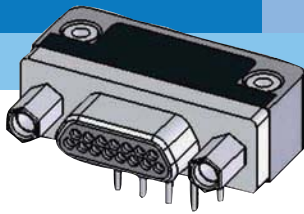

**PLUG**

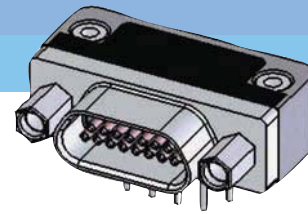

**RECEPTACLE**

\*INTERFACIAL SEAL NOT INCL. FOR PLASTIC SHELL

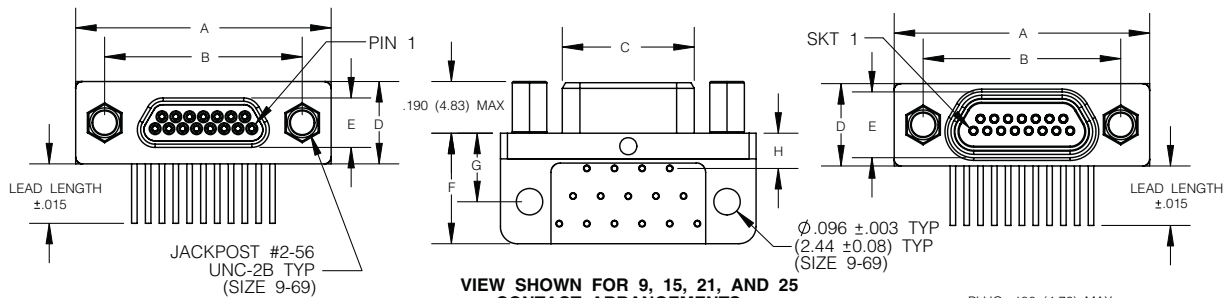

**VIEW SHOWN FOR 9, 15, 21, AND 25 CONTACT ARRANGEMENTS**

PLUG .186 (4.72) MAX  
RCPT .198 (5.03) MAX

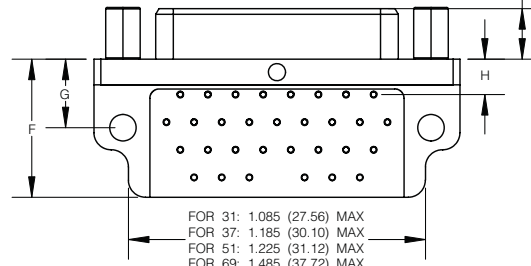

**VIEW SHOWN FOR 31, 37, 51 and 69 CONTACT ARRANGEMENTS**

JACKPOST #4-40  
UNC-2B TYP  
(SIZE 100)

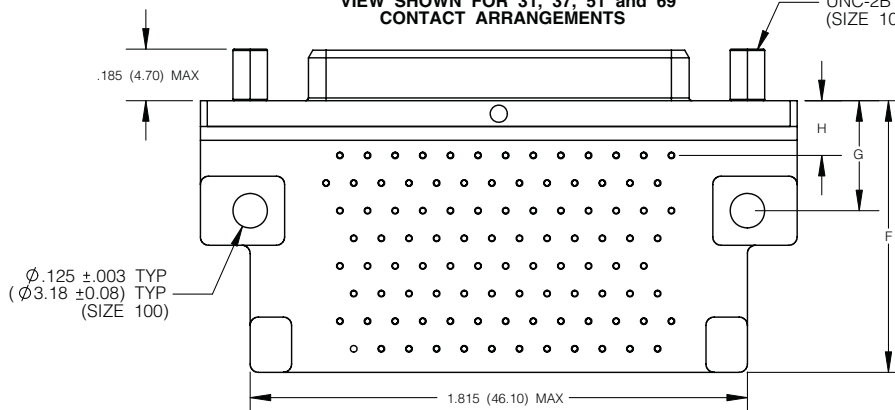

**VIEW SHOWN FOR 100 CONTACT ARRANGEMENTS**

SIZE	A MAX	B ±.005 (0.13)	C MAX		D MAX	E MAX		F MAX	G ±.010 (0.25)	H ±.010 (0.25)
			PLUG	RCPT		PLUG	RCPT			
09	.785 (19.94)	.565 (14.35)	.334 (8.48)	.402 (10.21)	.308 (7.82)	.185 (4.70)	.253 (6.43)	.420 (10.67)	.250 (6.35)	.230 (5.81)
15	.935 (23.75)	.715 (18.16)	.484 (12.29)	.552 (13.97)	.308 (7.82)	.185 (4.70)	.253 (6.43)	.420 (10.67)	.250 (6.35)	.130 (3.30)
21	1.085 (27.56)	.865 (21.97)	.634 (16.10)	.702 (17.83)	.308 (7.82)	.185 (4.70)	.253 (6.43)	.420 (10.67)	.250 (6.35)	.130 (3.30)
25	1.185 (30.10)	.965 (24.51)	.734 (18.64)	.802 (20.37)	.308 (7.82)	.185 (4.70)	.253 (6.43)	.420 (10.67)	.250 (6.35)	.130 (3.30)
31	1.335 (33.91)	1.115 (28.32)	.884 (22.45)	.952 (24.18)	.308 (7.82)	.185 (4.70)	.253 (6.43)	.520 (13.21)	.250 (6.35)	.130 (3.30)
37	1.485 (37.72)	1.265 (32.13)	1.034 (26.26)	1.102 (27.99)	.308 (7.82)	.185 (4.70)	.253 (6.43)	.520 (13.21)	.250 (6.35)	.130 (3.30)
51	1.435 (36.45)	1.215 (30.86)	.984 (24.99)	1.052 (26.72)	.351 (8.92)	.228 (5.79)	.296 (7.52)	.650 (16.15)	.300 (7.62)	.150 (3.81)
69	1.735 (44.07)	1.515 (38.48)	1.289 (32.74)	1.357 (34.47)	.351 (8.92)	.228 (5.79)	.296 (7.52)	.755 (19.18)	.300 (7.62)	.150 (3.81)
100	2.170 (55.12)	1.800 (45.72)	1.386 (35.15)	1.508 (38.10)	.394 (10.01)	.271 (6.88)	.394 (10.01)	1.000 (25.40)	.400 (10.16)	.200 (5.08)

INCHES (MM)



## RIGHT ANGLE (90 DEG) NARROW PROFILE PC CONFIGURATIONS

.100 (2.54) x .100 (2.54) grid pattern, offset .050 (1.27)

Cavity identification numbers are for reference only and does not appear on the connector.

