

Basic series

5 mm embeddable

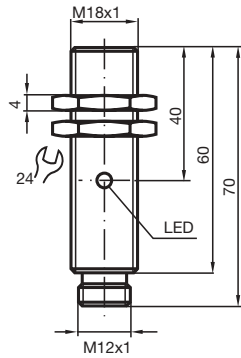

Switching element function	PNP	Antivalent
Rated operating distance s_n	5 mm	
Installation	embeddable	
Assured operating distance s_a	0 ... 4,05 mm	
Reduction factor r_{Al}	0,25	
Reduction factor r_{Cu}	0,15	
Reduction factor r_{V2A}	0,66	
Reduction factor r_{St37}		
Operating voltage U_B	10 ... 30 V	
Switching frequency f	0 ... 800 Hz	
Reverse polarity protection	Protected against reverse polarity	
Short circuit protection	pulsing	
Voltage drop U_d	≤ 3 V	
Operating current I_L	0 ... 200 mA	
Off-state current I_r	0 ... 0,5 mA typ.	
No-load supply current I_0	≤ 20 mA	
Indication of the switching state	LED, yellow	
Standards	EN 60947-5-2	
Ambient temperature	-25 ... 70 °C (248 ... 343 K)	
Connection type	V1-connector	
Housing material	brass, nickel-plated	
Sensing face	PBT	
Protection degree	IP67	

Connection_type:

A2

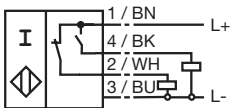

089952_ENG.xml

2003-08-15

www.pepperl-fuchs.com

PEPPERL+FUCHS GmbH