

# AR35-J13T & AR35-J16T

Contact Sales

## AR35-J13T/J16T Encoder Alignment Jig for the AR35-T25x Series Absolute Encoder IC with ABI/UVW Output

Currently Viewing:

Specifications

## Overview

The AR35-T25x through-hollow series is a miniature reflective absolute encoder ASIC designed for space-constrained applications. The AR35 encoder is designed for an overall diameter of 35 mm and delivers up to 25 bits single-turn absolute output. The AR35 series also provides dedicated incremental ABI and UVW signals output in differential mode. At a rated high operating temperature range of  $-40^{\circ}\text{C}$  to  $115^{\circ}\text{C}$ , the AR35 encoder is suitable for most industrial applications. Dual-mode operating voltage of 3.3V and 5V enables flexibility in the PCBA design of customers' end applications.

[\[PDF\] AR35-T25E/S AR35 Through-Hole Series Miniature Programmable Single-Turn Absolute Encoder with Resolution Ranging from 17 to 25 Bits Data Sheet](#)

### Features

- Miniature absolute encoder ASIC surface mount DFN package: 10.9 mm (L) x 9.1 mm (W) x 1.5 mm (H)
- User-programmable resolution up to 25 bits single turn
- User-programmable incremental output (ABI) resolution ranging from 128 to 8192 CPRs
- User-programmable commutation signal (UVW) ranging from 2, 3, 4, 5, 12, 30, 32 pole-pairs
- Differential output for ABI and UVW
- High temperature range of  $-40^{\circ}\text{C}$  to  $115^{\circ}\text{C}$  suitable for most of the industrial operation
- Dual-mode operating voltage of 3.3V and 5V, enabling handheld and portable device applications
- Options of SSI/SPI or Encoder Serial Link(RS485) mode communication protocols
- RoHs compliance

### Applications

- Robotic automation and engineering
- Factory automation and drone
- Medical and dentistry, devices and equipment
- High-accuracy portable and handheld devices
- Miniature motor, servo motor, linear actuator

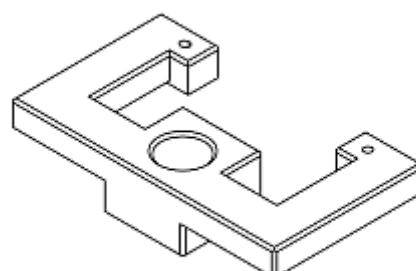

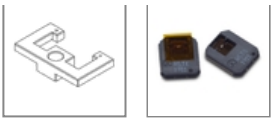

### Lifecycle Status

Active

## Ordering Information

1. AR35-J13T Alignment Jig, AR35 Through Hollow with 8mm Shaft
2. AR35-J16T Alignment Jig, AR35 Through Hollow with 9.5mm Shaft

## Specifications

Specification	Value
Lifecycle	Active
Distributor Inventory	No
Motion Type	Rotary
Optical Method	Reflective
Output Code	N/A
Product Size (mm)	N/A
Resolution	
Shaft Diameter	8
Technology Type	Absolute Reflective
Through Hole	Y

## Documentation

[Expand All](#) | [Collapse All](#)

[Application Note](#) 1 i +

[Data Sheet](#) 1 i -

Current

Title	Date	Type	Alert
-------	------	------	-------