

**ModuPlug  
HDC MHD 12 FC**

**Weidmüller Interface GmbH & Co. KG**  
Klingenbergstraße 26  
D-32758 Detmold  
Germany  
Fon: +49 5231 14-0  
Fax: +49 5231 14-292083  
www.weidmueller.com

**Flexible**

The four module sizes make for individual plug solutions that save a huge amount of space. The smaller pitch translates into an optimised design too.

**General ordering data**

Type	HDC MHD 12 FC
Order No.	<a href="#">1428850000</a>
Version	Module, 12-pole, Socket connector, Module
GTIN (EAN)	4050118233087
Qty.	1 pc(s).

**ModuPlug  
HDC MHD 12 FC**

**Weidmüller Interface GmbH & Co. KG**  
 Klingenbergstraße 26  
 D-32758 Detmold  
 Germany  
 Fon: +49 5231 14-0  
 Fax: +49 5231 14-292083  
 www.weidmueller.com

**Technical data****Dimensions and weights**

Width	14.5 mm	Width (inches)	0.571 inch
Height	38.9 mm	Height (inches)	1.531 inch
Depth	34 mm	Depth (inches)	1.339 inch
Net weight	10.265 g		

**Temperatures**

Limit temperature	-40 °C ... 125 °C
-------------------	-------------------

**General data**

Insulation strength	10 <sup>12</sup> Ω	Material	Polycarbonate, glass fibre reinforced
Number of poles	12	Plugging cycles	≥ 500
Pollution severity	3	Rated current (DIN EN 61984)	10 A
Rated impulse voltage (DIN EN 61984)	4 kV	Rated voltage (DIN EN 61984)	250 V
Rated voltage according to UL/CSA	600 V	Required plug-in slots	1
Series	ModuPlug	Surge voltage category	III
Type	Female	UL 94 flammability rating	V-0

**PE connection data**

Connection type PE	Screw connection via module frame
--------------------	-----------------------------------

**Version**

Conductor cross-section, max.	2.5 mm <sup>2</sup>	Conductor cross-section, min.	0.14 mm <sup>2</sup>
Stripping length, rated connection	8 mm	Type of connection	Crimp connection
Wire connection cross section AWG, max.	AWG 14	Wire connection cross section AWG, min.	AWG 26

**Classifications**

ETIM 6.0	EC002312	ETIM 7.0	EC002312
eClass 9.0	27-44-02-92	eClass 9.1	27-44-02-18
eClass 10.0	27-44-02-92		

**Approvals**

Approvals



ROHS Conform

**Downloads**

Brochure/Catalogue	<a href="#">CAT 3 HDC 17/18 EN</a> <a href="#">FL FIELDWIRING EN</a>
Engineering Data	<a href="#">EPLAN</a>
Engineering Data	<a href="#">STEP</a>

Creation date November 28, 2019 9:10:54 AM CET

Catalogue status 22.11.2019 / We reserve the right to make technical changes.

2

**ModuPlug  
HDC MHD 12 FC**

**Weidmüller Interface GmbH & Co. KG**  
 Klingenbergstraße 26  
 D-32758 Detmold  
 Germany  
 Fon: +49 5231 14-0  
 Fax: +49 5231 14-292083  
 www.weidmueller.com

**Drawings**

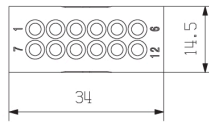
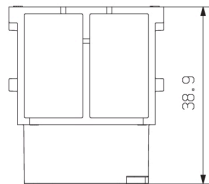

**HDC-MHD 12-Module im IP65-Gehäuse,  
Leiter H05V-K0,5:**

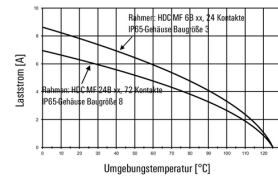

**HDC-MHD 12-Module im IP65-Gehäuse,  
Leiter H07V-K2,5:**

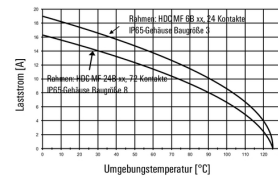

**HDC-MHD 12-modules in the IP65-housing,  
Conductor H05V-K0.5:**

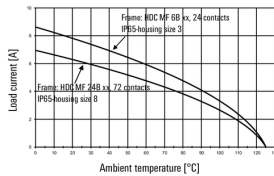

**HDC-MHD 12-modules in the IP65-housing,  
Conductor H07V-K2.5:**

