

PHILIPS

Lighting



HF-Performer II Xtreme for TL5/TL-D lamps

HF-P XT 236 TL-D EII 220-240V 50/60HZ

HF-Performer Xtreme is a unique X-technology from Philips that guarantees the highest lifetime reliability for lamps and enables an extra-long and reliable HF system life with an energy efficiency index (CELMA EEI) of A2.

Product data

General Information

Application code	EII
Type version	mk1
Lamp type	TL-D
Number of lamps	2 piece/unit
Number of products on MCB (16 A type B) (nom.)	12
Automatic restart	Yes

Operating and Electrical

Input voltage	220 to 240 V
Input frequency	50 to 60 Hz
Operating frequency (min.)	42 kHz
Ignition method	Warm Start
Crest factor (max.)	1.7
Power factor 100% load (nom.)	0.96
Ignition time (max.)	2.0 s
Mains voltage performance (AC)	-8%+6%
Mains voltage safety (AC)	-10%+10%
Earth leakage current (nom.)	0.5 mA
Inrush current width	0.350 ms

Constant wattage deviation	-2%/+2%
Ballast factor (nom.)	1.0
Power losses (nom.)	8.0 W
Inrush current peak (max.)	31 A

Wiring

Connector type input terminals	WAGO 251 universal connector [Suitable for both automatic wiring (ALF and ADS) and manual wiring]
Cable capacity output wires mutual (nom.)	200 pF
Connector type output terminals	WAGO 251 universal connector [Suitable for both automatic wiring (ALF and ADS) and manual wiring]
Wire strip length	8.0-9.0 mm
Input terminal cross section	0.50-1.00 mm ²
Output terminal cross section	0.50-1.00 mm ²
Auto Insert (ALF/ADS) Wire Cross Section	0.5 mm ²
Cable capacity output wires to earth (nom.)	200 pF

HF-Performer II Xtreme for TL5/TL-D lamps

System characteristics	
Rated ballast-lamp power	36 W
Rated lamp power on TL-D	36 W
System power on TL-D	40 W
Lamp power on TL-D	32 W
Power loss on TL-D	8 W
Temperature	
T ambient (max.)	60 °C
T ambient (min.)	-25 °C
T storage (max.)	80 °C
T storage (min.)	-25 °C
T case lifetime (nom.)	75 °C
T-Case maximum (max.)	75 °C
T-ignition (max.)	60 °C
T-ignition (min.)	-25 °C
Mechanical and Housing	
Housing	L 360x30x28
Emergency Operation	
Battery voltage lamp ignition	198 V
Battery voltage lamp operation	176-254
Approval and Application	
Energy efficiency index	A2
EMI 9 kHz... 30 MHz	EN55015
EMI 30 MHz... 1,000 MHz	EN55022 level B

Safety standard	IEC 61347-2-3
Performance standard	IEC 60929
Quality standard	ISO 9000:2000
Environmental standard	ISO 14001
Harmonic current emission standard	IEC 61000-3-2
EMC immunity standard	IEC 61547
Vibration standard	IEC68-2-6 F c
Bumps standard	IEC 68-2-29 Eb
Humidity standard	EN 61347-2-3 clause 11
Approval marks	CE marking ENEC certificate VDE-EMV certificate
Temperature marking	Yes
Emergency standard	IEC 60598-2-22
Humming and noise level	Inaudible

Product Data

Full product code	871150091202230
Order product name	HF-P Xt 236 TL-D EII 220-240V 50/60Hz
EAN/UPC – product	8711500912022
Order code	91202230
Local Code	HFPXT236TLDEII
Numerator – quantity per pack	1
Numerator – packs per outer box	12
Material no. (12NC)	913700617866
Net weight (piece)	0.400 kg

Dimensional drawing

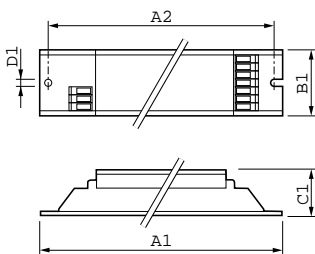

HF-P Xt 236 TL-D EII 220-240V 50/60Hz

Product	D1	C1	A1	A2	B1
HF-P Xt 236 TL-D EII 220-240V 50/60Hz	4.2 mm	28.0 mm	360.0 mm	350.0 mm	30.0 mm

HF-Performer II Xtreme for TL5/TL-D lamps

