

## Tabs

with tab width **2.8 mm**  
for soldering into PC boards

Type 1

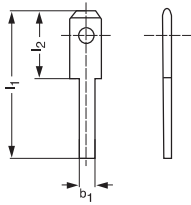

## Flachstecker

mit Steckerbreite **2,8 mm**  
zum Einlöten in Leiterplatten

Type 2

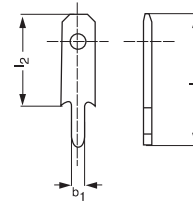

Type 3

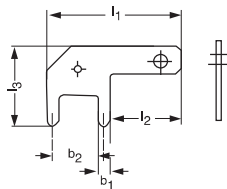

Type 4

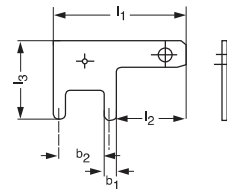

Type	Tab thickness	Tab width	b1	b2	l1	l2	l3	Mat-erial thickness	Form E=single B=chain	Part number	Material	Surface
2	0.80	2.80	0.90		10.50	6.50		0.80	E	12610.123.025	CuZn	Sn
2	0.80	2.80	0.90		11.50	8.10		0.80	E	12625.123.011	CuZn	Sn
4	0.80	2.80	1.30	5.00	13.40	7.10	8.00	0.80	E	17124.123.025	CuZn	Sn
3	0.80	2.80	1.30	5.00	13.40	7.10	8.00	0.80	E	17127.123.025	CuZn	Sn
1	0.80	2.80	1.40		14.00	6.50		0.80	E	17486.123.025	CuZn	Sn
Typ	Steck-dicke	Steck-breite	b1	b2	l1	l2	l3	Mat.-dicke	Form E=Einzel B=Band	Teile-Nr.	Werkstoff	Oberfläche