

PRODUCT NUMBER	No. OF POS.	DIM "A"	DIM "B"
67954-001LF	1x02	4.93	6.93
67954-002LF	1x03	7.47	9.47
67954-003LF	1x04	10.01	12.01

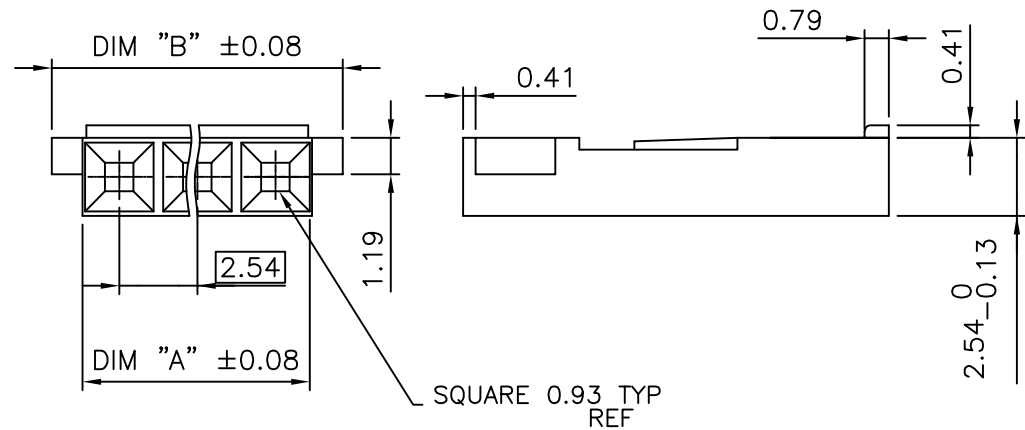
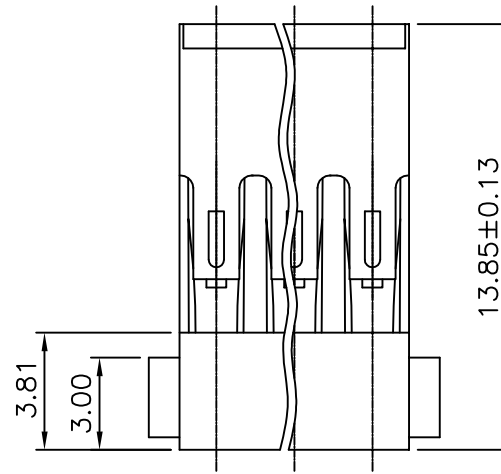

NOTES:

- MOLDING MATERIAL : POLYAMID (PA 66), COLOR BLACK 25% GLASS FILLED, UL 94 V0
- STANDARD PACKAGING IN POLYBAGS
- TERMINALS MUST BE CRIMPED PROPERLY FOR SATISFACTORY LATCHING :
- FOR CRIMPING INSTRUCTIONS, SEE TA-75
- FOR TERMINAL APPLICATION SEE TA-531.
PRODUCT SPECIFICATION: BUS-12-067.
- THIS HOUSING IS INTENDED FOR USE WITH MINI PV TERMINAL WITH 22-36 GAUGE WIRE
- PRODUCT MEETS EUROPEAN UNION DIRECTIVES AND OTHER COUNTRY REGULATIONS AS DESCRIBED IN GS-22-008.
- THE PRODUCT IS NOT INTENDED TO BE EXPOSED TO A MANUFACTURING SOLDER PROCESS.

mat'l. code SEE NOTES				surface ISO 1302 ✓	tolerance ISO 406 ISO 1101	projection mm	product family BERCONN
ltr	ecn no	dr	date	tolerances unless otherwise specified		title	
H	V07-0532	HTB	07.08.16	angles	.x ±0.3	MINI LATCH SR	
J	F11-0099	LMU	11.09.05	linear	.xx ±0.13	POLARIZED HSG 2.54mm	
					.xxx ±0.05	scale 5:1	dwg no sheet 1 of 1 size
				dr	L.MULIN	11.05.19	67954 A3
				enr	L.MULIN	11.05.19	type CUSTOMER Drawing
				chr			
				appd	L.MU	11.05.19	
sheet index	revision sheet						

FCI
FCIconnect.com

Copyright FCI