

PART NUMBER	WIRE SIZE	ASSEMBLY OPTION	A	B	C	D
2064600011	26-30 AWG	CHAIN	2.10	1.91	1.65	1.47
2064600021	20-24 AWG		2.51	2.31	2.08	1.91
2064600031	18 AWG		2.51	2.31	2.39	2.18
2064600041	16 AWG		2.97	2.67	2.70	2.70

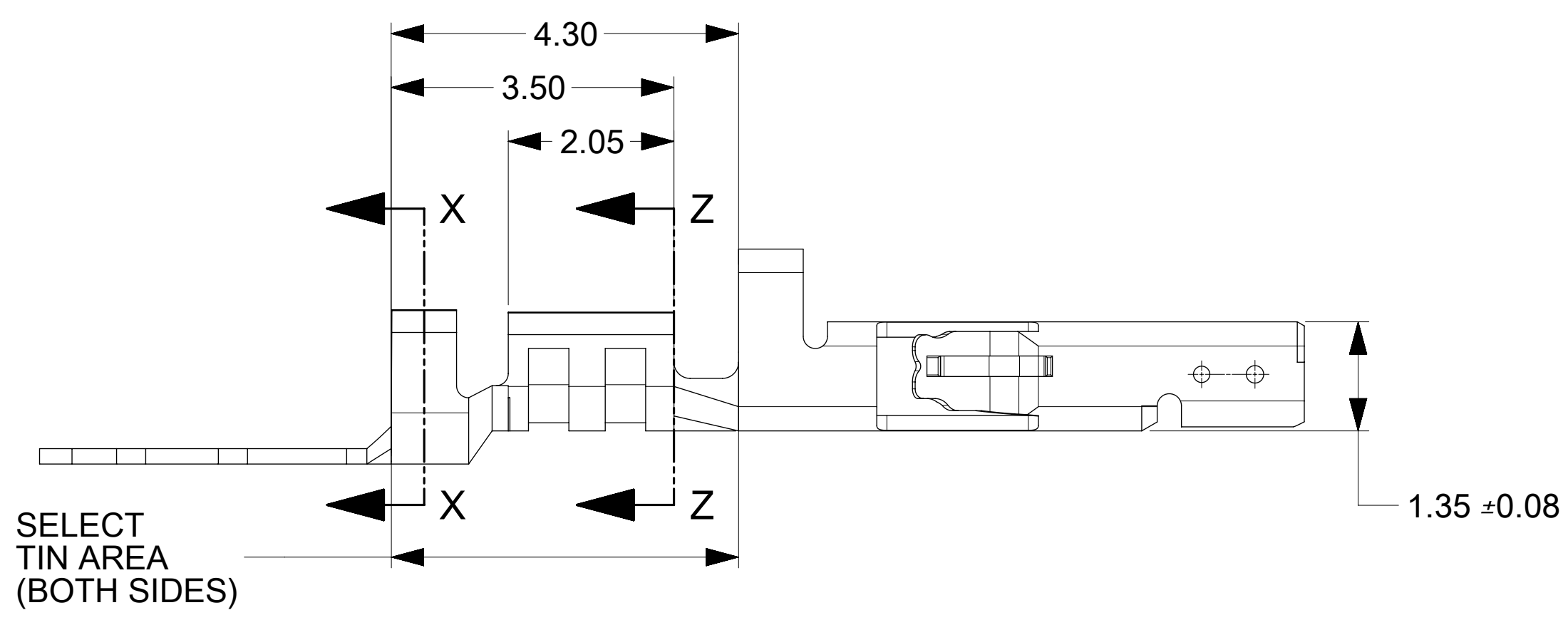

FOR 2064600041 ONLY

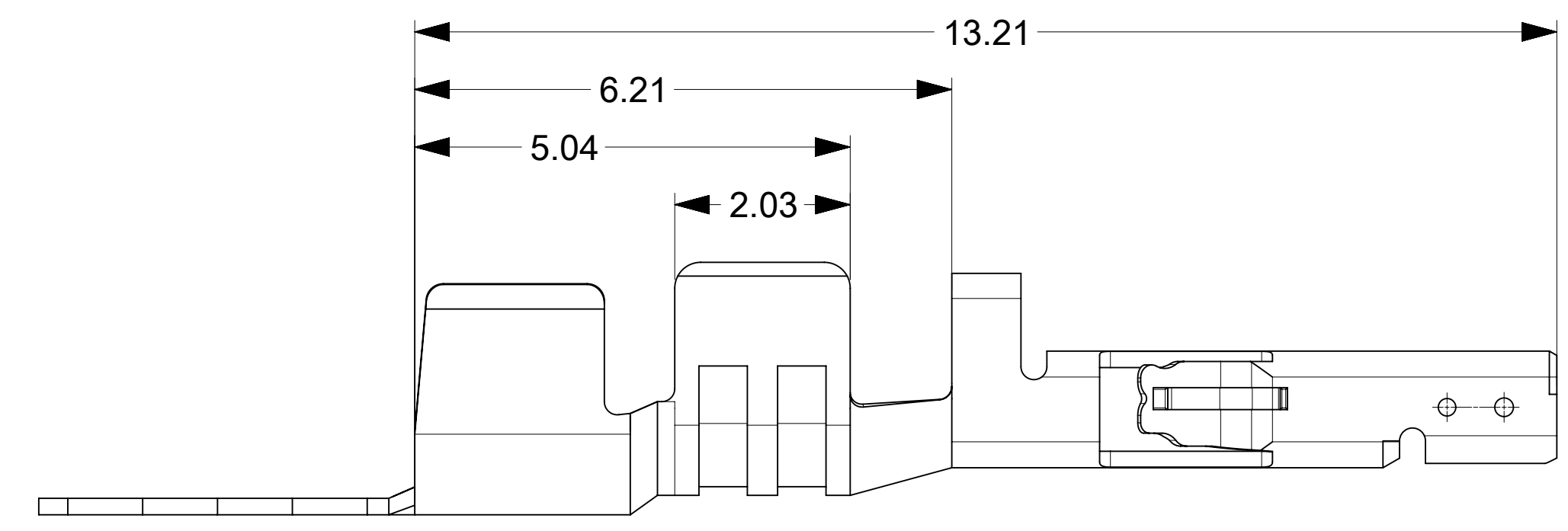

- NOTES:
1. MATERIAL: HIGH COPPER ALLOY
 2. PLATING : TIN OVER NICKEL OVER ALL
 3. PRODUCT SPECIFICATION: 2064600000-PS
 4. PACKAGING SPECIFICATION: 2064600000-PK
 5. TERMINAL FOR USE IN RECEPTACLE SERIES 206461
 6. COSMETIC SPECIFICATION: PS-45499-002 CLASS B

THIS DRAWING CONTAINS INFORMATION THAT IS PROPRIETARY TO MOLEX ELECTRONIC TECHNOLOGIES, LLC AND SHOULD NOT BE USED WITHOUT WRITTEN PERMISSION		CURRENT REV DESC: NEW RELEASE		molex	
DIMENSION UNITS mm	SCALE 15:1				
GENERAL TOLERANCES (UNLESS SPECIFIED)		EC NO: 615288		FEMALE TERMINAL MICRO-FIT + SOLUTION	
ANGULAR TOL	± 0.5°	DRWN: SGANGADHARDO 2019/04/09			
4 PLACES	±	CHK'D: SGANGADHARDO 2019/04/09		PRODUCT CUSTOMER DRAWING	
3 PLACES	±	APPR: ISHWARG 2019/04/10			
2 PLACES	± 0.25	INITIAL REVISION:		DOCUMENT NUMBER 2064600000-SD	
1 PLACE	± 0.35	DRWN: SMAHAJANSHET 2018/05/08			
0 PLACES	±	APPR: NCSR 2019/04/02		DOC TYPE PSD	DOC PART 000
DRAFT WHERE APPLICABLE MUST REMAIN WITHIN DIMENSIONS	THIRD ANGLE PROJECTION	DRAWING D-SIZE	SERIES 206460	MATERIAL NUMBER SEE TABLE	CUSTOMER GENERAL MARKET
				REVISION A1	SHEET NUMBER 1 OF 1