



Model Number

NCN4-12GM40-Z1-V1

Features

- 4 mm not embeddable
- 2-wire DC

Connection

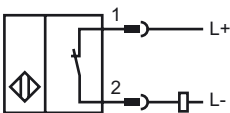

Pinout

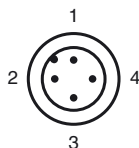

Wire colors in accordance with EN 60947-5-2

| | | |
|---|----|---------|
| 1 | BN | (brown) |
| 2 | WH | (white) |
| 3 | BU | (blue) |
| 4 | BK | (black) |

Accessories

- BF 12**
Mounting flange, 12 mm
- V1-G**
4-pin, M12 female field-attachable connector
- V1-W**
4-pin, M12 female field-attachable connector
- V1-W-2M-PUR**
Cable socket, M12, 4-pin, PUR cable
- V1-G-2M-PUR**
Cable socket, M12, 4-pin, PUR cable

Dimensions

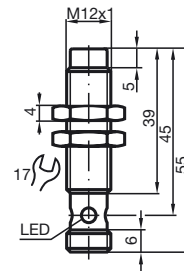

Technical Data

General specifications

| | | | |
|----------------------------|-------|----------------|----|
| Switching element function | | DC | NC |
| Rated operating distance | s_n | 4 mm | |
| Installation | | not embeddable | |
| Output polarity | | DC | |
| Assured operating distance | s_a | 0 ... 3.24 mm | |
| Reduction factor r_{Al} | | 0.42 | |
| Reduction factor r_{Cu} | | 0.4 | |
| Reduction factor r_{303} | | 0.75 | |

Nominal ratings

| | | |
|-----------------------------------|-------|-----------------------|
| Operating voltage | U_B | 5 ... 60 V |
| Switching frequency | f | 0 ... 800 Hz |
| Hysteresis | H | 1 ... 10 typ. 5 % |
| Reverse polarity protected | | tolerant |
| Short-circuit protection | | pulsing |
| Voltage drop | U_d | ≤ 5 V |
| Operating current | I_L | 2 ... 100 mA |
| Lowest operating current | I_m | 2 mA |
| Off-state current | I_r | 0 ... 0.5 mA typ. |
| Indication of the switching state | | Multihole-LED, yellow |

Ambient conditions

| | | |
|---------------------|--|--------------------------------|
| Ambient temperature | | -25 ... 70 °C (-13 ... 158 °F) |
|---------------------|--|--------------------------------|

Mechanical specifications

| | |
|-------------------|-----------------------------------|
| Connection type | Device connector M12 x 1 , 4-pin |
| Housing material | Stainless steel 1.4305 / AISI 303 |
| Sensing face | PBT |
| Protection degree | IP67 |

Compliance with standards and directives

| | |
|---------------------|---|
| Standard conformity | |
| Standards | EN 60947-5-2:2007 IEC 60947-5-2:2007 |

Approvals and certificates

| | |
|--------------|---|
| UL approval | cULus Listed, General Purpose |
| CSA approval | cCSAus Listed, General Purpose |
| CCC approval | Certified by China Compulsory Certification (CCC) |

Release date: 2011-07-08 13:38 Date of issue: 2011-07-08 069257_eng.xml