

## Datasheet - AZ 15/16-B6

Safety switch with separate actuator / AZ 15 / Actuator



- For very small actuating radii in line with or at 90° to the plane of the actuator



(Minor differences between the printed image and the original product may exist!)

### Ordering details

Product type description	AZ 15/16-B6
Article number	1137434
EAN code	4030661104706

### Global Properties

Product name	Beweglicher Betätiger AZ 15/16-B6
Weight	20 g

### Mechanical data

Design of actuators	angled, flexible
Minimum actuating radius	35 mm

### notice

Actuating radius adjustable using an hexagonal key wrench 2,5 mm (a/b) mm A/F (a and b), minimum 35 mm at 90° to the plane of the actuator and minimum 38 mm, in line with the plane of the actuator

The axis of the hinge should be 11 mm above the top edge of the safety switch and in the same plane

### Documents

**Mounting and wiring instructions** (de, en, fr, it, es, jp) 267 kB, 29.08.2006

[http://127.0.0.1/Bilddata/AZ/Pdf/Az15\\_16/montage/m\\_z15p02.pdf](http://127.0.0.1/Bilddata/AZ/Pdf/Az15_16/montage/m_z15p02.pdf)

### Images

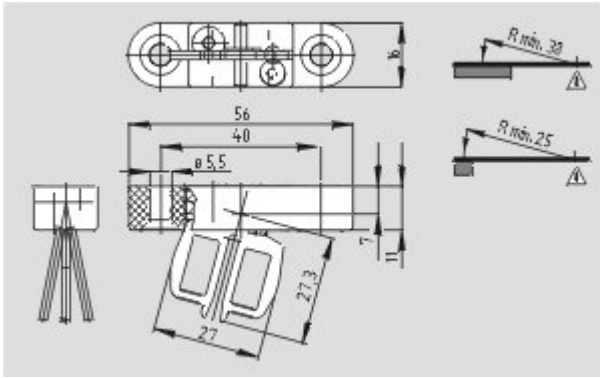

Dimensional drawing (miscellaneous)

---

K.A. Schmersal GmbH, Möddinghofe 30, D-42279 Wuppertal  
The data and values have been checked thoroughly. Technical modifications and errors excepted.  
Generiert am 21.04.2011 - 13:49:14h Kasbase 1.4.7 DBI