

DO NOT SCALE DRAWING

REVISION

A INITIAL DRAWING 23.9.15

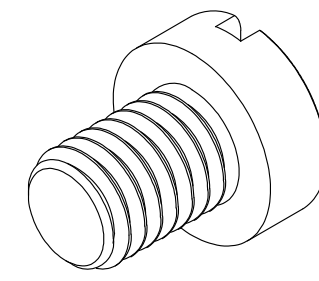
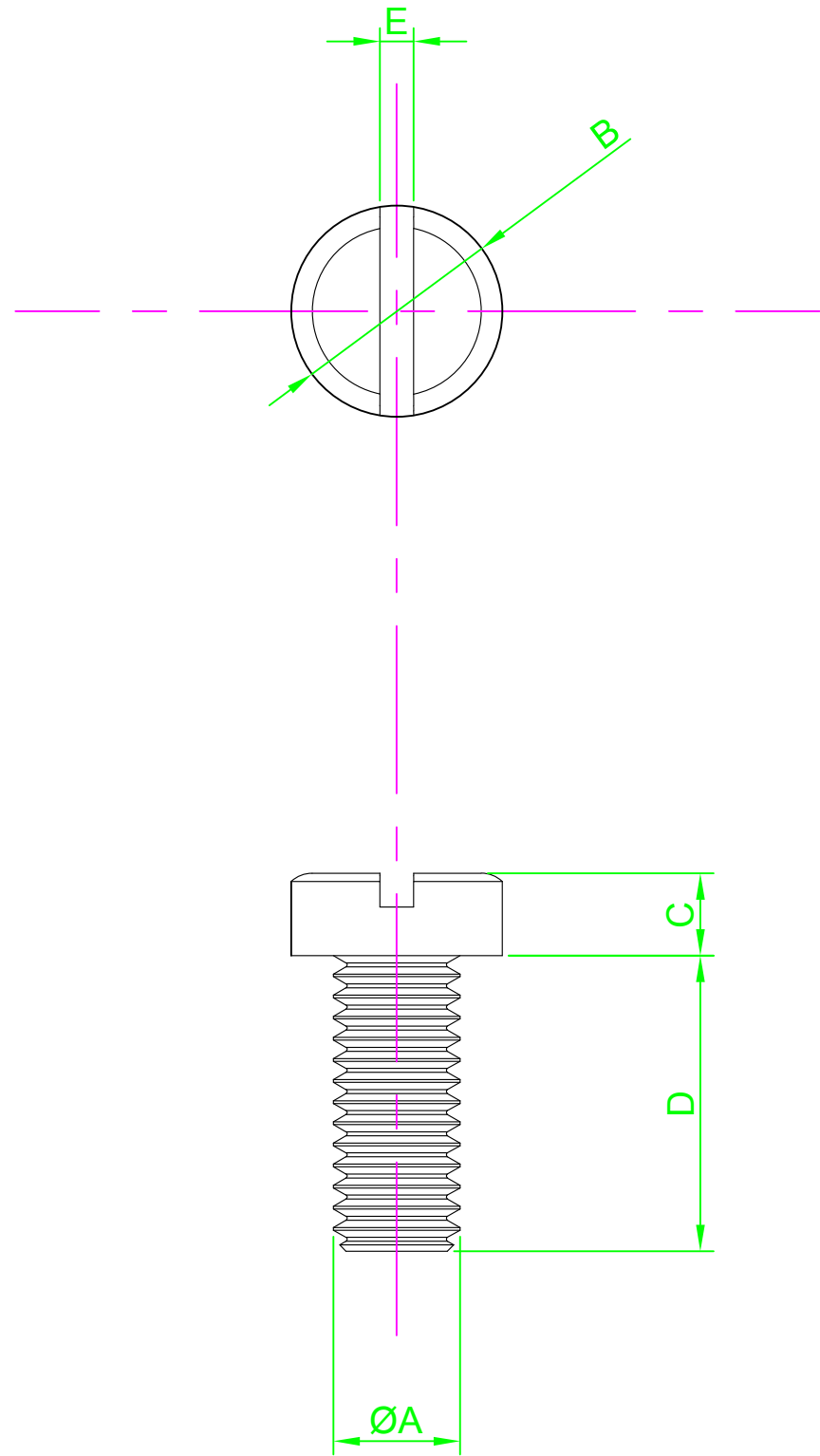

Part Number	ØA	B Nom	C Nom	D Length	E Nom
M2 6 CSSTMC Z100	M2-0.4	3.8	1.3	6	0.5
M2 12 CSSTMC Z100				12	
M2.5 6 CSSTMC Z100	M2.5-0.45	4.5	1.6	6	0.6
M2.5 10 CSSTMC Z100				10	
M2.5 12 CSSTMC Z100				12	
M2.5 20 CSSTMC Z100				20	
M3 6 CSSTMC Z100	M3-0.5	5.5	2.0	6	0.8
M3 8 CSSTMC Z100				8	
M3 10 CSSTMC Z100				10	
M3 12 CSSTMC Z100				12	
M3 16 CSSTMC Z100				16	
M3 20 CSSTMC Z100				20	
M3 25 CSSTMC Z100	25				
M4 6 CSSTMC Z100	M4-0.7	7.0	2.6	6	1.2
M4 8 CSSTMC Z100				8	
M4 10 CSSTMC Z100				10	
M4 12 CSSTMC Z100				12	
M4 16 CSSTMC Z100				16	
M4 20 CSSTMC Z100				20	
M4 25 CSSTMC Z100				25	
M4 30 CSSTMC Z100				30	
M5 10 CSSTMC Z100	M5-0.8	8.5	3.3	10	1.2
M5 12 CSSTMC Z100				12	
M5 16 CSSTMC Z100				16	
M5 20 CSSTMC Z100				20	
M5 25 CSSTMC Z100				25	
M6 16 CSSTMC Z100	M6-1.0	10.0	3.9	16	1.6
M6 30 CSSTMC Z100				30	
M6 40 CSSTMC Z100				40	

NOTES:



UNLESS OTHERWISE SPECIFIED:  
DIMENSIONS ARE IN MM (MILLIMETERS).  
SURFACE FINISH:  
TOLERANCES: DIN 84

MATERIAL:  
Steel

TITLE:  
Slotted Cheese Head Machine Screw DIN 84

	NAME	DATE
DRAWN	Darryl Wilson	23.09.15
CHK'D		
APPVD		

HEAT TREATMENT:

DESIGN RIGHT. TR FASTENINGS LTD, 2003  
UNDER NO CIRCUMSTANCES MUST THIS  
DRAWING BE COPIED OR DISCLOSED  
WITHOUT FIRST OBTAINING WRITTEN  
AUTHORITY.

CUSTOMER PART NUMBER:  
N/A

FINISH:  
TC1 - Commercial Zinc/Clear Trivalent

DRAWING NUMBER:  
TR32CSSTMC

A4