

**MATERIAL**

Aluminium. Oval flat cross section bar.

STANDARD EXECUTIONS

Threaded blind holes.

- **GN 668-BL**: natural aluminium.- **GN 668-SW**: epoxy resin coating, RAL 9005 black colour, matte finish.**SPECIAL EXECUTIONS ON REQUEST**

Front mounting by means of two polyamide based (PA) technopolymer adapters, black colour, matte finish and two M5 screws.

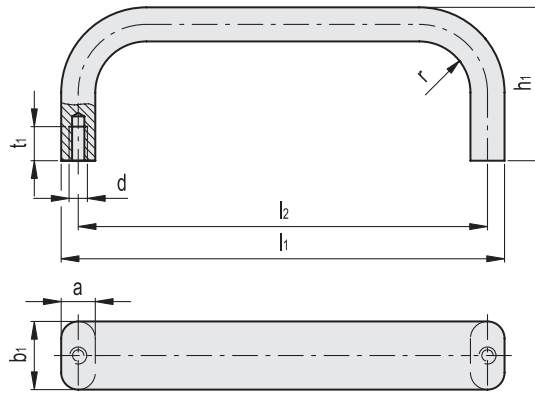

Code	Description	b1	l1	l2	d	a	h1	r	t1 min	⚖️
GN.27521	GN 668-20-130-A-BL	20	130±0.25	120	M5	10	45	15	10	85
GN.27522	GN 668-20-130-A-SW	20	130±0.25	120	M5	10	45	15	10	85
GN.27531	GN 668-20-170-A-BL	20	170±0.25	160	M5	10	45	15	10	105
GN.27532	GN 668-20-170-A-SW	20	170±0.25	160	M5	10	45	15	10	105
GN.27536	GN 668-20-190-A-BL	20	190±0.25	180	M5	10	45	15	10	115
GN.27537	GN 668-20-190-A-SW	20	190±0.25	180	M5	10	45	15	10	115
GN.27541	GN 668-20-210-A-BL	20	210±0.25	200	M5	10	45	15	10	125
GN.27542	GN 668-20-210-A-SW	20	210±0.25	200	M5	10	45	15	10	125
GN.27551	GN 668-30-262-A-BL	30	262±0.25	250	M6	12	50	15	12	277
GN.27552	GN 668-30-262-A-SW	30	262±0.25	250	M6	12	50	15	12	277
GN.27556	GN 668-30-312-A-BL	30	312±0.25	300	M6	12	50	15	12	321
GN.27557	GN 668-30-312-A-SW	30	312±0.25	300	M6	12	50	15	12	321
GN.27561	GN 668-30-362-A-BL	30	362±0.25	350	M6	12	50	15	12	267
GN.27562	GN 668-30-362-A-SW	30	362±0.25	350	M6	12	50	15	12	267
GN.27566	GN 668-30-412-A-BL	30	412±0.25	400	M6	12	50	15	12	410
GN.27567	GN 668-30-412-A-SW	30	412±0.25	400	M6	12	50	15	12	410