

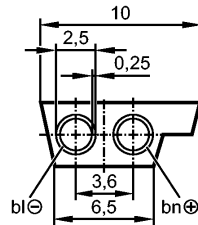

Flat cable 200 m EPDM ye 2.5 qmm

Bus system AS-Interface



Product characteristics

AS-i flat cable

for use in insulation displacement connector technology for FC lower parts and compact modules

Reverse polarity protection due to special shape

supplied on a wooden reel

Core cross-section 2.5 mm²

Electrical data

Electrical design

AS-i

Operating voltage [V]

26.5...31.6 DC (AS-i)

Environment

Ambient temperature [°C]

-40...85

Protection

IP 67

Mechanical data

Weight [kg]

18.8

Electrical connection

Connection

/ 200 m; 2 x 2.5 mm²

Material

EPDM; halogen-free

Sheath colour

yellow

Remarks

Remarks

200 m supplied on a wooden reel

Pack quantity [piece]

1