



Figure similar

AS-INTERFACE SLIMLINE MOD. IP20 S22.5, DIGITAL, 2I/2OR(RELAY), 2 X 1 INPUT, 2-WIRE, PNP 2 X 1 OUTPUT, RELAY, 6A,UC 230V CAGE-CLAMP, MODULE WIDTH 22.5 MM

General technical data:

Design of the product		SlimLine S22.5 - I/O modules for operation in the control cabinet, IP20
Design of the slave type		standard slave
Type		2 inputs / 2 outputs
I/O configuration		3
ID/ID2 code		0/F
Protocol is supported AS-interface protocol		Yes
AS interface total current input max	mA	50
operating voltage according to AS-Interface specification	V	26.5 ... 31.6
Addressing		front addressing socket
Type of electrical connection of the inputs and outputs		spring-loaded terminals
Equipment marking acc. to DIN 40719 extended according to IEC 204-2 acc. to IEC 750		A
Equipment marking acc. to DIN EN 61346-2		K
Note 1		detachment tool for spring-loaded terminal connection: See Accessories

Sensor supply:

Type of voltage supply for power supply		using AS-Interface
Input voltage	V	20 ... 30
Property of the sensor supply Short-circuit and overload resistant		Yes

Inputs:

Number of digital inputs		2
Type of connection		2-wire technology
Input circuit		PNP transistor
Type of voltage of the input voltages		DC
Inputs switching level High min	V	10
Input current at digital input		
• for signal <1> minimum	mA	5
• with signal <0> maximum	mA	1.5
Inputs sensor supply using AS-Interface		short-circuit and overload resistant

Outputs:

Number of digital outputs		2
Output voltage for DC at 24 V	V	22 ... 24
Outputs		
• current carrying capacity I _{th}	A	6
Ampacity		
• of the output relay		
— at DC-13		
— at 24 V	A	1
— at 110 V	A	0.2
— at 230 V	A	0.1
— at AC-15 at 230 V at 50/60 Hz	A	3
Type of switching output		relay, changeover floating
Property of the output Short-circuit proof		No
output Polarity reversal protection		does not apply
Outputs		
• short-circuit protection		external back-up fuse required
• induction protection		does not apply
• watchdog		built-in
Status display		
• display of I/Os		yellow LED
• AS-Interface		green LED
• FAULT		red LED
Assignment of data bits		
• D0		IN1
• D1		IN2
• D2		OUT1
• D3		OUT2

Ambient conditions:

Ambient temperature		
• during operation	°C	-25 ... +70
• during storage	°C	-40 ... +85

Protection class IP		IP20
---------------------	--	------

Mechanical data:

Width	mm	22.5
Height	mm	103
Depth	mm	86
Mounting type		35 mm standard rail mounting or wall mounting using push-in lugs
Conductor cross-section		
<ul style="list-style-type: none"> • solid • finely stranded <ul style="list-style-type: none"> — with end sleeve — without end sleeve • AWG solid or stranded 		2 x (0.25 - 1.5) mm ² 2 x (0.25 - 1) mm ² 2 x (0.25 - 1.5) mm ² AWG 2 x (24 - 16) mm ²

Certificates/ approvals:

AS-Interface certificate		yes (or requested for in case of new units)
Approvals		UL, CSA, shipbuilding (or requested for in case of new units)

General Product Approval



Shipping Approval

Shipping Approval



[Declaration of Conformity](#)

[Environmental Confirmations](#)

other

[Confirmation](#)

[other](#)

Further information

Information- and Downloadcenter (Catalogs, Brochures,...)

<http://www.siemens.com/industrial-controls/catalogs>

Industry Mall (Online ordering system)

<http://www.siemens.com/industrymall>

Cax online generator

<http://support.automation.siemens.com/WW/CAXorder/default.aspx?lang=en&mlfb=3RK14020BG000AA2>

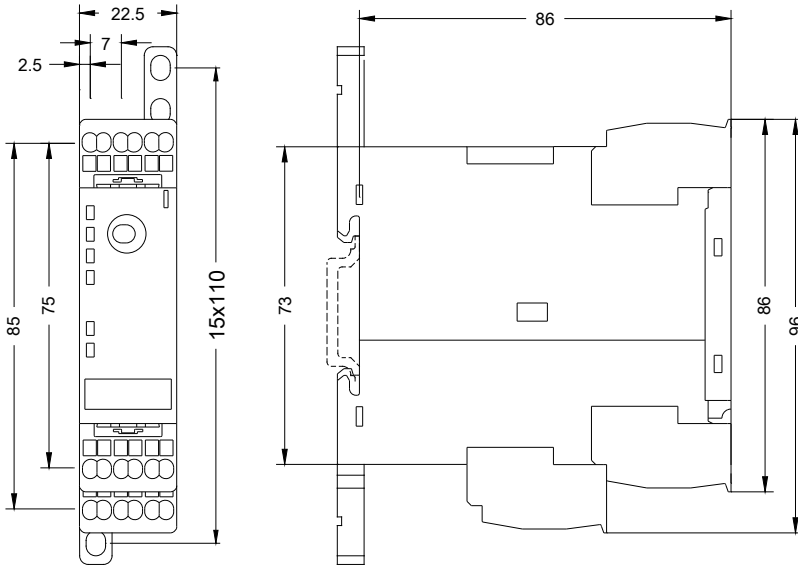

last modified:

09.03.2015