

Flush Profile

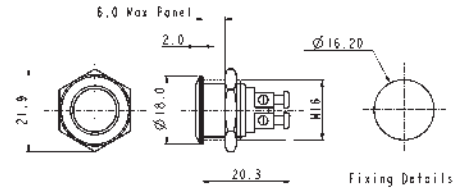

MP0042/1

- 18mm bezel diameter
- 16mm panel hole
- S.P. Push to make
- Polished finish
- 2A, 36Vdc



Domed Profile



MP0042/2

- 18mm bezel diameter
- 16mm panel hole
- S.P. Push to make
- Polished finish
- 2A, 36Vdc

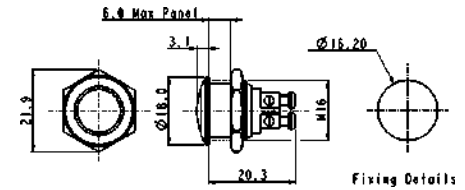

Prominent Button



MP0042/3

- 18mm bezel diameter
- 16mm panel hole
- S.P. Push to make
- Polished finish
- 2A, 36Vdc

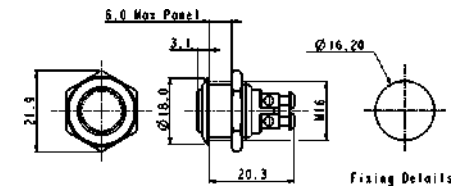

| Specifications          | MP0042/1                            | MP0042/2                            | MP0042/3                            |
|-------------------------|-------------------------------------|-------------------------------------|-------------------------------------|
| Terminations:           | Screw Terminals                     | Screw Terminals                     | Screw Terminals                     |
| Switching:              | S.P. Push to make                   | S.P. Push to make                   | S.P. Push to make                   |
| Max. Rating:            | 2A, 36Vdc                           | 2A, 36Vdc                           | 2A, 36Vdc                           |
| Contact Resistance:     | 50mΩ at 1A, 2V                      | 50mΩ at 1A, 2V                      | 50mΩ at 1A, 2V                      |
| Insulation Resistance:  | >10 <sup>3</sup> MΩ @ 500Vdc        | >10 <sup>3</sup> MΩ @ 500Vdc        | >10 <sup>3</sup> MΩ @ 500Vdc        |
| Dielectric Strength:    | >2.0kVac                            | >2.0kVac                            | >2.0kVac                            |
| Operating Temp. Range:  | -20°C to +55°C                      | -20°C to +55°C                      | -20°C to +55°C                      |
| Operations              |                                     |                                     |                                     |
| Mechanical:             | 1,000,000 (min)                     | 1,000,000 (min)                     | 1,000,000 (min)                     |
| Electrical:             | 100,000 (min)                       | 100,000 (min)                       | 100,000 (min)                       |
| Rear Nut Fixing Torque: | 12Nm                                | 12Nm                                | 12Nm                                |
| Materials               |                                     |                                     |                                     |
| Mouldings:              | Nylon                               | Nylon                               | Nylon                               |
| Tags/Terminations:      | Brass, Silver Plated                | Brass, Silver Plated                | Brass, Silver Plated                |
| Switch Body & Button:   | Stainless Steel (Polished)          | Stainless Steel (Polished)          | Stainless Steel (Polished)          |
| Contacts:               | Silver                              | Silver                              | Silver                              |
| Thread size:            | Gold Plated Brass version available | Gold Plated Brass version available | Gold Plated Brass version available |
| Sealing:                | IP65                                | IP65                                | IP65                                |
| Impact Rating:          | IK08                                | IK08                                | IK08                                |
| RoHS                    | Compliant                           | Compliant                           | Compliant                           |