

MATERIAL

Hardened steel.

STANDARD EXECUTIONS

Assembly by means of two supplied zinc-plated steel grub screws with hexagon socket.

- **GN 297-R:** gear with toothing for clockwise rotation.
- **GN 297-L:** gear with toothing for anti-clockwise rotation.
- **GN 297-W:** set of two gears, one for clockwise rotation and the other for anti-clockwise rotation. Ratio 1:1.
- **GN 297-T:** set of three gears, one for clockwise rotation and the other two for anti-clockwise rotation. Ratio 1:1.

FEATURES AND APPLICATIONS

GN 297 angular gears are normally used with the linear actuators, connecting units GN 391 (see page 1813) and/or GN connecting clamps GN 298 (see page 1812).

The helical toothing ensures better coupling between the conical gears, reducing the clearance and consequently the noise level. Two conical gears are needed to make an angular rotation (GN 297-W). Three conical gears are needed to make a T rotation (GN 297-T).

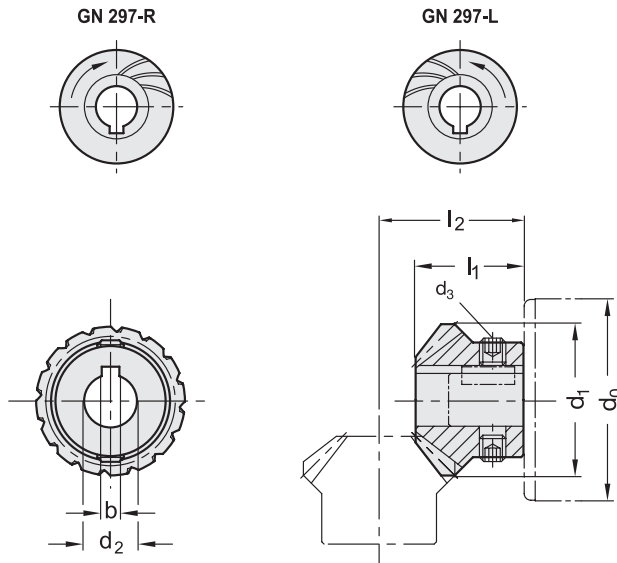

Code	Description	d0*	d1	d2 H7 Bore with keyway	d3	b	l	l2	△
GN.67403	GN 297-14.5-K6-R	18	14.5	6	M4	2	11	16	9
GN.67402	GN 297-14.5-K6-L	18	14.5	6	M4	2	11	16	9
GN.67405	GN 297-14.5-K6-W	18	14.5	6	M4	2	11	16	18
GN.67404	GN 297-14.5-K6-T	18	14.5	6	M4	2	11	16	27
GN.67408	GN 297-25-K8-R	30	25	8	M6	2	19	25	36
GN.67407	GN 297-25-K8-L	30	25	8	M6	2	19	25	36
GN.67410	GN 297-25-K8-W	30	25	8	M6	2	19	25	72
GN.67409	GN 297-25-K8-T	30	25	8	M6	2	19	25	108
GN.67413	GN 297-33-K12-R	40/50	33	12	M6	4	23.5	31	59
GN.67412	GN 297-33-K12-L	40/50	33	12	M6	4	23.5	31	59
GN.67415	GN 297-33-K12-W	40/50	33	12	M6	4	23.5	31	118
GN.67414	GN 297-33-K12-T	40/50	33	12	M6	4	23.5	31	177

* d0 = external Ø of the linear actuator or GN 391

