

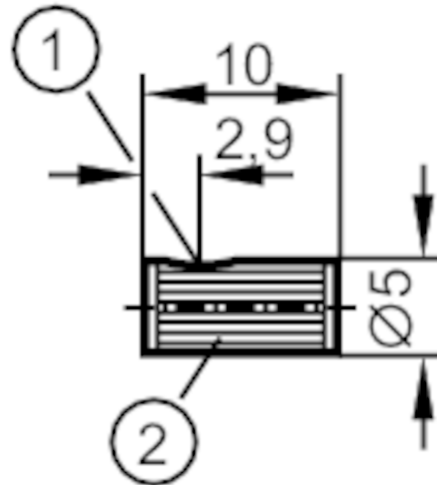

Lens attachment for fibre optics

LENS ATTACHMENT D5X10-M3



- 1 light emission
- 2 internal thread M3

Application

Design for through-beam fibre optics M3

Operating conditions

Ambient temperature [°C] -40...70

Mechanical data

Weight [g] 3.5

Materials aluminium black anodised

Remarks

Pack quantity 2 pcs.